

- | | |
|--|---|
| <p>Site Hazards:</p> <p>Working at base of wall/raising objects -
No work to be carried out at base of wall whilst plant working on the top.</p> | <p>Working within catwalkway -
Leave Closure in accordance with Chapter 8, Single night time closure throughout first two lifts. (NHSS 12 qualified)</p> |
| <p>Fall from Height - max 4.5m drop -
Temporary Barrier System and working Platform to be erected.</p> | <p>Working within catwalkway -
Leave Closure in accordance with Chapter 8, Single night time closure throughout first two lifts. (NHSS 12 qualified)</p> |
| <p>Wall Stability -
No loadings within 45° of first two lifts between Ch. 10-13, 75° excavation to be carried out.</p> | <p>Working within catwalkway -
Leave Closure in accordance with Chapter 8, Single night time closure throughout first two lifts. (NHSS 12 qualified)</p> |
| <p>Lift traffic -
Safety barrier to be used when working within the verge.</p> | <p>Working within catwalkway -
Leave Closure in accordance with Chapter 8, Single night time closure throughout first two lifts. (NHSS 12 qualified)</p> |
| <p>Network Rail Interface -
Entry onto NR land will require TYP and associated NR authority.</p> | <p>Working within catwalkway -
Leave Closure in accordance with Chapter 8, Single night time closure throughout first two lifts. (NHSS 12 qualified)</p> |
| <p>Services above catwalkway -
Overhead BT & WPD services to be sheathed and protected throughout works. Caution to be taken when lifting in precast parapet.</p> | <p>Working within catwalkway -
Leave Closure in accordance with Chapter 8, Single night time closure throughout first two lifts. (NHSS 12 qualified)</p> |
| <p>Health and Safety.</p> | <p>Working within catwalkway -
Leave Closure in accordance with Chapter 8, Single night time closure throughout first two lifts. (NHSS 12 qualified)</p> |
| <p>First Aid - Named first aid operative to be on site at all times. Nearest A&E: Royal Cornwall Hospital, Truro, Cornwall, TR1 3LJ. 01872 253111.</p> | <p>Working within catwalkway -
Leave Closure in accordance with Chapter 8, Single night time closure throughout first two lifts. (NHSS 12 qualified)</p> |
| <p>Environment Hazards.</p> | <p>Working within catwalkway -
Leave Closure in accordance with Chapter 8, Single night time closure throughout first two lifts. (NHSS 12 qualified)</p> |
| <p>As a precautionary measure, all works should proceed with care and vigilance at all times. If at any point a bat is encountered a Natural England Licensed bat ecologist must be contacted for further advice.</p> | <p>Working within catwalkway -
Leave Closure in accordance with Chapter 8, Single night time closure throughout first two lifts. (NHSS 12 qualified)</p> |

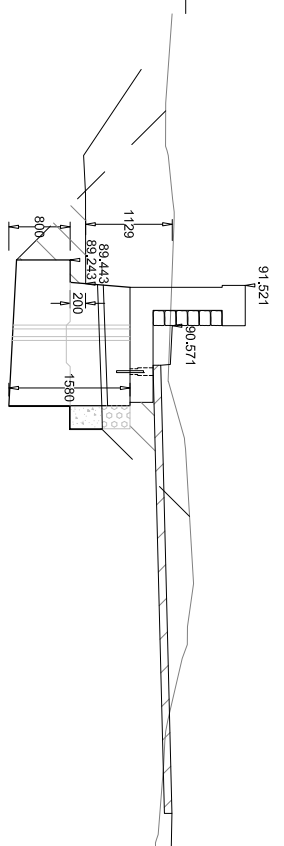
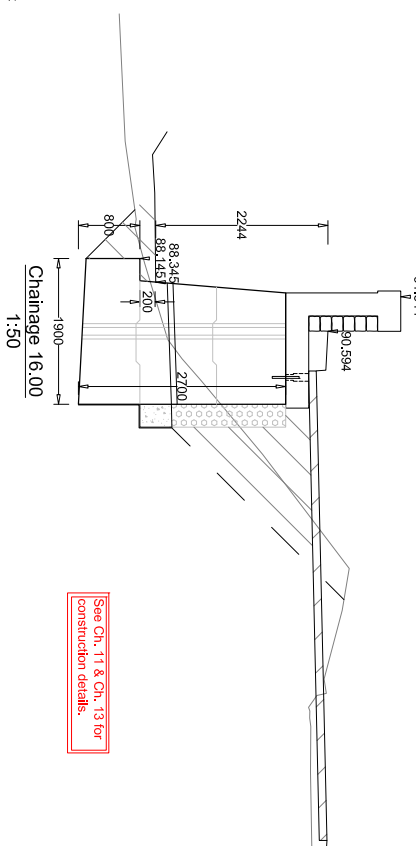
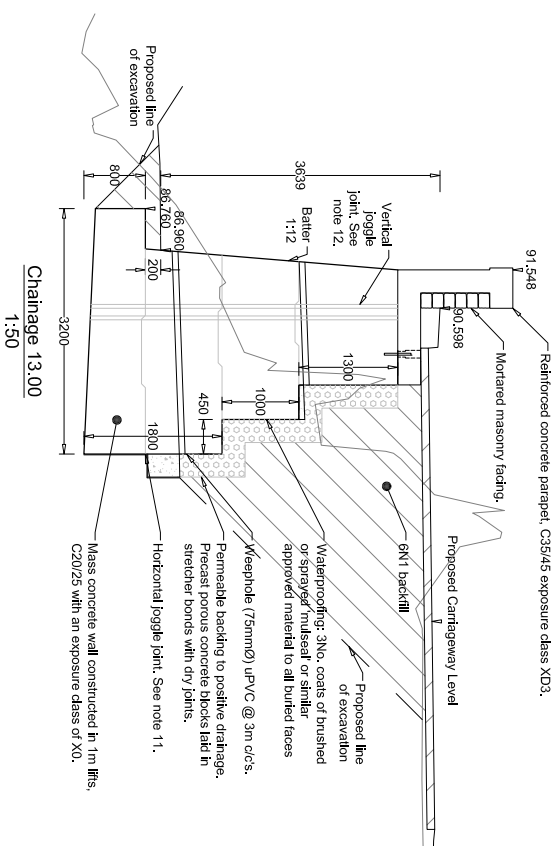
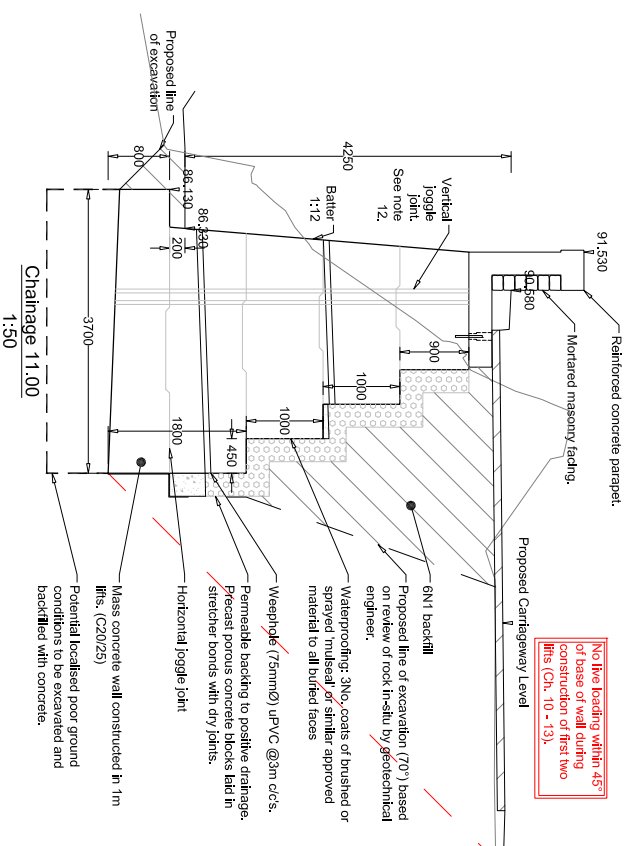
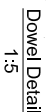
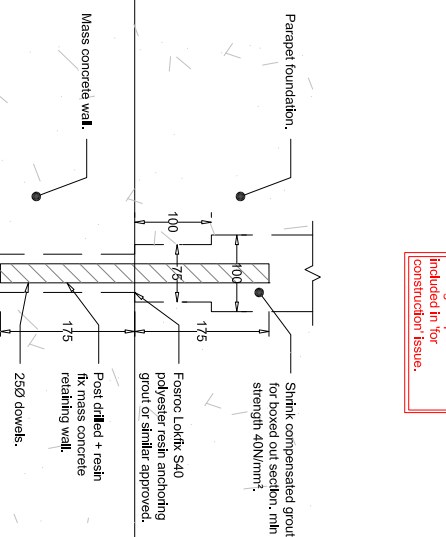
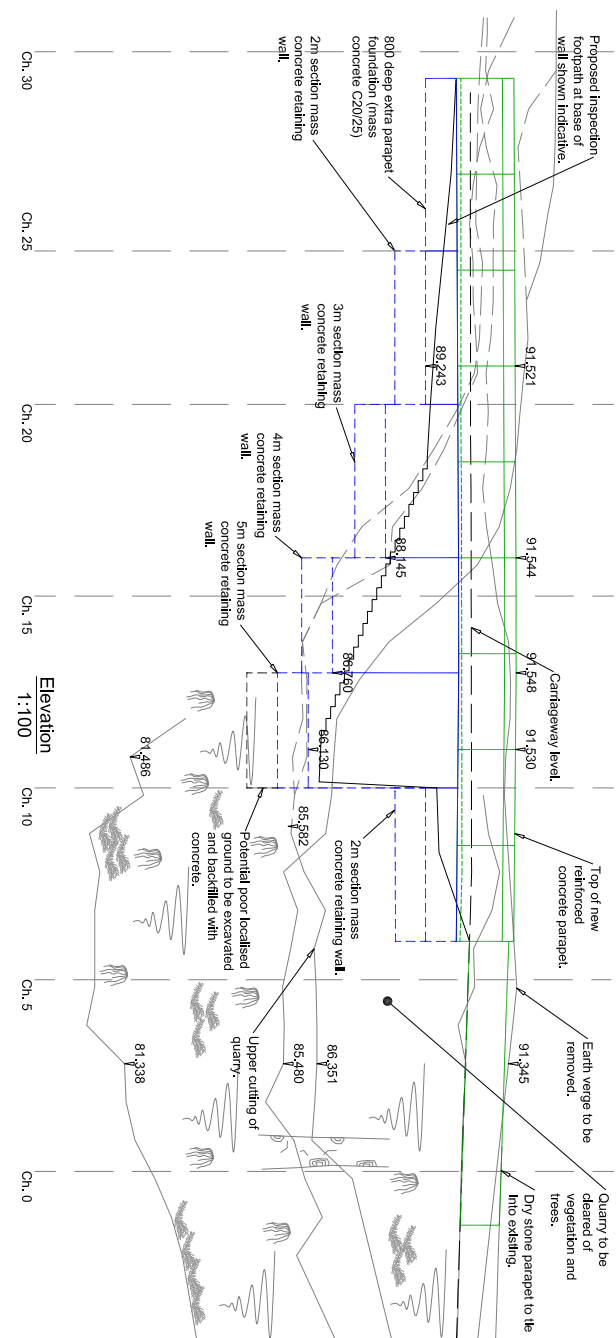
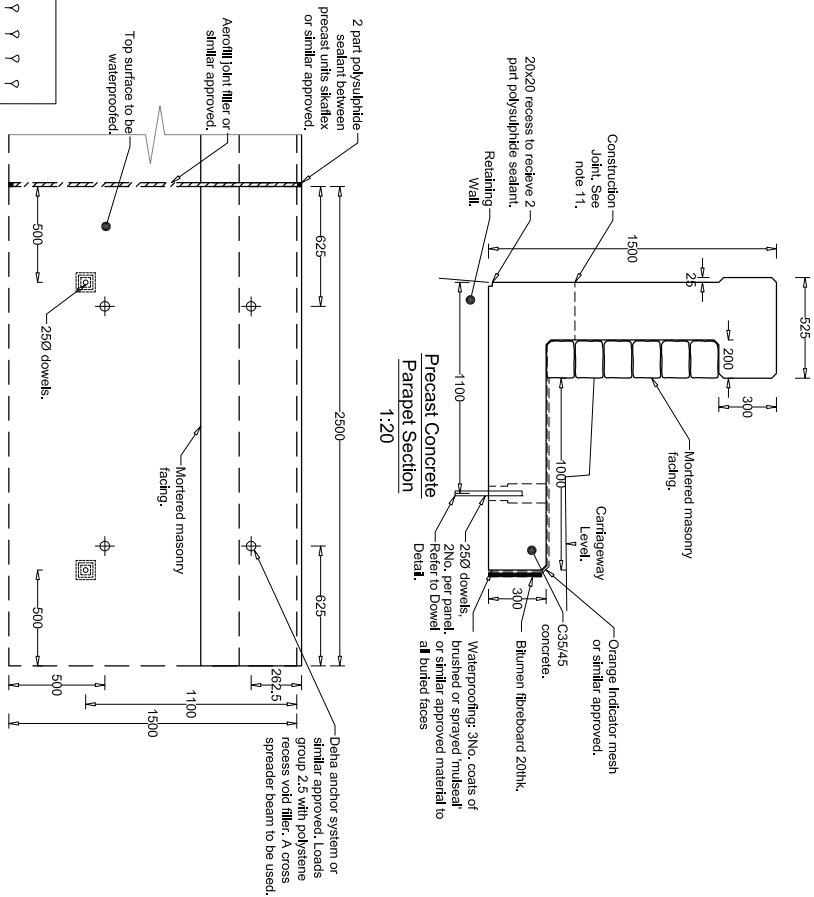

FOR PRICING

© This drawing is Copyright. It should not be relied on or used in circumstances other than those for which it was originally prepared and for which Cornwall Council was originally commissioned. Cornwall Council accepts no responsibility for this drawing to any party other than the person(s) by whom it was commissioned.

1. All dimensions are shown in millimetres and are to be checked prior to construction.
2. All levels are in metres to a local survey datum and should be confirmed prior to commencement of works.
3. Do not scale off drawing.
4. Challenge is based on end of mortared masonry bridge parapet.
5. All statutory undertake information is taken from EC returns. Exact footings and depths are unknown and further investigations are required.
6. For details of the Standard Eurocode designed Mass Concrete gravity retaining wall see drawing no. EC-Design No. Rev D.
7. Drawing supersedes 62/103179-703 Rev. C
8. Concrete finishes
 - U2 - buried horizontal concrete surfaces,
 - F1 - buried surfaces to be waterproofed
 - F2 - to exposed faces
9. Reinforced Cantilever Parapet
 - U3 - top of parapet
 - F1 - Front face of parapet to masonry face
 - F2 - to sides and ends of base unit and exposed stem face.
9. Refer to Proposed Reinforcement Details: 700203989-1704
10. Refer to numbered Appendices for Specification details: 36310000P-H-LV R001
11. Horizontal joggle joints should be 50mm deep and approximately one third of the base dimension wide, of half fit.
12. Vertical joggle joints should be provided at each construction joint, and given three coats of brushed or sprayed 'Whiteal' or similar approved material.

0	24/08/16	For Pricing
REV	DATE	NATURE OF REVISION
		REVISIONS

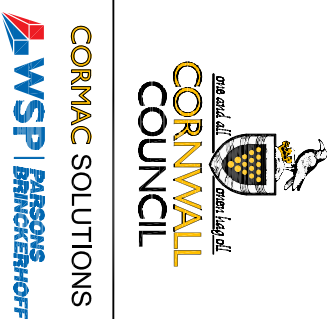

PROJECT:
Treluswell Retaining Wall

DRAWING TITLE:
Proposed General Arrangement

SCALE:			
As Shown @ A1			
PROJECT MANAGER: PQ		DRAWN BY: CMV	
CHECKED-TW	24/08/2016	APPROVED- PQ	24/08/2016
DRAWING NO:		REVISION	
700209998-1703		0	