



View of area of grass proposed for contractor's compound from north



Entrance to informal path to cemeteries from Sainsbury's access road



Informal path looking north towards cemeteries



View of area within fence for conservator's compound

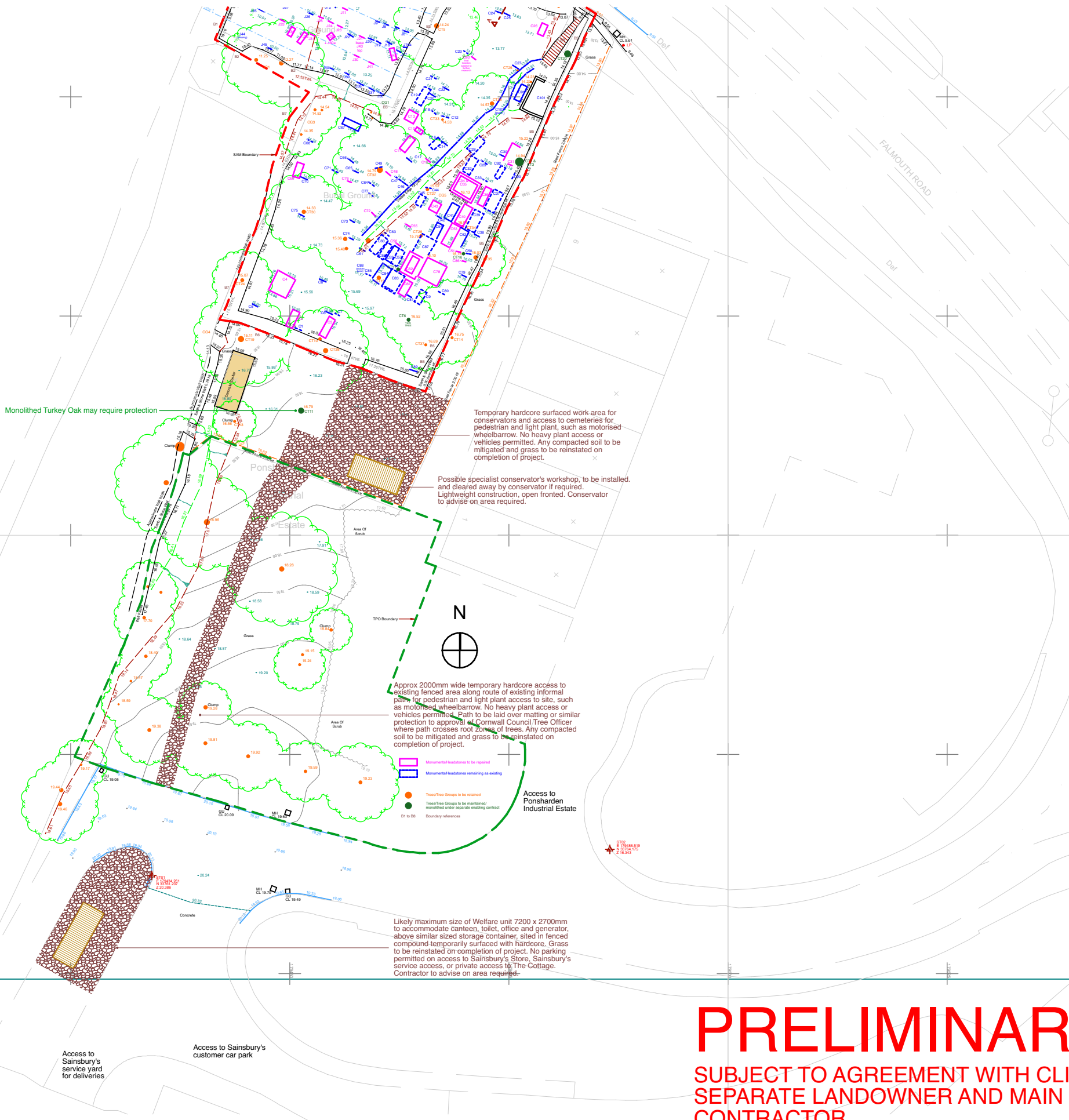

**PRELIMINARY**  
 SUBJECT TO AGREEMENT WITH CLIENT,  
 SEPARATE LANDOWNER AND MAIN  
 CONTRACTOR

Proposed Contractor's Compound (Grassed Area) and Site Access

1:500

**pdpGreen Consulting Ltd.**  
 Calenick House  
 Truro Technology Park  
 Heron Way, Newham  
 Truro, Cornwall  
 TR1 2XN  
 Tel: 01872 265400; Fax: 01872 276356  
 Email: reception@pdpgreen.co.uk

**Drawing Title**  
 Contractor's Compound and  
 Site Access Proposal B

Scale: As stated @ A3  
 Date: 18.01.21  
 Drawn: RG  
**J20-077**  
**5001C**

**Client**  
 Falmouth Town Council

**Job Title**  
 Heritage Restoration of  
 Falmouth's Ponsharden  
 Cemeteries

**TENDER**

**Revisions:**  
 A. 18.01.21 First Issue  
 B. 19.01.21 Issue to CC for TPO  
 C. 05.02.2021 Issue For Tender  
 D. 15.02.2021 Monuments updated, Issue For Tender

By: RG  
 RG  
 RG  
 RG

Assistant: KJ  
 Designer: RG  
 Project Leader: RG

**UKAS**  
 MANAGEMENT  
 SYSTEMS  
 003

**bsi.**

**Certificate No FS 21557**

Prefer larger scale drawings. Prefer figured dimensions to scaled dimensions. Check all relevant dimensions, lines and levels on site before proceeding with the work. Take site dimensions for fabrication of joinery and other fittings. Refer all discrepancies to the architect for his/her decision before putting work in hand.

Copyright in this drawing and in the work executed from it remains the property of the architect.