

© This drawing is Copyright. It should not be relied on or used in circumstances other than those for which it was originally commissioned. Wadbridge School accepts no responsibility for this drawing to any party other than the person(s) by whom it was commissioned.  
DO NOT SCALE

NOTES

REV	DATE	NATURE OF REVISION	REVISIONS
0	30-05-2018	ORIGINAL	



**Miss Tina Yardley B.A. Hons.**  
HEADTEACHER  
Gonvena Hill, Wadbridge,  
Cornwall PL27 6BG

**LOCATION**  
Wadbridge School  
**Block 1**  
**PROJECT**  
Junior Kitchen and Dining Room Refurbishment.  
**DRAWING TITLE**  
Floor, Catering Equipment and Service Plan as Existing

**PROJECT MANAGER**  
P. Luke Wicks MICEB, Dip. Surv.

**ORIGINATOR**  
PL

**SCALE**  
1:50

**DRAWING NO**  
PCGC 4153/18/302

**REVISION**  
0

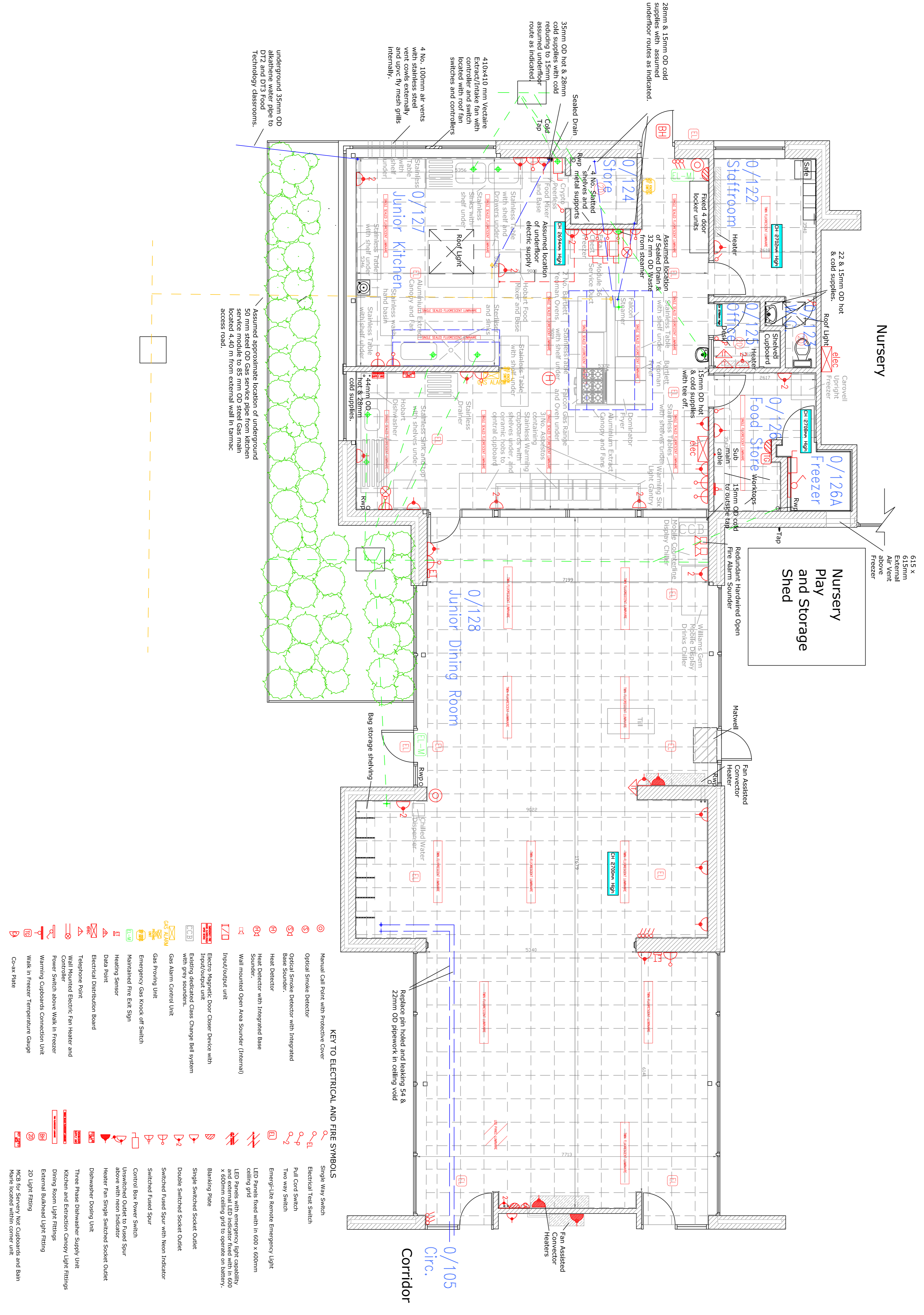

**KEY TO ELECTRICAL AND FIRE SYMBOLS**

- |  |                                                                |  |                                                                                                                                    |
|--|----------------------------------------------------------------|--|------------------------------------------------------------------------------------------------------------------------------------|
|  | Manual Call Point with Protective Cover                        |  | Single Way Switch                                                                                                                  |
|  | Optical Smoke Detector                                         |  | Electrical Test Switch                                                                                                             |
|  | Optical Smoke Detector with Integrated Base Sounder            |  | Pull Cord Switch                                                                                                                   |
|  | Heat Detector                                                  |  | Two Way Switch                                                                                                                     |
|  | Heat Detector with Integrated Base Sounder                     |  | Energy-Lite Remote Emergency Light                                                                                                 |
|  | Wall mounted Open Area Sounder (Internal)                      |  | LED Panels fixed with in 600 x 600mm ceiling grid                                                                                  |
|  | Input/output unit                                              |  | LED Panels with emergency light capability and external LED indicator fixed with in 600 x 600mm ceiling grid to operate on battery |
|  | Electro Magnetic Door Closer Device with Input/output unit     |  | Banning Plate                                                                                                                      |
|  | Existing dedicated Class Change Bell system with grey sounders |  | Single Switched Socket Outlet                                                                                                      |
|  | Gas Alarm Control Unit                                         |  | Double Switched Socket Outlet                                                                                                      |
|  | Gas Frying Unit                                                |  | Switched Fused Spur with Neon Indicator                                                                                            |
|  | Emergency Gas Knock off Switch                                 |  | Single Switched Socket Outlet                                                                                                      |
|  | Maintained Fire Exit Sign                                      |  | Control Box Power Switch                                                                                                           |
|  | Heating Sensor                                                 |  | Unswitched Outlet to Fused Spur above with neon indicator                                                                          |
|  | Data Point                                                     |  | Heater Fan Single Switched Socket Outlet                                                                                           |
|  | Electrical Distribution Board                                  |  | Dishwasher Dosing Unit                                                                                                             |
|  | Telephone Point                                                |  | Three Phase Dishwasher Supply Unit                                                                                                 |
|  | Wall Mounted Electric Fan Heater and Controller                |  | Kitchen and Extraction Canopy Light Fittings                                                                                       |
|  | Power Switch above Walk in Freezer                             |  | External Bulkhead Light Fitting                                                                                                    |
|  | Warning Cupboards Connection Unit                              |  | 2D Light Fitting                                                                                                                   |
|  | Walk in Freezer Temperature Gauge                              |  | MCB for Servery Not Cupboards and Bain                                                                                             |
|  | Co-ax Plate                                                    |  | Marked located within corner unit                                                                                                  |

Replace pin hole and leaving SA & 22mm OD pipework in ceiling void