

# Hog Cliff NNR Glebe Farm water supply pipe trenching and troughs specification

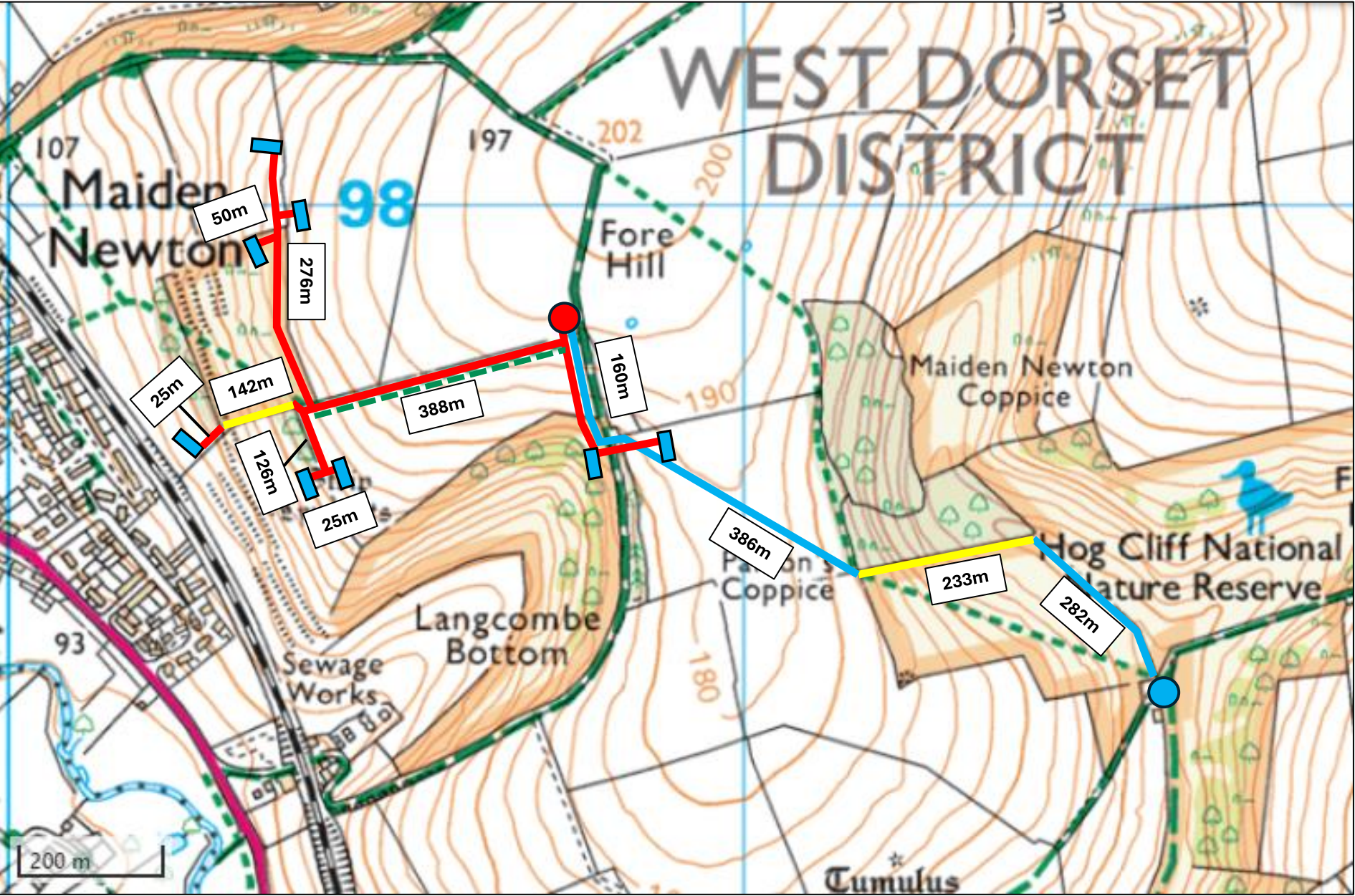



- 8 x water trough.  
Concrete or galvanised steel  
100 gallons.
- 1 x header tank.  
5,000 litres.
- Existing borehole
- Above ground pipe.  
Approx. total 375m.
- Buried/trenched pipe  
supply to header tank.  
Approx. total 668m.
- Buried/trenched pipe  
supply from header  
tank to troughs.  
Approx. total 900m.

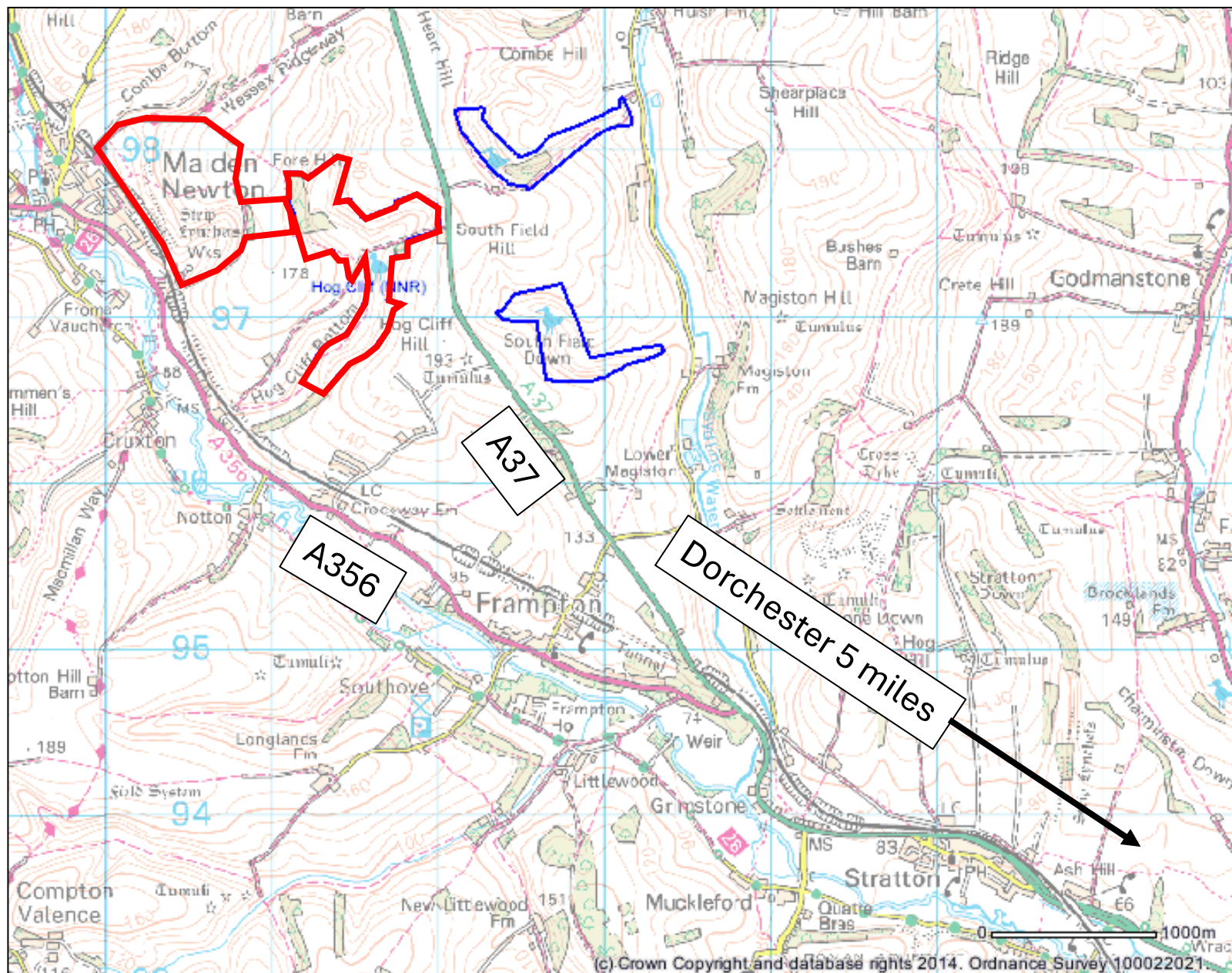

# Hog Cliff NNR Glebe Farm water supply – location of works



-  Glebe Farm & Hog Cliff Bottom (location of works)
-  Hog Cliff NNR

Dorchester 5 miles

# Hog Cliff NNR Glebe Farm water supply works – access to worksite

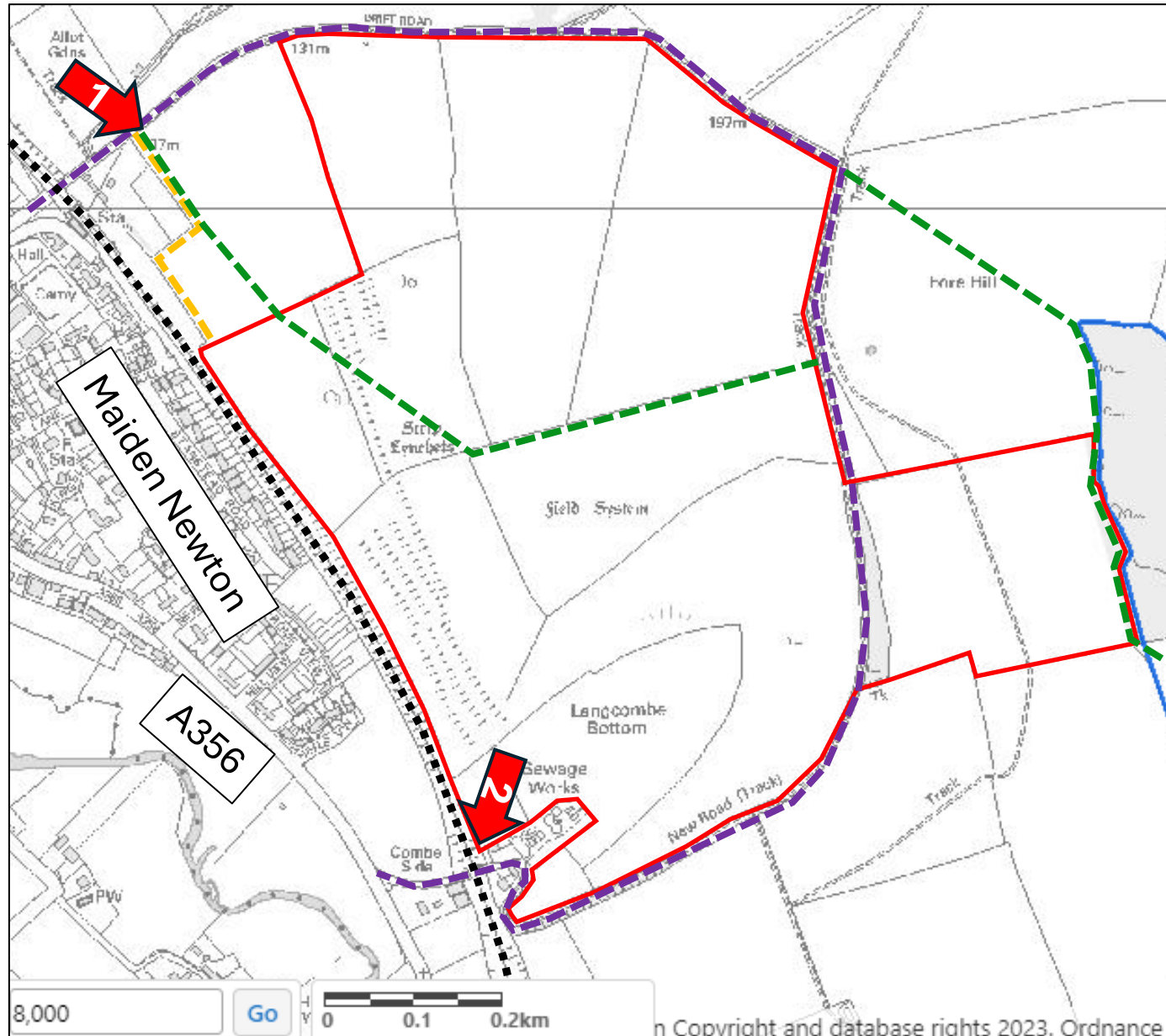

- 1** **Allotment access**  
What3Words  
firmer.receive.listen
- 2** **Sewage works access**  
What3Words  
squirts.reflect.goodbyes
- Glebe Farm
- Hog Cliff NNR
- Footpath
- Bridleway
- NE right of access
- Trainline



# Hog Cliff NNR Glebe Farm water supply works – access to worksite

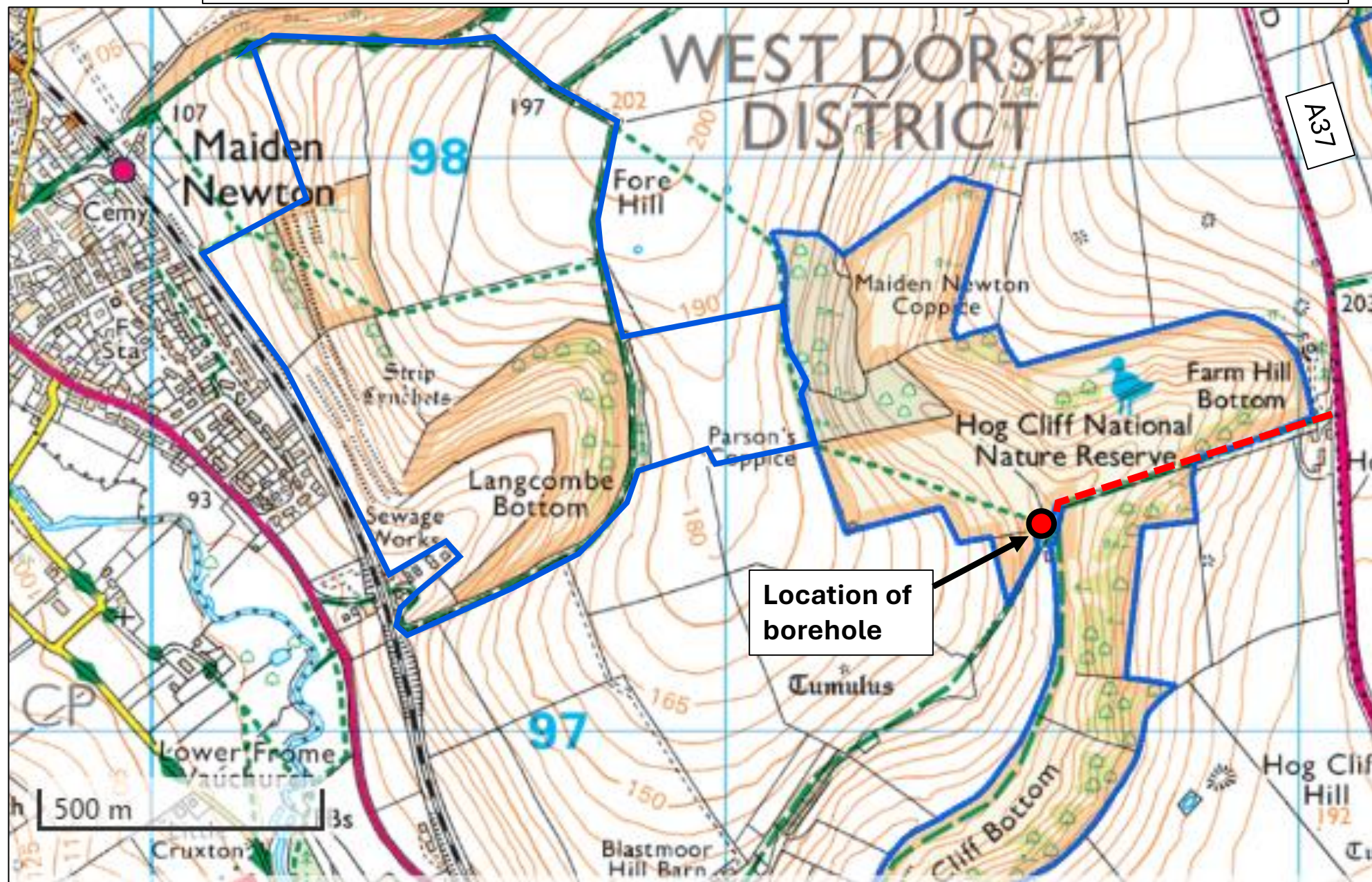

Access to  
borehole  
from A37  
(4x4 vehicle)

Location of  
borehole