

- TARMAC SURFACE COURSE 30MM TO MANUFACTURERS SPECIFICATION
- 70MM BINDER COURSE TO MANUFACTURERS RECOMMENDED SPECIFICATION
- 225MM EXISTING COMPACTED SUB BASE LAYER (IF APPLICABLE FOLLOWING TRIAL AREA)
- 150MM X 50MM CONCRETE EDGING WITH 100MM CONCRETE FOUNDATION

TARMAC DETAILING WITH CONCRETE EDGING 1:10 @ A3

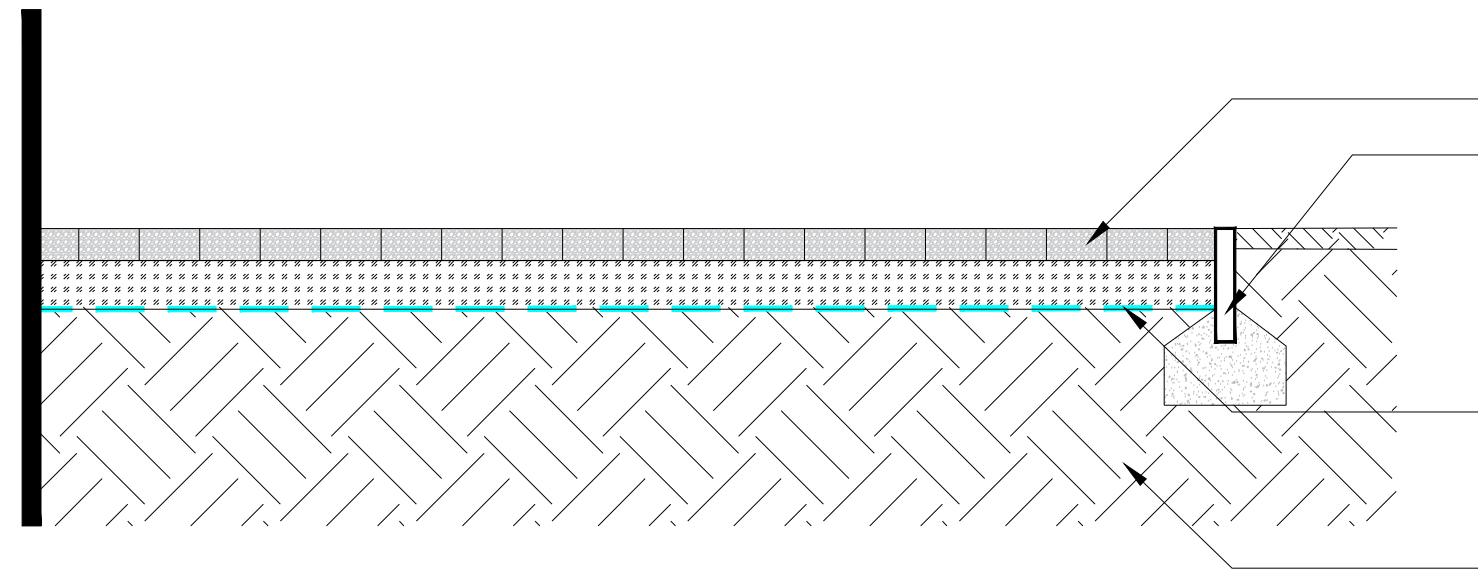

- BODPAVE 85 GEO-CELL SYSTEM 40MM WITH GRAVEL INFILL 20MM
- TREATED SOFTWOOD TIMBER EDGING 150 x 22mm WITH 100MM CONCRETE FOUNDATION
- GEOTEXTILE MEMBRANE
- COMPACTED SUBSOIL BASE

BODPAVE 85 DETAILING WITH TIMBER EDGING 1:10 @ A3

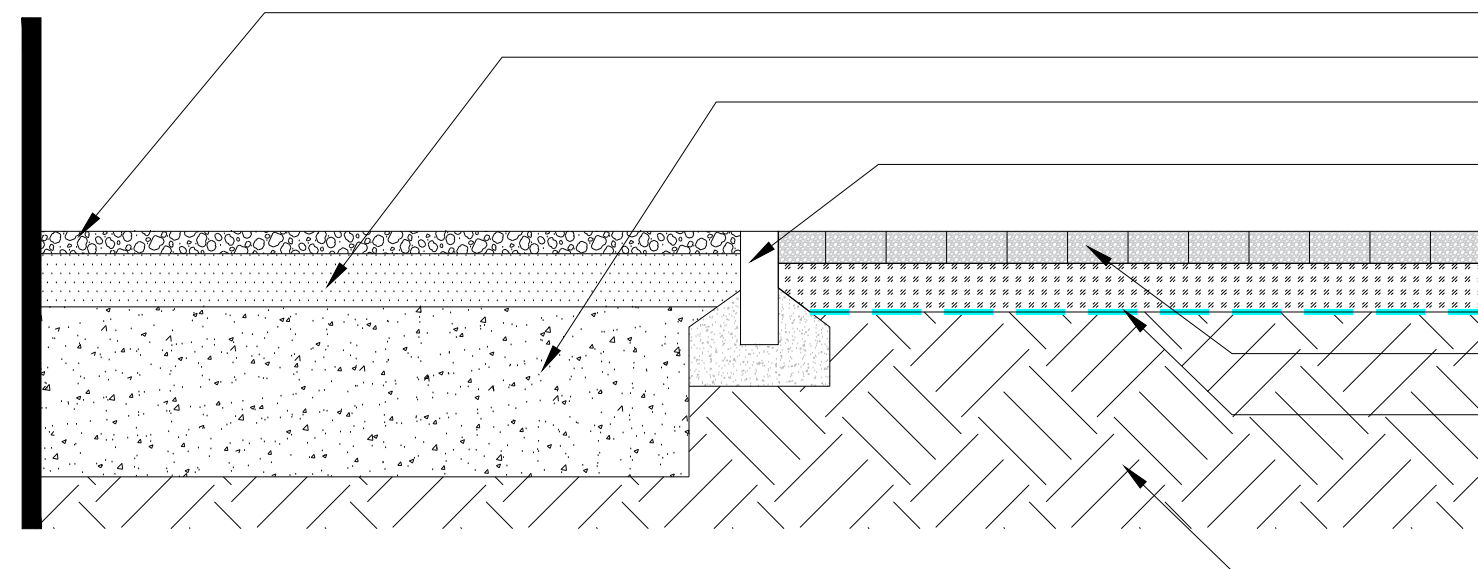

- TARMAC SURFACE COURSE 30MM TO MANUFACTURERS SPECIFICATION
- 70MM BINDER COURSE TO MANUFACTURERS RECOMMENDED SPECIFICATION
- 225MM EXISTING COMPACTED SUB BASE LAYER (IF APPLICABLE FOLLOWING TRIAL AREA)
- 150MM X 50MM CONCRETE EDGING WITH 100MM CONCRETE FOUNDATION

- BODPAVE 85 GEO-CELL SYSTEM 40MM WITH GRAVEL INFILL 20MM
- GEOTEXTILE MEMBRANE
- COMPACTED SUBSOIL BASE

INTERFACE BETWEEN EXISTING HIGHWAY AND BODPAVE WITH CONCRETE EDGING 1:10 @ A3

B	Issue for Tender	18/07/23	NSC	RH	RH
A	Issued for Tender	10/10/21	RG	WP	WP
REVISION DETAILS		DATE	DWN	CHK	APP

© Crown copyright. All rights reserved. Licence number AL100001776.

Bishop's Tachbrook
Social Club External Enhancements

Additional Detail Sheet 1

43261-WOOD-XX-XX-DR-L-00006_S0_P01

FOR TENDER

July 2023

