

Notes :

- 1) All pipework to be thermally insulated in accordance with specification, including pipework within roof void, plant areas, boxings, IPS etc. Final run-outs to outlets (where exposed at low level) to be un-insulated.
- 2) All domestic hot and cold water services to be run in copper pipework.
- 3) Provide drain cocks at low points of systems as necessary.
- 4) Final connections to all outlets to be 15dia. (unless indicated otherwise on drawings) and be fitted with service valves.
- 5) Provide sufficient lockshield regulating valves on domestic water return pipework to facilitate system balancing
- 5) Drawing to be read in conjunction with specification and relevant equipment schedules.
- 6) Fit point of use thermostatic blending valves on all domestic hot water in outlets as denoted by 'BH' noted on drawing. Valves to be mounted as close to outlet as possible, minimising length of blended pipework.
- 7) All cold water services pipework within roof void to be trace heated for frost protection - see spec.

Key :

- DHWS Domestic hot water services
BCWS Boosted cold water services
C Mains cold water outlet
BH Blended Domestic hot water outlet (via point of use TBV)
H Un-Blended Domestic hot water outlet (full temperature)
Isolating / stop valve
Denotes pipework at low level (LL)
Denotes pipework within ceiling void

1 Proposed Domestic Water Services
1:50

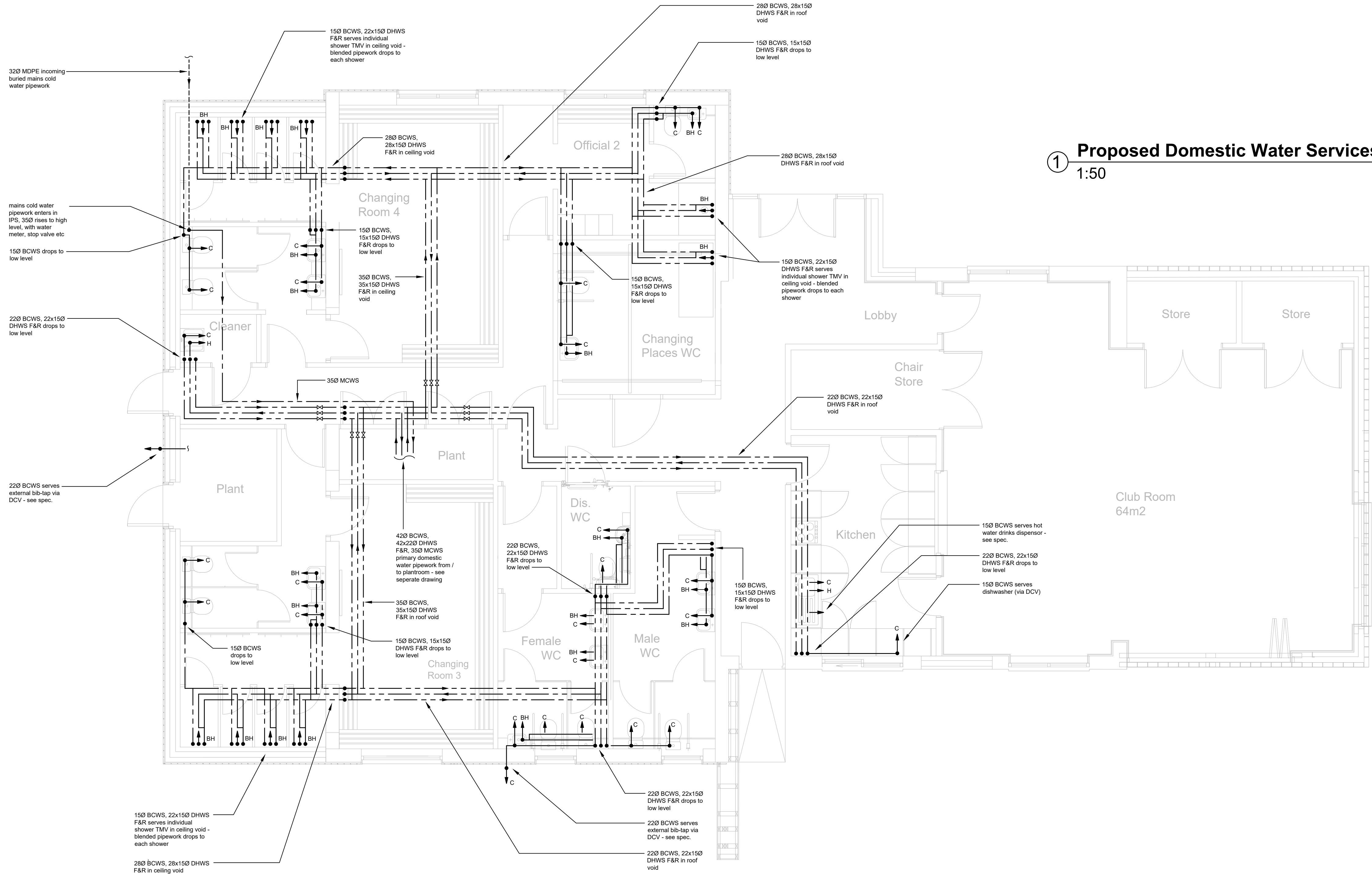

2 Schematic Details
NTS

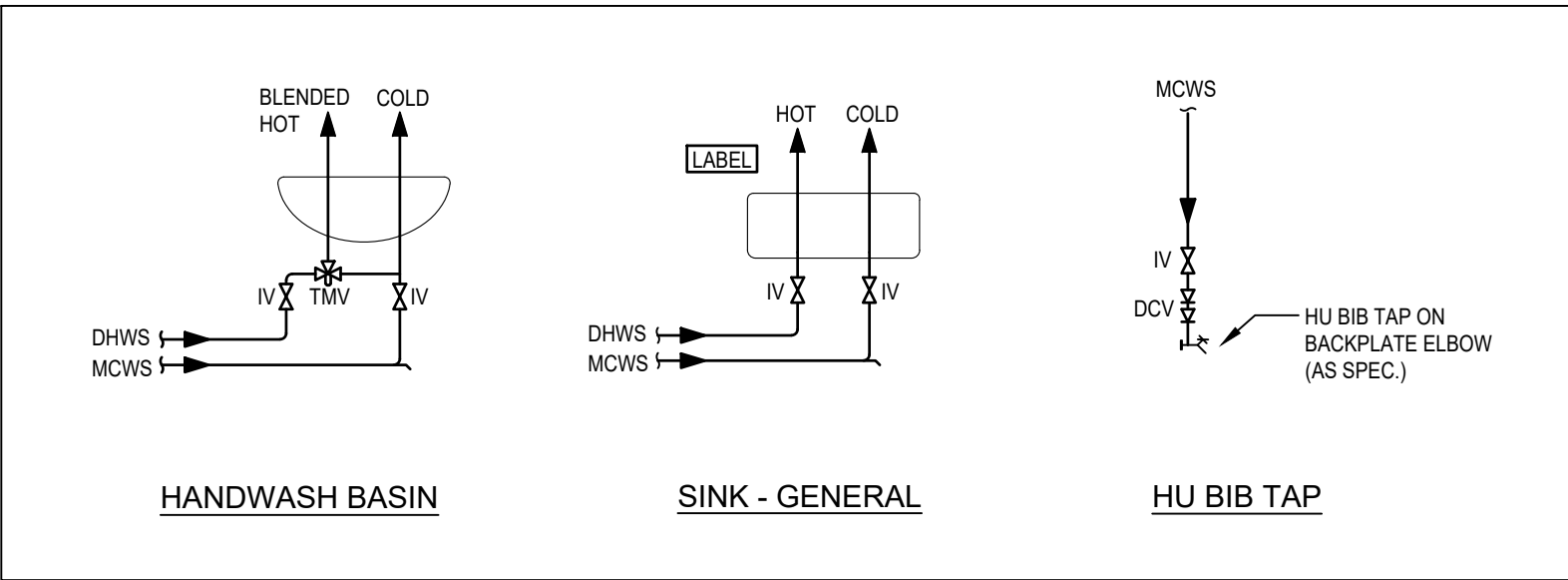
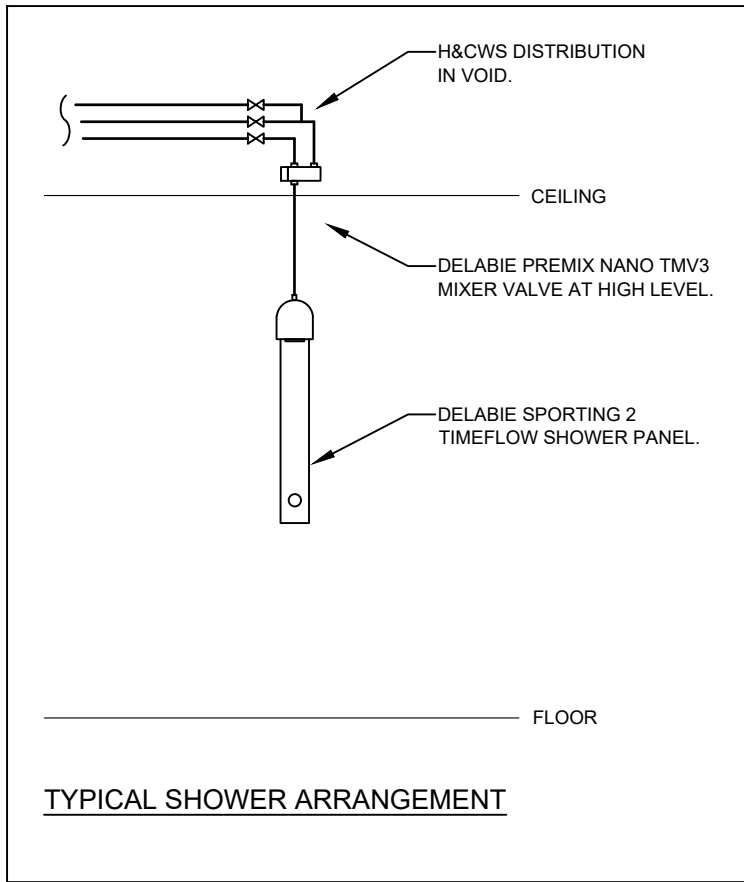

rev.	description	date	drawn	approved
C	Revised Tender Issue - updated to suit latest building layouts	JUL '23	SJA	IRW
B	Tender Issue	JULY '22	SJA	IRW
A	Preliminary Issue	JUN. '22	SJA	IRW

information ☐ approved ☐ tender ☒ contract ☐ construction ☐

Axis Mechanical & Electrical Consulting Engineers

No.8 Poplars Court
Lenton Lane
Nottingham
NG7 2RR
United Kingdom

tel: +44 (0) 115 9791875
fax: +44 (0) 115 9249179
email: mail@axisconsult.co.uk
web: www.axisconsult.co.uk



client

SAWTRY PARISH COUNCIL

project

GREEN FIELD SPORTS FIELD
SAWTRY, HUNTINGDON

drawing

PROPOSED DOMESTIC HOT & COLD
WATER SERVICES

drawn	approved	date	scale
SJA	IRW	JUNE '22	1:50 @ A1
drawing ref.			revision
AX1937-M-002			C