

Proposed Car Park
1 : 100

Crosshatched areas for no parking and to allow disabled accessibility

Existing Car park to be used as a site compound for the duration of the works. This part of the main car park is owned by the Town Council , the remainder of the main car park is managed by Cheshire East District Council

The existing car park surface to the West of the existing gully shown colour shaded (orange) is to be scraped back to sub base (approx 80 to 100mm) Lay new wearing course to form 1in 40 cross fall back to gully with new macadam base and 20mm top coat in Vehicular Tarmacadam max 1 in 40 cross fall

Existing car park dished Drainage Channel to be repositioned as a new Aco drain along the back of the new disabled car parking bays allow for cleaning and repointing joints gully pot connections & gulleys and ensure they are free flowing.

Allow for repainting all existing car parking markings in white
Repainting clear zones and delivery bays as proposed in yellow
Painting new Motorbike parkign zone white cross hatched

Proposed Car Park Layout: Option 3

- There are **23 proposed parking spaces**
- A new pavement is formed across the back of the civic hall to provide safe access.
- Parking spaces 1 to 11 will have the wearing surface removed and then reinstated to fall at 1 in 40 away fomr the new pavement and into the proposed realigned drainage channel.
- between the car parking bays is a 6000mm clear width for vehicules to turn
- All of the parking spaces are set out to the correct size at 2.4 x 4.8m and Disabled/Parent Child spaces all have a cross hatched area 1.2m wide to the side of them and a 1.2m cross hatched zone to the rear of designated spaces
- All line markings, symbols and cross hatching will be repainted so that they are clearly visible.
- 11 of the 23 spaces facing the civic hall extension will be provided for disabled parking, which is an increase of 5 from the previous 6 disability parking spaces. Some of these spaces could be designated as Parent/Child spaces.
- The remaining 12 parking spaces to the East will providing standard parking bays at 4800 x 2400. There is an additional cross hatched area adjacent which be assigned motor bike spaces
- There are two gaps in the low brick wall marked with piers either side, one of these will be crosshatched to provide walking access between the car parks towards M&S Food hall
- The North side of the car park will now provide a clear width delivery access of 3410mm and provide access to the Bin store to allow the bins to be collected.
- The North of the car park the low wall curves around providing a ramped pedestrian access route towards the Library and a pedestrian route between the Civic Hall and Library
- A newly proposed dished gully will run along the edge of the newlay surfaced disabled parking area.
- The newly proposed kerbed access to the entrance of the proposed extension also provides safe public access across the car park to the library. Pedestrians would now have a safe paved route across the rear of the Civic Hall to the Library via this route and the new pavement without needing to walk in the roadway zone.
- There will also be a separte bay to allow for motorcycle parking which is situated to the North of the Car Park.
- To the South of the site next to the pay station will be a bicycle station at 2671mm x 4867mm with root fixed bicycler hoops.
- The pay station sign will be moved to the left to allow direct access to the right of the pay station onto the safe pedestrain footpath to the rear of the Civic Hall which also provides safe access to the Library



Pay and Display Sign and bin to be moved to Left of Machine to provide a Clear walkway to the new safe pavement to back of the Civic Hall

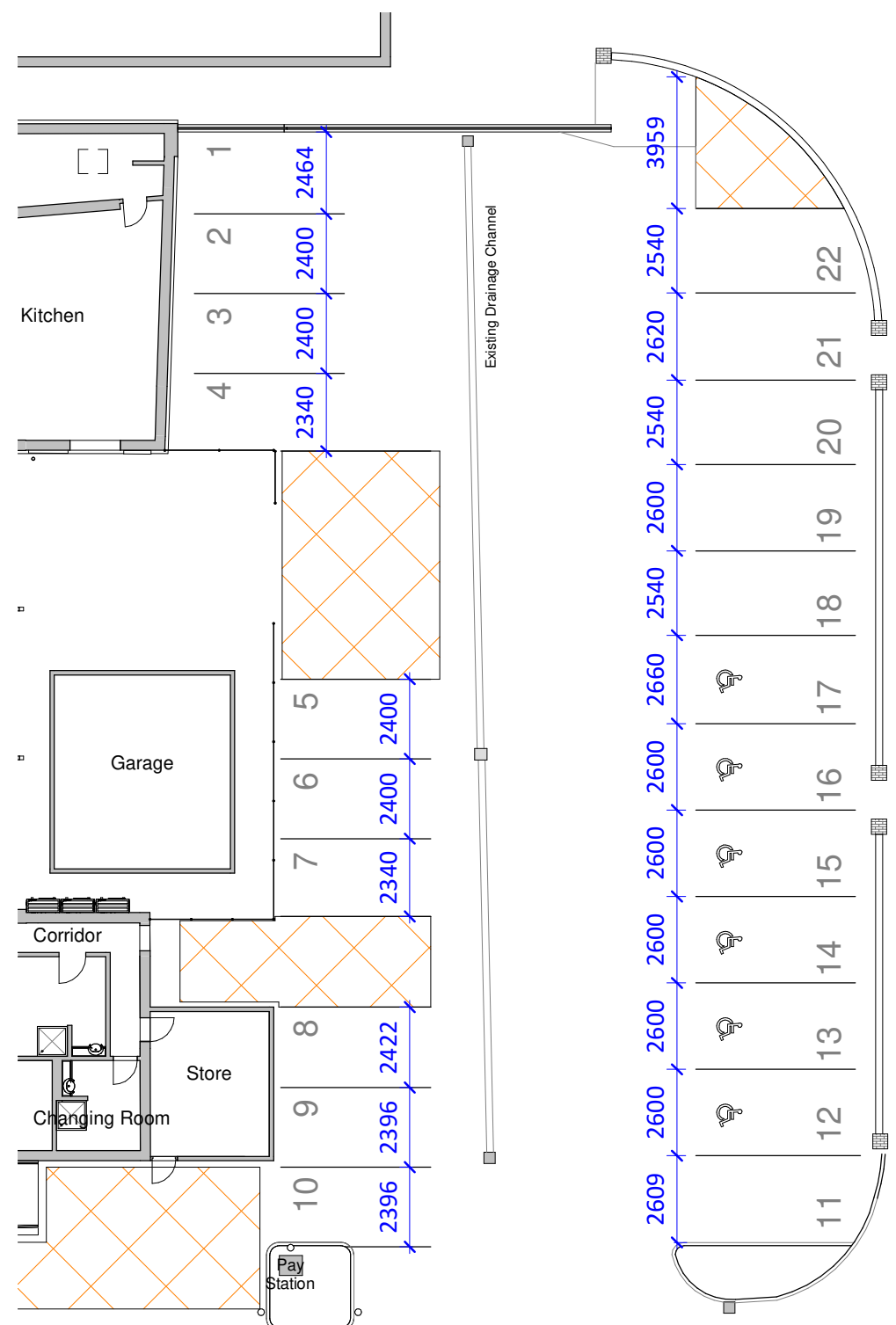

Existing Car Park
1 : 200



A0-3D Proposed Car Park

Copyright: of this drawing is vested in the Architect and it must not be copied or reproduced without consent. **Printing:** Please note that paper prints of this drawing may not be an accurate reproduction of the given scale. Key dimensions are noted for reference. **Purpose:** Unless marked as such drawing should not be used for Construction purposes. Detailed setting out drawings will need to be supplied for Tender and Construction purposes. Figured dimensions only are to be taken from this drawing. All Dimensions and Levels are to be checked on site, prior to commencement. All contractors are to be responsible for taking and checking all dimensions relative to their work. Dimensions are in millimetres unless otherwise stated. bpArchitecture are to be advised of any variation between drawings and site conditions. Co-Ordination This drawings is to be read in conjunction with all other consultants drawings, specifications and schedules.

Rev	Drawn	Comments	Date
1	SS	Record of presentation at client meeting on 22nd September 2020	22/09/2020
2	BPA	Issued for Cheshire East Approval	07 Oct 2020
3	BPA	Tender.	16 Oct 2020

Existing Car Park Issues

- There are **22 existing parking spaces**
- All of the existing line markings and symbols in the car park are barely visible making it difficult for users to determine the designation of the spaces.
- 12 of the parking spaces to the East face a low wall dividing them from M&S Food Hall car park, these spaces are marked out between 2.6 and 2.5m in width.
- 6 of these spaces have a disabled symbol, but these spaces are not statutory disabled width and do not have the cross hatched markings to the side and rear of the space required in part M.
- There are two gaps in the low brick wall marked with piers either side, but there is no clear marked route through , other than pedestrians walking between the parked cars.
- 10 of the parking spaces face the back of the Civic Hall to the west, the parking spaces here are not in line, 4 of these are set back making it difficult for users to see if they are empty or full. This side of the car park also has a cross hatched area aligned with the Means of Escape to the rear of the Civic Hall, and another cross hatched area which provides access to the kitchen door for deliveries.
- to the North of the car park the low wall curves around providing a ramped pedestrian access route towards the Library and a pedestrian route between the Civic Hall and Library
- A dished gully crosses the car park at a slight angle towards which the tarmacadam falls.
- The rear of the Civic Hall has no defined edge which does not help to define the parking and access zones
- There are no safe pedestrian routes in this area of the car park other than pedestrians walking in the road area or between cars.

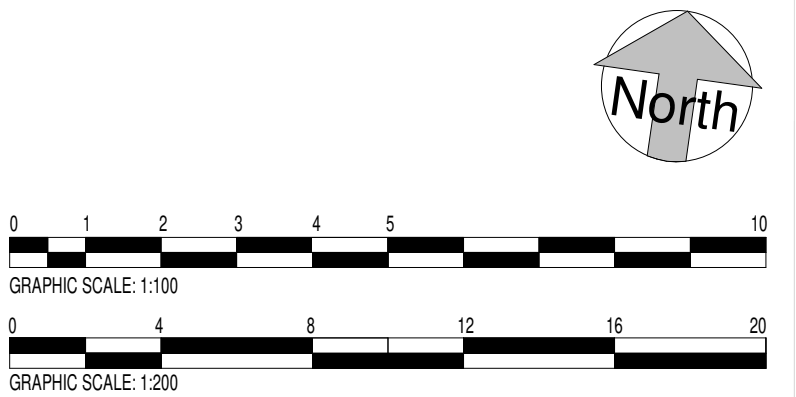

bpArchitecture
01782 515 555
Enquiries@bpArchitecture.co.uk
www.bparchitecture.co.uk
93 High Street Biddulph Staffs ST8 6AB
Architects : Conservation : Interior Architecture : Landscape

Client
Nantwich Town Council
Project
Proposed Alterations and Extension to Nantwich Civic Hall, 4 Market St, Nantwich CW5 5NF
Title
Proposed Car Park Works

Package	9 External Works	Drawn	MQ
Dwg Stage	RIBA Stage 4A: Technical Design	Checked	BSP
Date	September 2020	File	Element
Scale @A1	As indicated	Role	Drawing No
Project No	Originator Block Level Type	Rev	NNN

20-051-BPA-CH-00-DR- **A9-001 T 3**

Print Date: 16/10/2020 12:46:08