

Ground Floor Plan
Showing Foundations
1:50

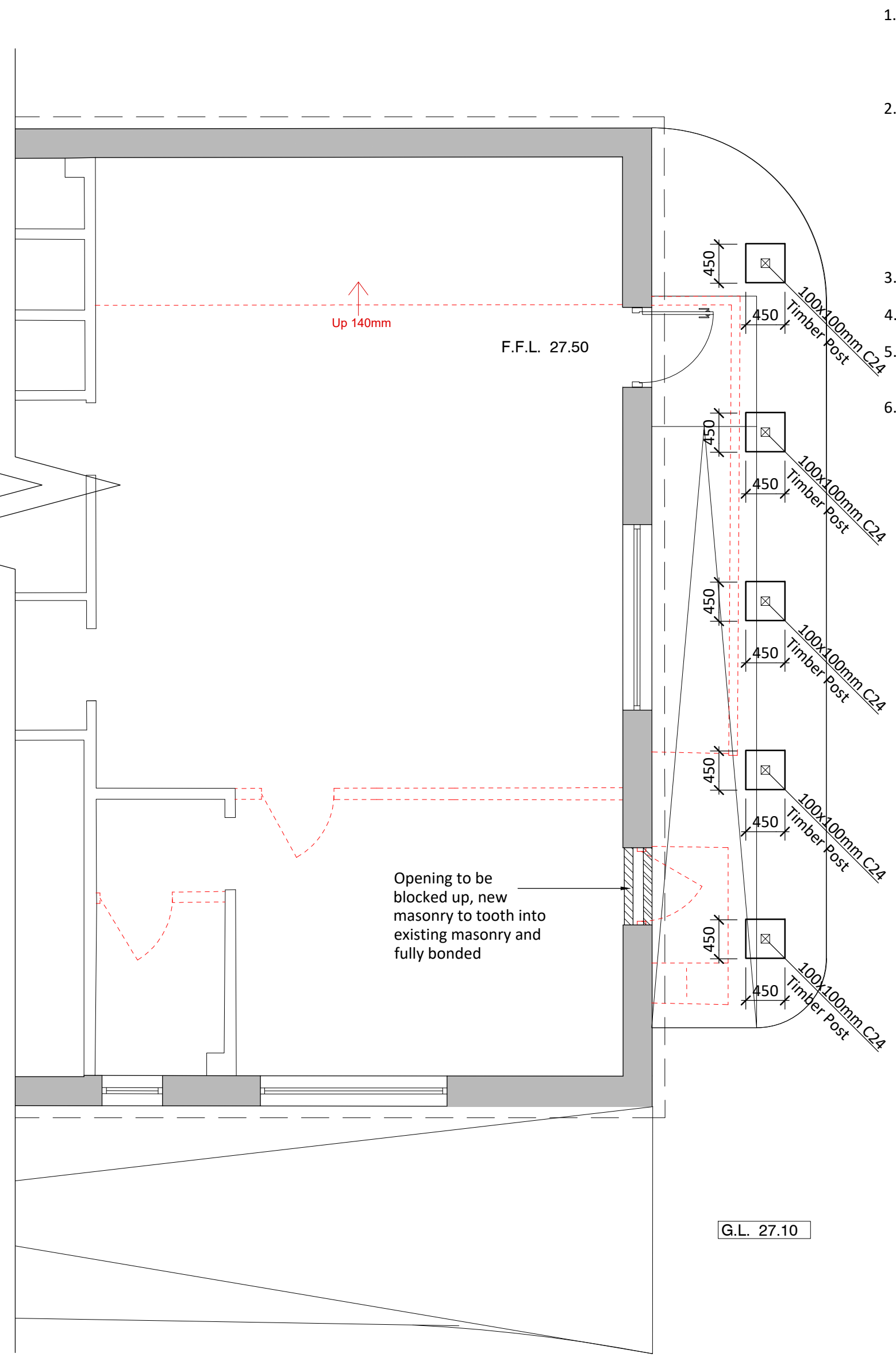

Section A-A
1:20

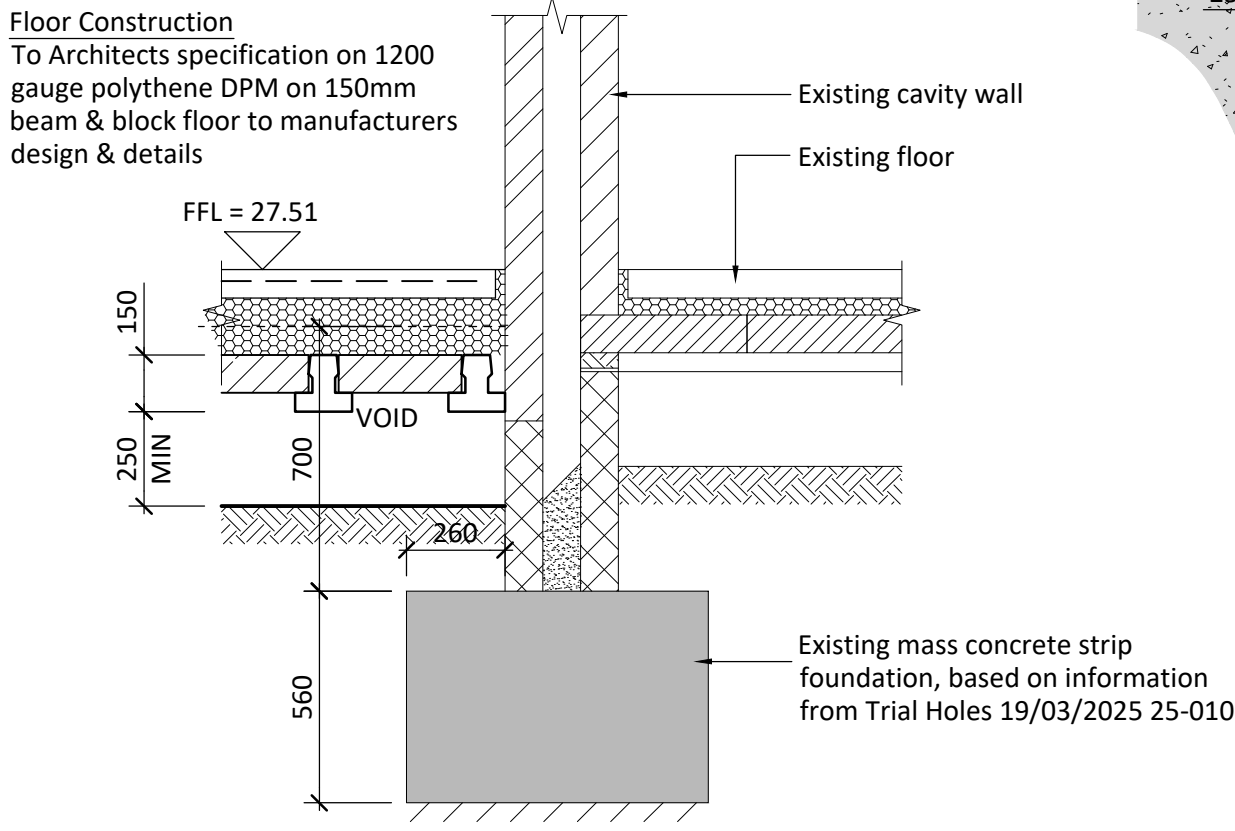

Section B-B
1:20

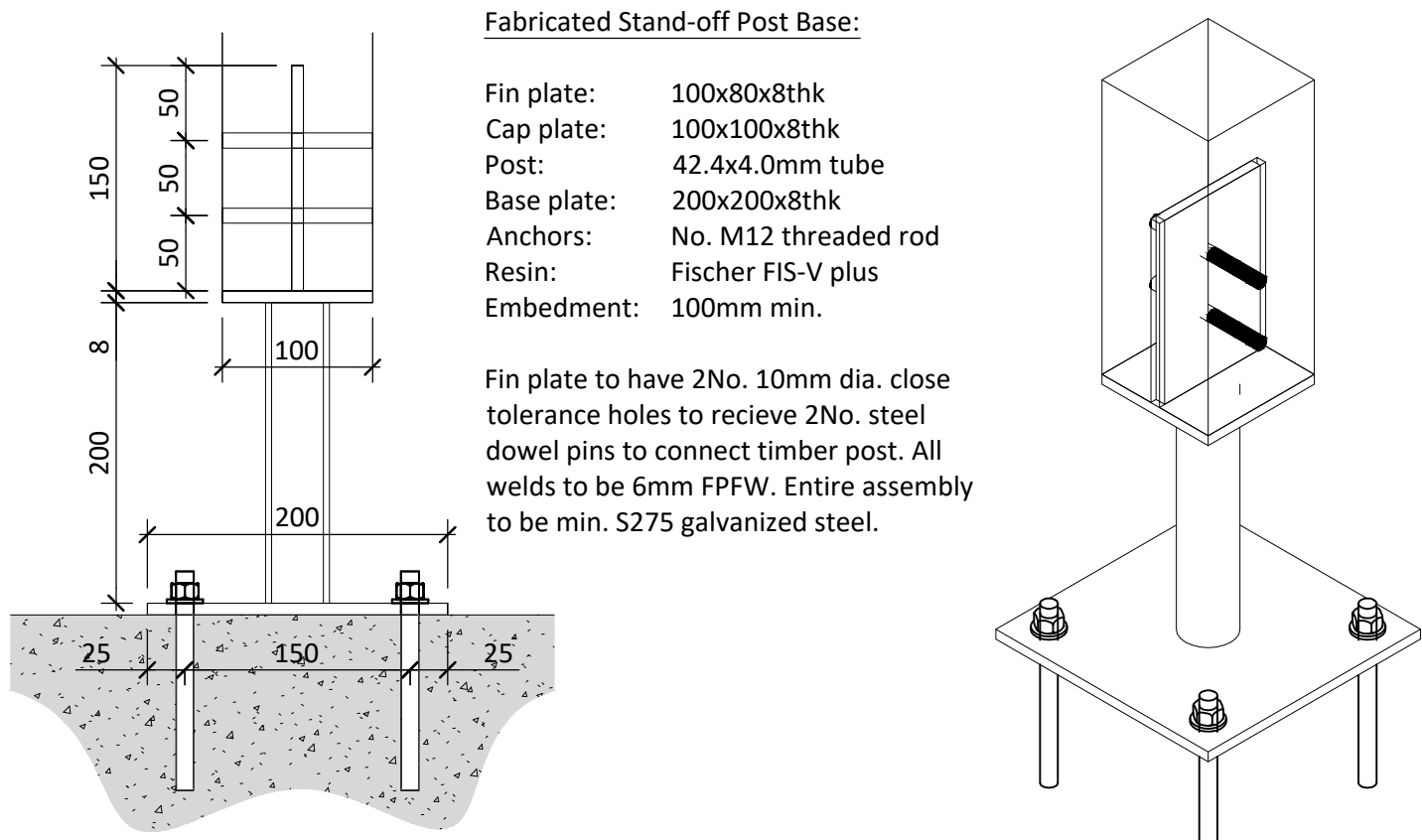

Post Fixing Detail
1:5

Fabricated Stand-off Post Base:

Fin plate: 100x80x8thk
Cap plate: 100x100x8thk
Post: 42.4x4.0mm tube
Base plate: 200x200x8thk
Anchors: No. M12 threaded rod
Resin: Fischer FIS-V plus
Embedment: 100mm min.

Fin plate to have 2No. 10mm dia. close tolerance holes to relieve 2No. steel dowel pins to connect timber post. All welds to be 6mm FPFW. Entire assembly to be min. S275 galvanized steel.

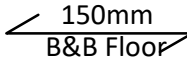
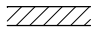
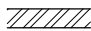
LEGEND	
	Indicates direction of span of 150mm deep pcc beam & block flooring system to Specialist design.
	Manufacturer is to provide a system to ensure that the floor does not excessively deflect.
The beam & block floor system is to be designed by the manufacturer to support the loads indicated on the plan and the following UDL loads:	
Finishes	= 1.8 kN/m ²
Imposed Load (offices)	= 3.0 kN/m ²
Partitions	= 1.0 kN/m ²
	Medium Dense Blockwork
	Brickwork to Architects specification
MJ	Movement Joint

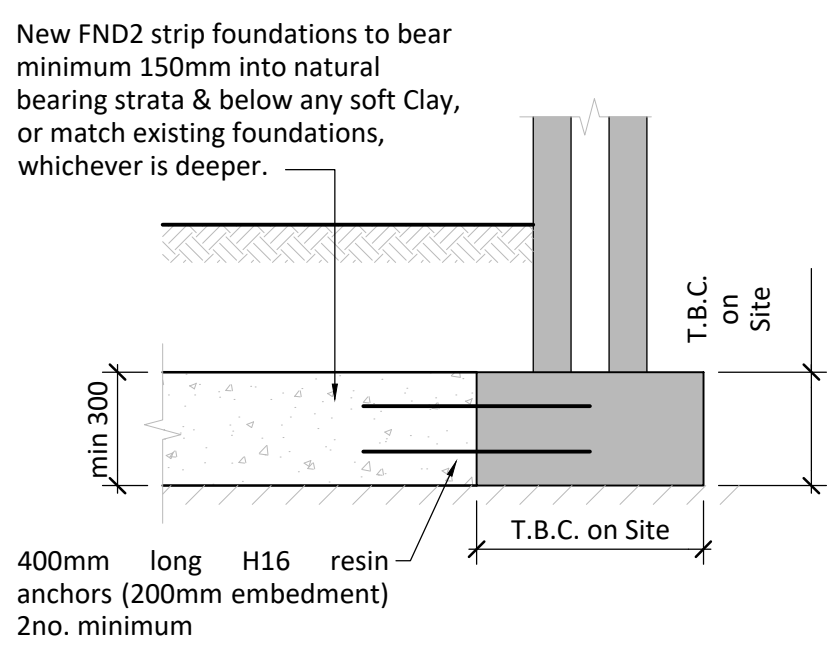

Foundation Connection Detail
1:20

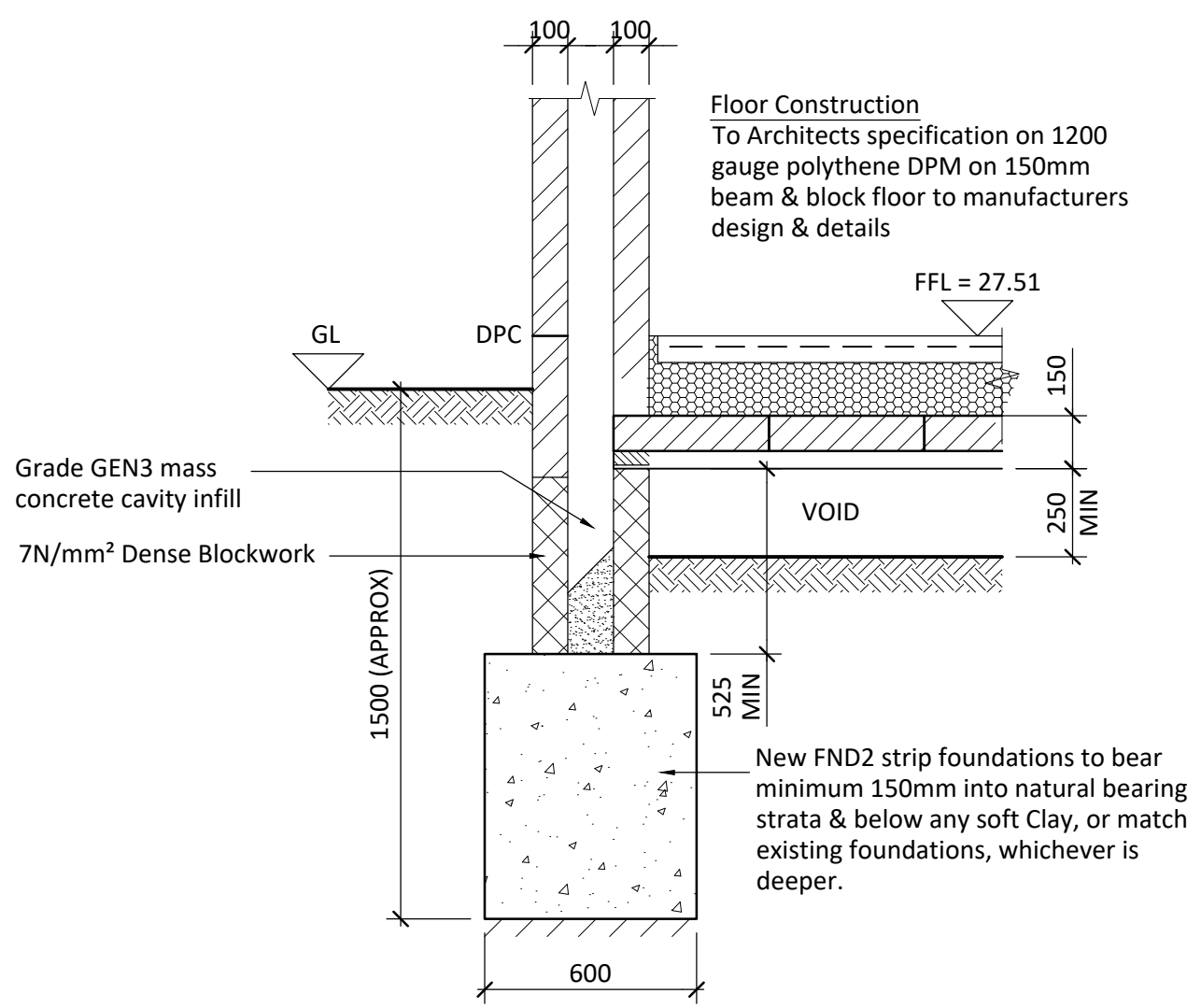

Section A-A
1:20

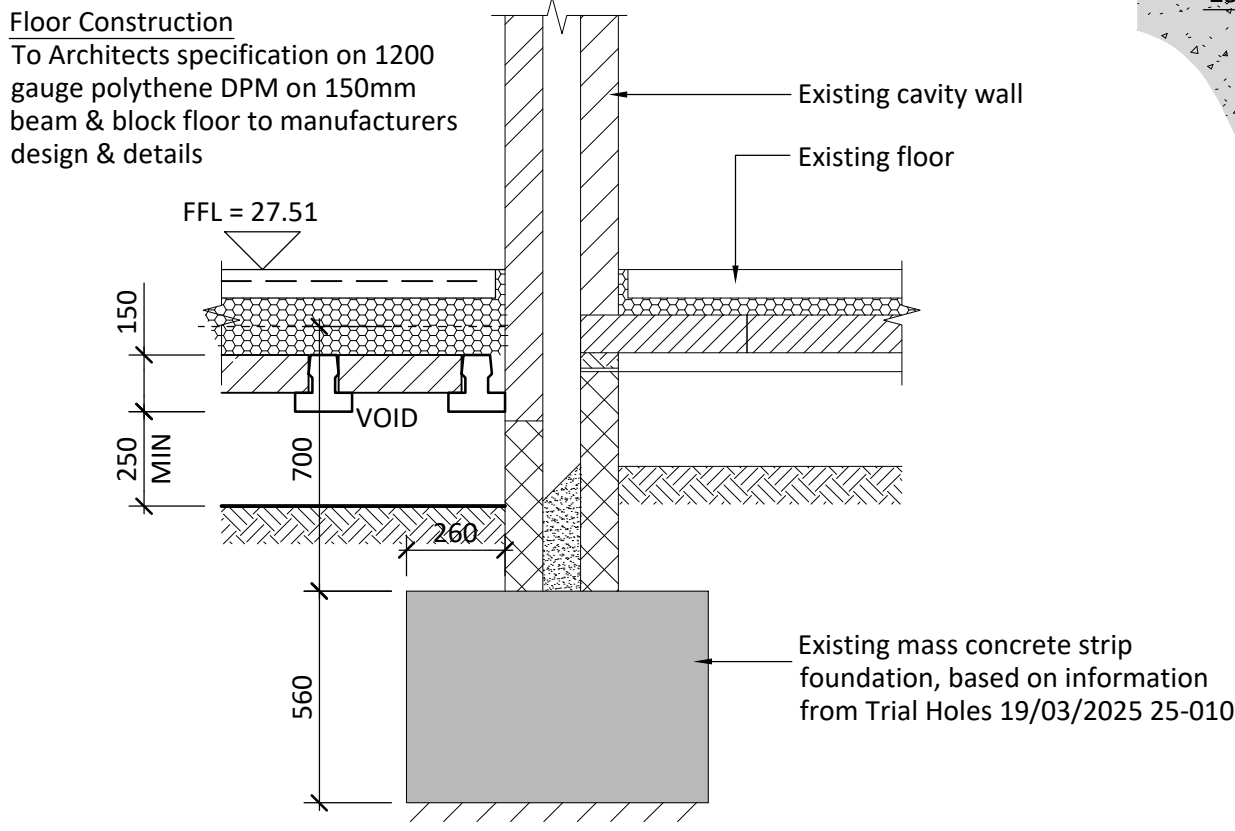

Section B-B
1:20

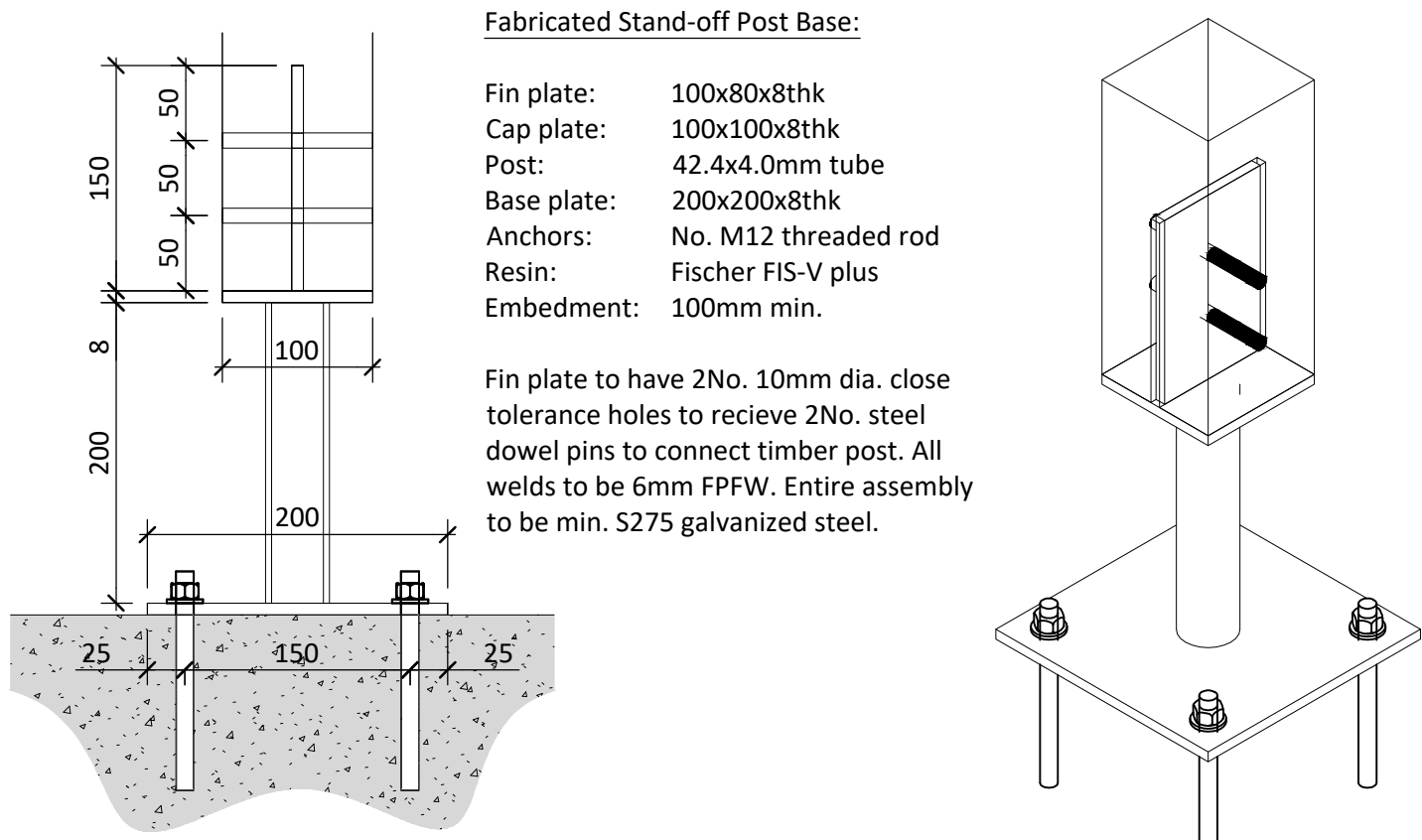

Post Fixing Detail
1:5

Fabricated Stand-off Post Base:

Fin plate: 100x80x8thk
Cap plate: 100x100x8thk
Post: 42.4x4.0mm tube
Base plate: 200x200x8thk
Anchors: No. M12 threaded rod
Resin: Fischer FIS-V plus
Embedment: 100mm min.

Fin plate to have 2No. 10mm dia. close tolerance holes to relieve 2No. steel dowel pins to connect timber post. All welds to be 6mm FPFW. Entire assembly to be min. S275 galvanized steel.

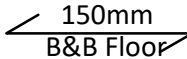
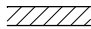
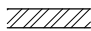
LEGEND	
	Indicates direction of span of 150mm deep pcc beam & block flooring system to Specialist design.
	Manufacturer is to provide a system to ensure that the floor does not excessively deflect.
The beam & block floor system is to be designed by the manufacturer to support the loads indicated on the plan and the following UDL loads:	
Finishes	= 1.8 kN/m ²
Imposed Load (offices)	= 3.0 kN/m ²
Partitions	= 1.0 kN/m ²
	Medium Dense Blockwork
	Brickwork to Architects specification
MJ	Movement Joint

- General Notes
- These drawings are to be read in conjunction with all relevant Architect's and Engineer's drawings and specifications, refer to Drg. No.00 for Structural Specification
 - Except where specific dimensions are shown on these drawings, all setting out shall be in accordance with the architects drawings and specifications. Any discrepancy between these drawings and the architects drawings or the actual site dimensions should be referred to the engineer immediately and confirmed in writing. The contractor is responsible for the accuracy of all dimensions and the setting out.
 - Do not scale from these drawings. If in doubt, ask.
 - All dimensions are in millimetres unless noted otherwise.
 - All proprietary materials to be in accordance with manufacturers specifications and to Engineer's approval.
 - All proprietary CDP elements shown on the drawings should be treated as indicative and are subject to detailed design by specialist manufacturer/supplier. The contractor should make suitable allowance for third party design/detailing and potential impact on the permanent work design.

S.H.E (Safety, Health & Environmental) Information in accordance to CDM regulations 2015. The following notes refer to Hazards/Risks considered in addition to those normally associated with this type of work. Number references correspond to Risk Register outlined on General Notes drawing.

Existing Structural System

Excavations Adjacent to Existing Foundations and Adjacent Buildings

P02	14.08.25	Updates as per latest Architects drawings	AN
P01	18.06.25	Preliminary Issue	AN
Rev	Date	Revision Description	Issued by

Drawing Status: S1 - Suitable for Co-ordination

GODSELL • ARNOLD
PARTNERSHIP LTD
Consulting Civil and Structural Engineers
7 Arrowsmith Court, Station Approach
Broadstone, Dorset. BH18 8AX
Telephone: 01202 600 900 Website: www.gapltd.net

Client: Chickerell Town Council

Project: Chickerell Hall

Drawing Title: Ground Floor Plan Showing Foundations

Scale: 1:50 @ A1 Drawn: AN Checked: HL

Project-Originator-Zone-Level-Type-Role Drawing No.: Revision:

25039-GAP-XX-00-DR-S 0010 P02