



REVISION HISTORY

REV	DATE	DESCRIPTION	BY	CHKD
6	19/10/2022	ECN2022-0277	LP	AG

NOTES:

1. PRODUCT WEIGHT = 51kg
2. RECOMMENDED TORQUE 17Nm FOR TIGHTENING WALL FIXINGS
3. APPLY AN APPROVED ANTI PICK HARD SET MASTIC AROUND THE BACK & BOTTOM EDGES OF THE PAN TO SEAL IT TO THE WALL & FLOOR.

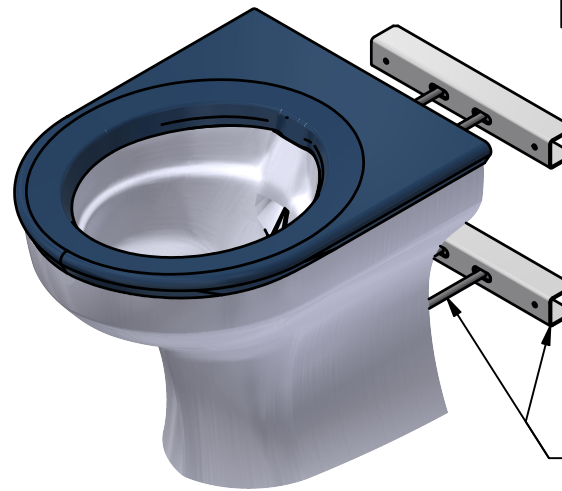

(A) WALL FIXINGS M10 x 225mm (4off)
& CLAMP BRACKETS (2off)

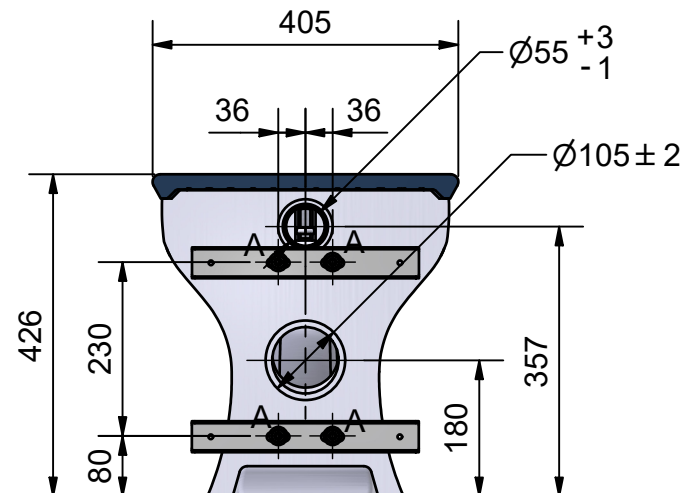
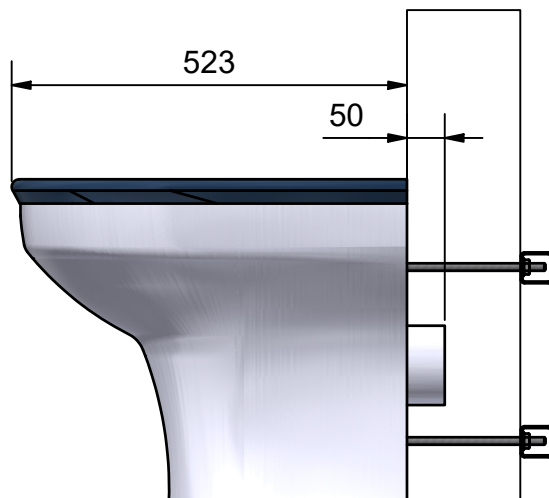
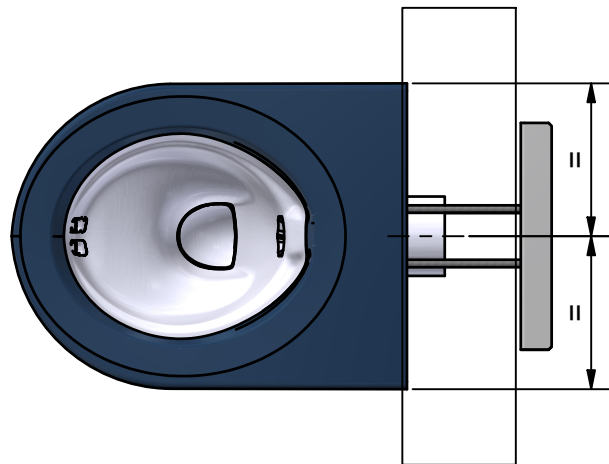

© 2020 Copyright THIS DRAWING IS THE PROPERTY OF WALLGATE LIMITED AND IS ISSUED ON THE STRICT UNDERSTANDING THAT THE INFORMATION CONTAINED WILL NOT BE REPRODUCED, COPIED OR USED WITHOUT PRIOR AGREEMENT OF WALLGATE LTD.

Wallgate
ROBUST. INNOVATIVE. WASHROOMS

TITLE: WC PAN WITH FIXED SOLID
SURFACE SEAT

Drg No: CWC-250-AST

Model/Client/Project:

MATERIAL: POLYESTER SOLID
SURFACE

FINISH: SILK - GLOSS POLISH

Limits: (unless stated)
± 0.25mm (sheetmetal)
± 0.10mm (machined)
± 2.00mm (pattern)
± 5.00mm (moulded)

All dimensions in mm,
All angles 90° (unless stated)

Scale: NTS

A4 3rd

