

HORIZONTAL FLOODLIGHT ILLUMINANCE

ILLUSTRATING ILLUMINANCE ONTO AGP FIELD OF PLAY AND OVERSPILL /
BACKWARD LIGHT ONTO SURROUNDING LAND AT GROUND LEVEL

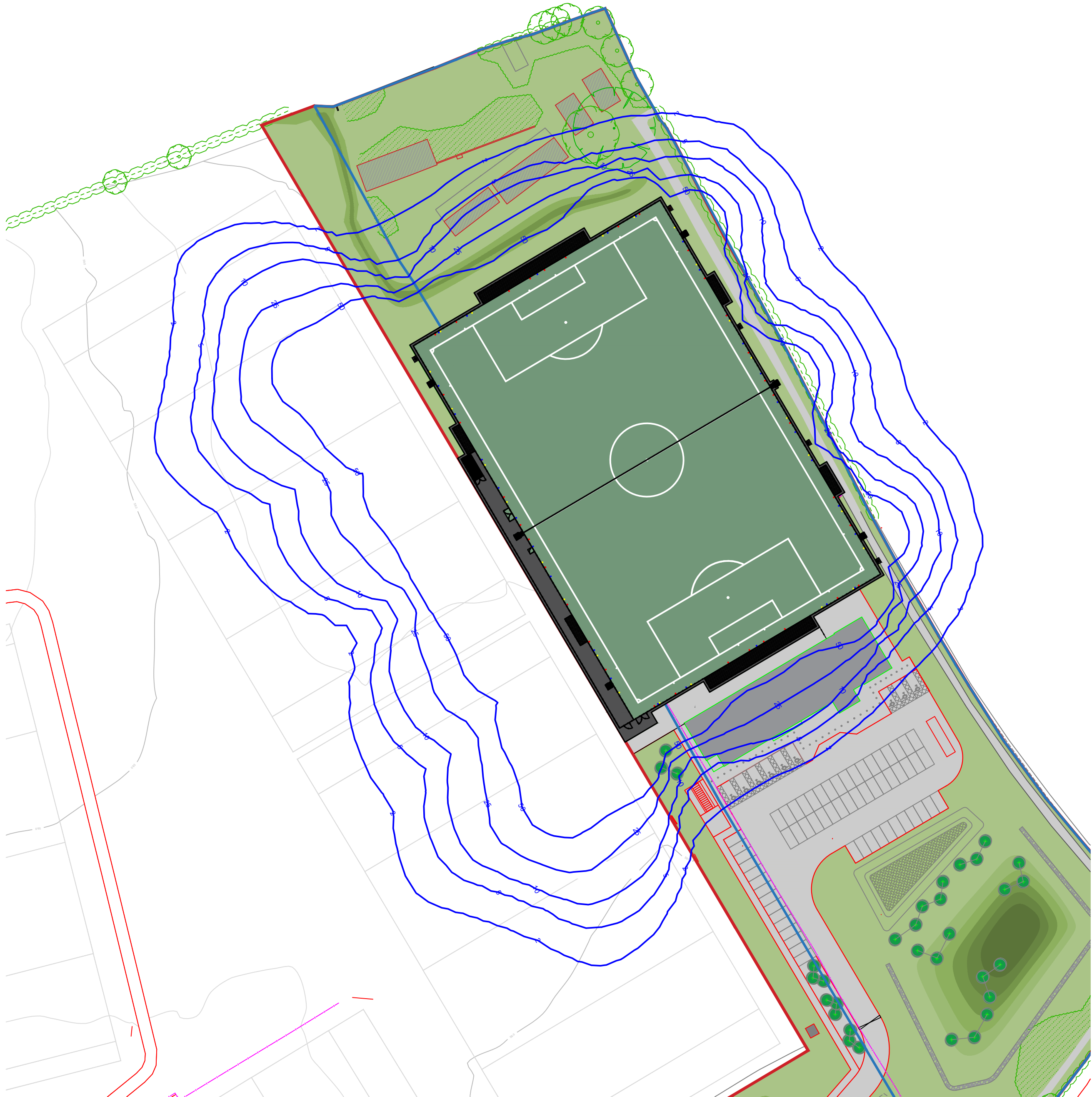

VERTICAL FLOODLIGHT ILLUMINANCE

ILLUSTRATING ILLUMINANCE ONTO AGP FIELD OF PLAY AND OVERSPILL /
BACKWARD LIGHT ONTO SURROUNDING LAND AT 1.8M ABOVE GROUND LEVEL

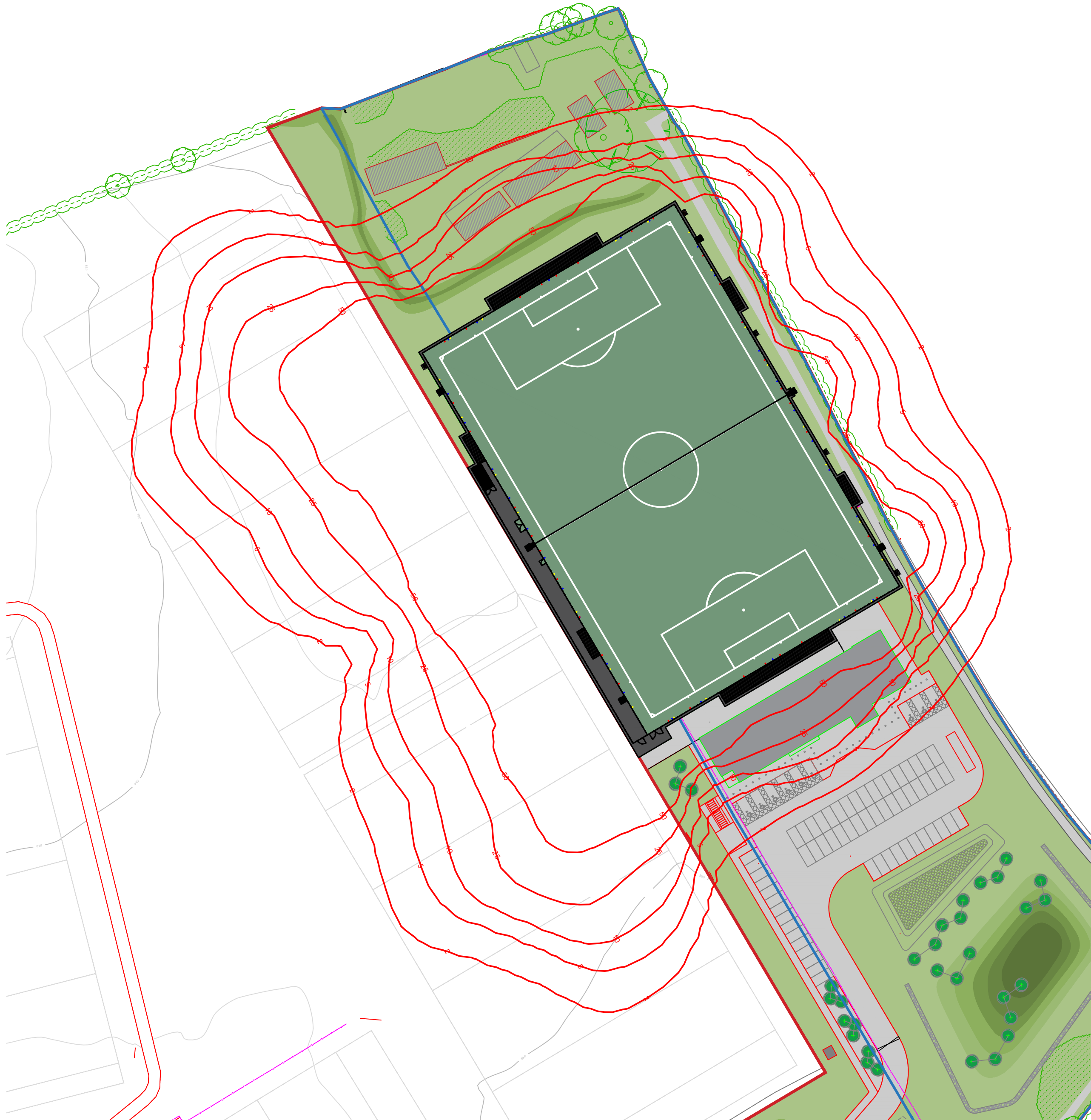

ADVISORY NOTES

PROPOSED FLOODLIGHT SYSTEM PROVIDES LIGHTING PERFORMANCE IN ACCORDANCE WITH FA RECOMMENDATIONS (FIFA'S CLASS II LIGHTING REQUIREMENTS) FOR VARYING TYPES OF PLAY AS FOLLOWS:

USE	MAINTAINED AVERAGE ILLUMINANCE	UNIFORMITY RATIO (EV.MIN/EV.AVE)	DIVERSITY RATIO (EV.MIN/EV.MAX)	MAXIMUM GLARE RATING (GR)
COMPETITION	>200LUX	>0.60	>0.50	<50
CROSS PLAY	>120LUX	>0.60	>0.50	<50
TRAINING	>120LUX	>0.60	>0.50	<50

FLOODLIGHTS SHOULD ALSO BE DESIGNED IN SUCH A WAY TO ALLOW EACH INDIVIDUAL SECTION OF THE PITCH (LATERAL CROSS PITCHES) TO BE INDIVIDUALLY PROGRAMMED TO FACILITATE ECONOMICAL MANAGEMENT AND PREVENT OVER LIGHTING TO PITCHES AREAS WHEN NOT IN USE

ILP REDUCTION OF OBTRUSIVE LIGHT GN01:2011

THIS SITE IS CLASSIFIED AS AN ENVIRONMENTAL ZONE E2, WHICH IS A RURAL AREA WITH LOW DISTRICT BRIGHTNESS; FOR EXAMPLE A VILLAGE OR RELATIVELY DARK OUTER SUBURBAN LOCATION

THE ILP DESIGN GUIDANCE FOR THIS ENVIRONMENTAL ZONE IS AS FOLLOWS:

OBTRUSIVE LIGHT LIMITATIONS FOR EXTERIOR LIGHTING INSTALLATIONS - GENERAL OBSERVERS

SKY GLOW ULR (MAX %)	2.5%
LIGHT INTRUSION (INTO WINDOWS) EV (LUX)	5 LUX PRE CURFEW / 1 LUX POST CURFEW
LUMINAIRE INTENSITY I (CANDELAS)	7500 I PRE CURFEW / 500 I POST CURFEW
BUILDING LUMINANCE AVERAGE L (CD/M2)	5 CD/M2

LIGHT IMPACT

PROPOSED FLOODLIGHTS COMPRISE EIGHT 15M HIGH MASTS MOUNTED WITH SIXTEEN LED LUMINAIRES IN THE FOLLOWING ARRANGEMENT:

NORTH WESTERN MAST	2NO. LUMINAIRES	NORTH EASTERN MAST	2NO. LUMINAIRES
CENTRAL WESTERN MAST	2NO. LUMINAIRES	CENTRAL EASTERN MAST	2NO. LUMINAIRES
SOUTH WESTERN MAST	2NO. LUMINAIRES	SOUTH EASTERN MAST	2NO. LUMINAIRES
BACKLIGHTS AIMED OVER ADJACENT RUGBY PITCHES		2NO. LUMINAIRES	

THE FLOODLIGHT DESIGN ACHIEVES VALUES WHICH MEETS THE REQUIREMENTS OF BS EN 12193 AS FOLLOWS:

PERIOD	PROPERTY	RESULT
INITIAL 100HRS USAGE		AVERAGE ILLUMINANCE 256 LUX UNIFORMITY 0.69 MIN / AVE
MAINTAINED USAGE WITH 0.9 MAINTENANCE FACTOR		AVERAGE ILLUMINANCE 244 LUX UNIFORMITY 0.69 MIN / AVE

THE EXTENT OF LIGHT INTRUSION, LIGHT TRESPASS AND LIGHT INTENSITY (GLARE) TO RESIDENTIAL NEIGHBOURS CREATED BY NEW AGP FLOODLIGHTS COMPLIES WITH ILP RECOMMENDATIONS FOR AN ENVIRONMENTAL ZONE E2 AND MITIGATION TREATMENTS ARE NOT REQUIRED

CHECK ALL DIMENSIONS PRIOR TO COMMENCEMENT OF WORK

NO GUARANTEE CAN BE GIVEN THAT ALL SERVICES HAVE BEEN SHOWN ON THE DRAWING

NO GUARANTEE CAN BE GIVEN TO THE ACCURACY AND COMPLETENESS OF ANY SERVICE PROVIDER RECORD INFORMATION SHOWN IN THIS DRAWING AND NO LIABILITY WILL BE ACCEPTED FOR ANY LOSSES THAT ARISE DUE TO A LACK OF ACCURACY IN ANY SERVICE PROVIDERS RECORD INFORMATION

RELEVANT SERVICE DRAWINGS SHOULD BE OBTAINED FROM APPROPRIATE SERVICE PROVIDERS AND USED IN CONJUNCTION WITH THIS DRAWING

REFERENCE SHOULD ALSO BE MADE TO HISTORICAL PLANS AND AS BUILT DRAWINGS

THIS DRAWING IS COPYRIGHT TO LABOSPORT LTD



15M HIGH FLOODLIGHT MAST WITH LUMINAIRES

1 5 10 25 50

INCREMENTAL HORIZONTAL ILLUMINANCE CONTOURS (EXPRESSED IN LUX)

1 5 10 25 50

INCREMENTAL VERTICAL ILLUMINANCE CONTOURS (BACKWARD LIGHT / OVERSPILL) (EXPRESSED IN LUX)

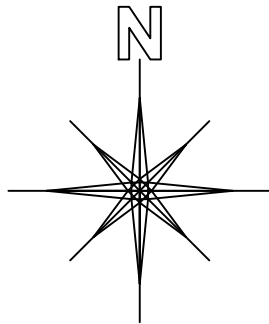

Labosport Ltd Unit 3, Aerial Way, Huccall, Nottinghamshire, NG15 6DW +44 (0)1525 968 1998 www.labosport.com info@labosport.co.uk			
TROWBRIDGE TOWN COUNCIL			
DORIC PARK			
ARTIFICIAL GRASS PITCH (AGP)			
AGP FLOODLIGHTS			
01			
PLANNING	TB	17.11.19	
LSUK 18-0108		1:500	
A1			18-0108 BM25583 0346

