

**SECTION 7-7**  
(1:10)

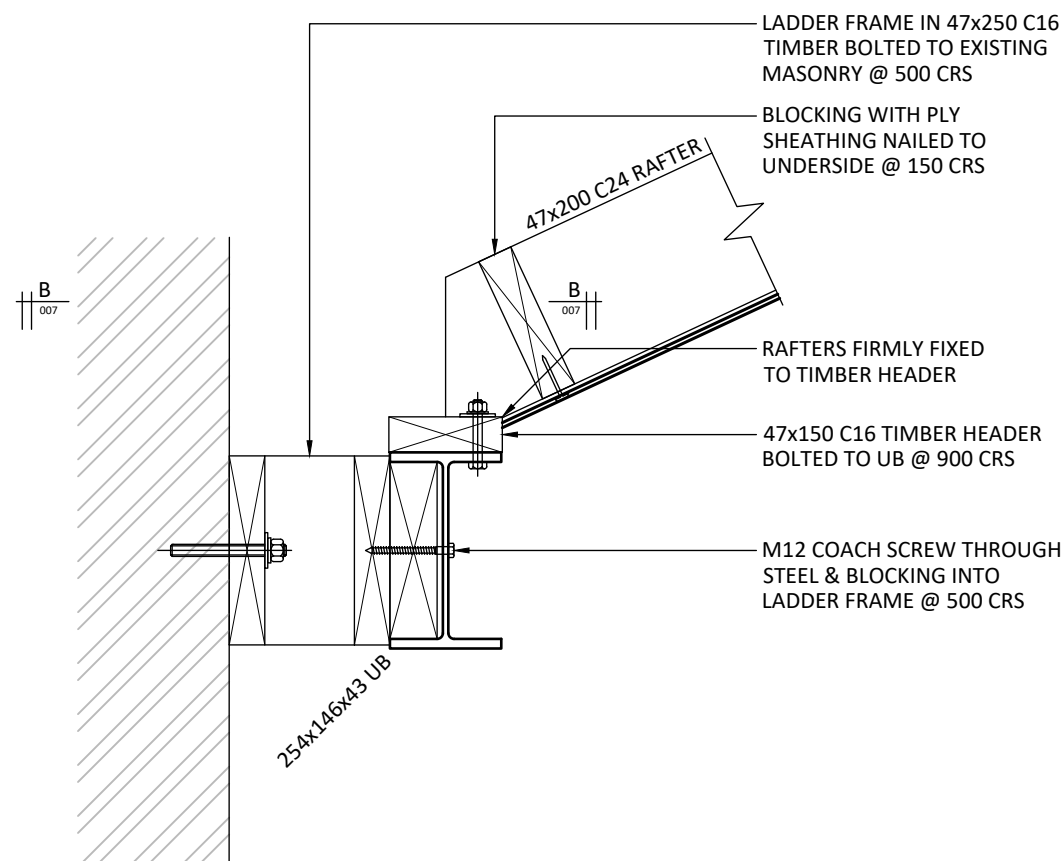

**SECTION 8-8**  
(1:10)

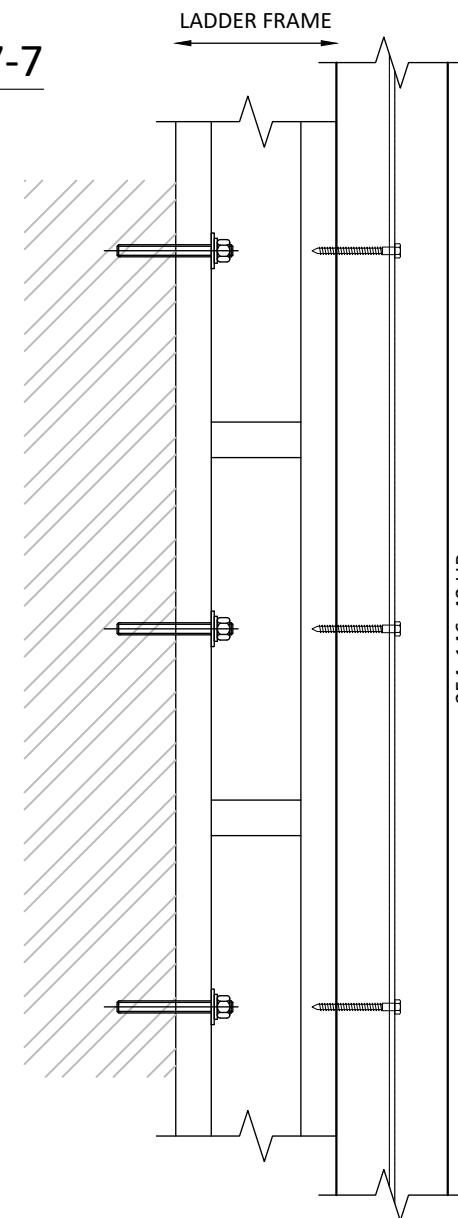

**SECTION B-B  
AT SECTION 8-8  
PLAN VIEW**  
(1:10)

**FOR CONSTRUCTION**

THIS ISSUE	A	CONSTRUCTION	31.07.19	CONSTRUCTION ISSUE	OJF/CCW
-	COMMENT	28.06.19	FIRST ISSUE	OJF/CCW	
Revision	Reason for Issue	Issue Date	Revision Notes	DRW/CHK	

Title: SECTIONS & DETAILS 4

Project N.o: 18234  
Drawing N.o: 007  
Drawn: OJF  
Scale @ A3: AS SHOWN

Project: LEIGH-ON-SEA COMMUNITY CENTRE  
71-73 ELM ROAD  
SS9 1SP

Client: LEIGH-ON-SEA TOWN COUNCIL

**CRUCIS DESIGNS LIMITED**  
consulting civil & structural engineers  
Suite 1, Business Centre, 8 Madeira Avenue,  
Leigh-on-Sea, Essex, SS9 3EB  
email:info@crucisdesigns.com tel:01702 416 114

**CRUCIS DESIGNS**  
consulting civil and structural engineers