

TENDER

**THE HORNIMAN MUSEUM
ANTHROPOLOGY GALLERY**

**COLLECTION: PEOPLE
STORIES**

Neither this drawing, nor any of such ideas, arrangements, designs or plans shall be appropriated or disclosed to any person, firm or corporation for any use whatsoever, except by the specific and written permission of Ralph Appelbaum Associates (RAA).

This drawing is for design control only and may not be used in lieu of Contractor's shop drawing. Written dimensions on drawings shall have authority over scaled. Contractors and manufacturers shall verify and be responsible for all dimensions and conditions on the job and inform RAA of all variations from drawing prior to performing the work. RAA shall first see and approve Contractor's full-size shop details before fabrication. It is the Contractor's responsibility to verify and ensure the structural integrity of this design with a licensed structural engineer.

Notes:

Revision Date Note

Ralph Appelbaum Associates Incorporated
1-3 Portland Lane London E2 11 4 7101
TEL 020 7698 7598 FAX 020 7698 7597
EMAIL info@raa.com

Drawing Title: HMA_GA - Lower Ground Floor

Date: June 2016 Scale: 1:100

Dwg. No.: 0581A_GA_101

File Name: Rev:

Drawn: DG Checked:

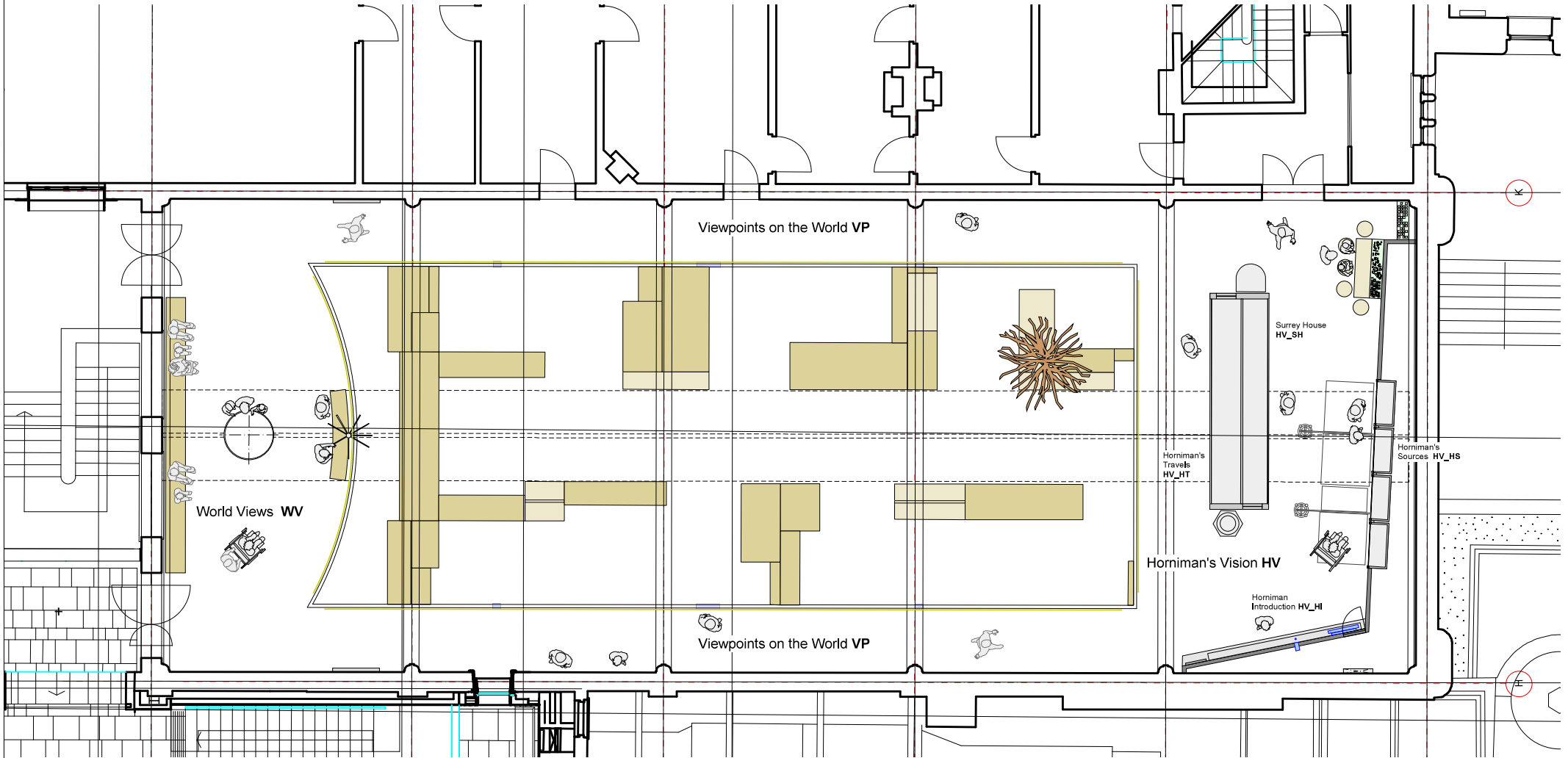

TENDER

THE HORNIMAN MUSEUM
ANTHROPOLOGY GALLERY

COLLECTION PEOPLE
STORIES

Neither this drawing, nor any of such ideas, arrangements, designs or plans shall be appropriated or disclosed to any person, firm or corporation for any use whatsoever, except by the specific and written permission of Ralph Appelbaum Associates (RAA).

This drawing is for design control only and may not be used in lieu of Contractor's shop drawing. Written dimensions on drawings shall have authority over scaled. Contractors and manufacturers shall verify and be responsible for all dimensions and conditions on the job and inform RAA of all variations from drawing prior to performing the work. RAA shall first see and approve Contractor's full-size shop details before fabrication. It is the Contractor's responsibility to verify and ensure the structural integrity of this design with a licensed structural engineer.

Notes:

Revision Date Note

Ralph Appelbaum Associates Incorporated
1-5 Portpool Lane London E3 1N 7DU
TEL 020 7592 7598 FAX 020 7592 7597
EMAIL info@raa.co.uk

Drawing Title: HMA_GA - Ground Floor

Date: June 2016 Scale: 1:100

Dwg. No. 0581A_GA_102

File Name: Rev:

Drawn: DG Checked: