

Do not scale from this drawing. These drawings are not to be relied upon by any contractor. Subject to copyright.

Key:

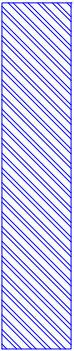

Structure to be demolished



Wall infill with lightweight blockwork

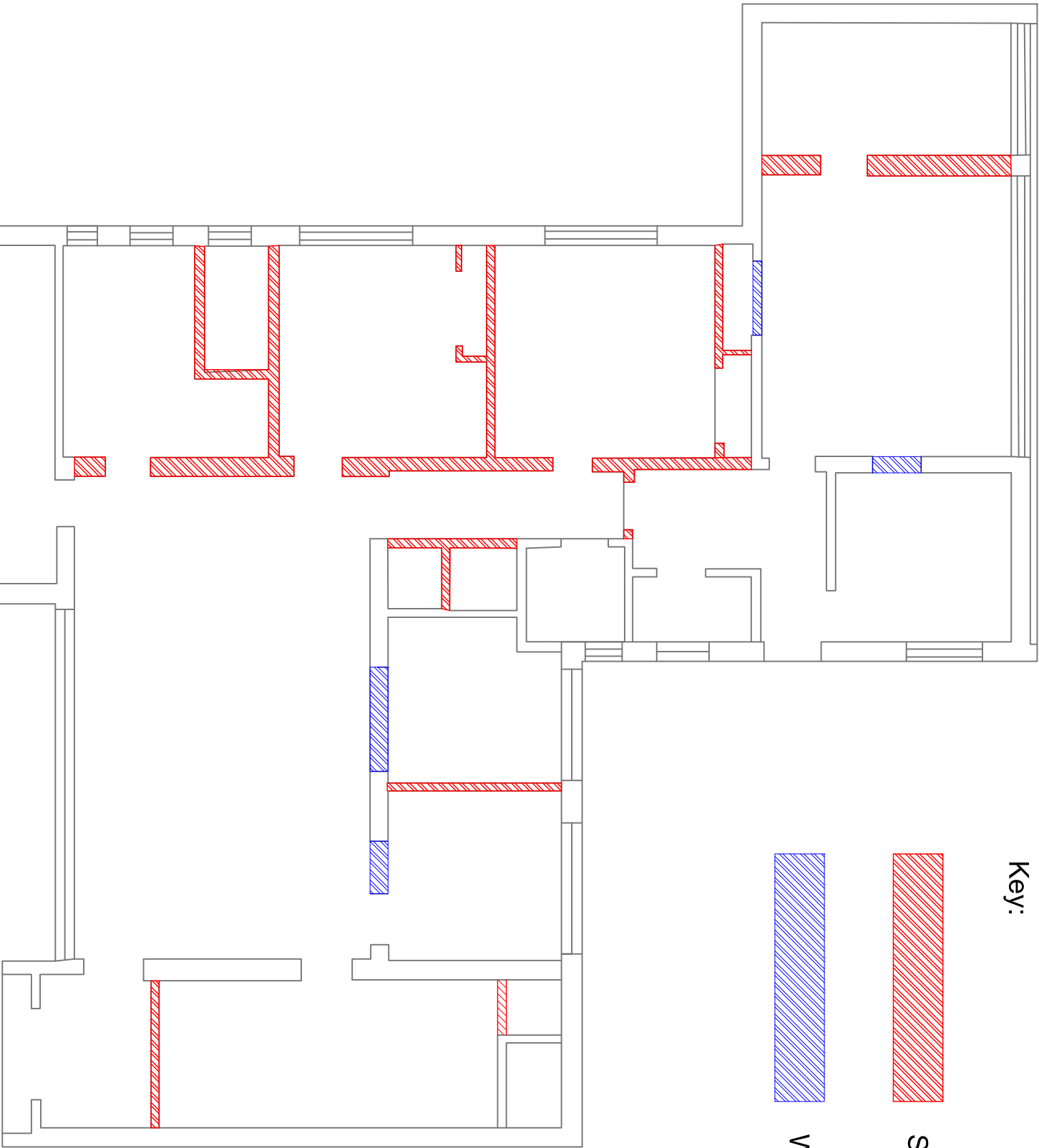

rev	date	description

**Hartnell Taylor Cook LLP**  
Somerset House,  
18 Canynge Road,  
Bristol.  
BS8 3JX  
Tel: 0117 923 9234  
Fax: 0117 923 9237  
Email : [info@htc.uk.com](mailto:info@htc.uk.com)  
Web: [www.htc.uk.com](http://www.htc.uk.com)



client:   
property: Shrub End Clinic  
Colchester

E PIMS No:

title:   
Demolition Plan

drawn **GD** checked **n/a**  
date **AUG17** size **A3**  
scale **NTS**

number **Demo-001** rev