

**TOWN AND COUNTRY PLANNING ACT 1990
THE TOWN AND COUNTRY PLANNING (TREE PRESERVATION)(ENGLAND)
REGULATIONS 2012**

**PONSHARDEN INDUSTRIAL ESTATE FALMOUTH
TREE PRESERVATION ORDER 2018**

THE CORNWALL COUNCIL, in exercise of the powers conferred on them by section 198 of the Town and Country Planning Act 1990 make the following Order—

Citation

1. This Order may be cited as the **PONSHARDEN INDUSTRIAL ESTATE FALMOUTH TREE PRESERVATION ORDER 2018**

Interpretation

2. (1) In this Order "the authority" means **THE CORNWALL COUNCIL**

(2) In this Order any reference to a numbered section is a reference to the section so numbered in the Town and Country Planning Act 1990 and any reference to a numbered regulation is a reference to the regulation so numbered in the Town and Country Planning (Tree Preservation)(England) Regulations 2012.

Effect

3. (1) Subject to article 4, this Order takes effect provisionally on the date on which it is made.

(2) Without prejudice to subsection (7) of section 198 (power to make tree preservation orders) or subsection (1) of section 200 (tree preservation orders: Forestry Commissioners) and, subject to the exceptions in regulation 14, no person shall—

(a) cut down, top, lop, uproot, wilfully damage, or wilfully destroy; or

(b) cause or permit the cutting down, topping, lopping, uprooting, wilful damage or wilful destruction of, any tree specified in the Schedule to this Order except with the written consent of the authority in accordance with regulations 16 and 17, or of the Secretary of State in accordance with regulation 23, and, where such consent is given subject to conditions, in accordance with those conditions.

Application to trees to be planted pursuant to a condition

4. In relation to any tree identified in the first column of the Schedule by the letter "C", being a tree to be planted pursuant to a condition imposed under paragraph (a) of section 197 (planning permission to include appropriate provision for preservation and planting of trees), this Order takes effect as from the time when the tree is planted.

DATED THIS 6th day of February 2018

Signed on behalf of THE CORNWALL COUNCIL

Anne Brown.

Authorised by the Council to sign in that behalf

CONFIRMATION OF ORDER

~~This Order was confirmed by THE CORNWALL COUNCIL without modification on the _____ day of _____~~

OR

This Order was confirmed by THE CORNWALL COUNCIL, subject to the modifications indicated by striking through the original Map and Schedule with a red line and replacing them with a Modified Map and Modified Schedule on the 31st day of July 2018

Signed on behalf of THE CORNWALL COUNCIL

Melanie O'Sullivan
Melanie O'Sullivan
Head of Legal Services

Authorised by the Council to sign in that behalf

DECISION NOT TO CONFIRM ORDER

A decision not to confirm this Order was taken by THE CORNWALL COUNCIL on the _____ day of _____

Signed on behalf of THE CORNWALL COUNCIL

Authorised by the Council to sign in that behalf

VARIATION OF ORDER

This Order was varied by THE CORNWALL COUNCIL on the _____ day of _____ by a variation order under the reference number _____ a copy of which is attached

Signed on behalf of THE CORNWALL COUNCIL

Authorised by the Council to sign in that behalf

REVOCATION OF ORDER

This Order was revoked by THE CORNWALL COUNCIL on the _____ day of _____

Signed on behalf of THE CORNWALL COUNCIL

Authorised by the Council to sign in that behalf

**Ponsharden Industrial Estate Falmouth Tree Preservation Order
2018**

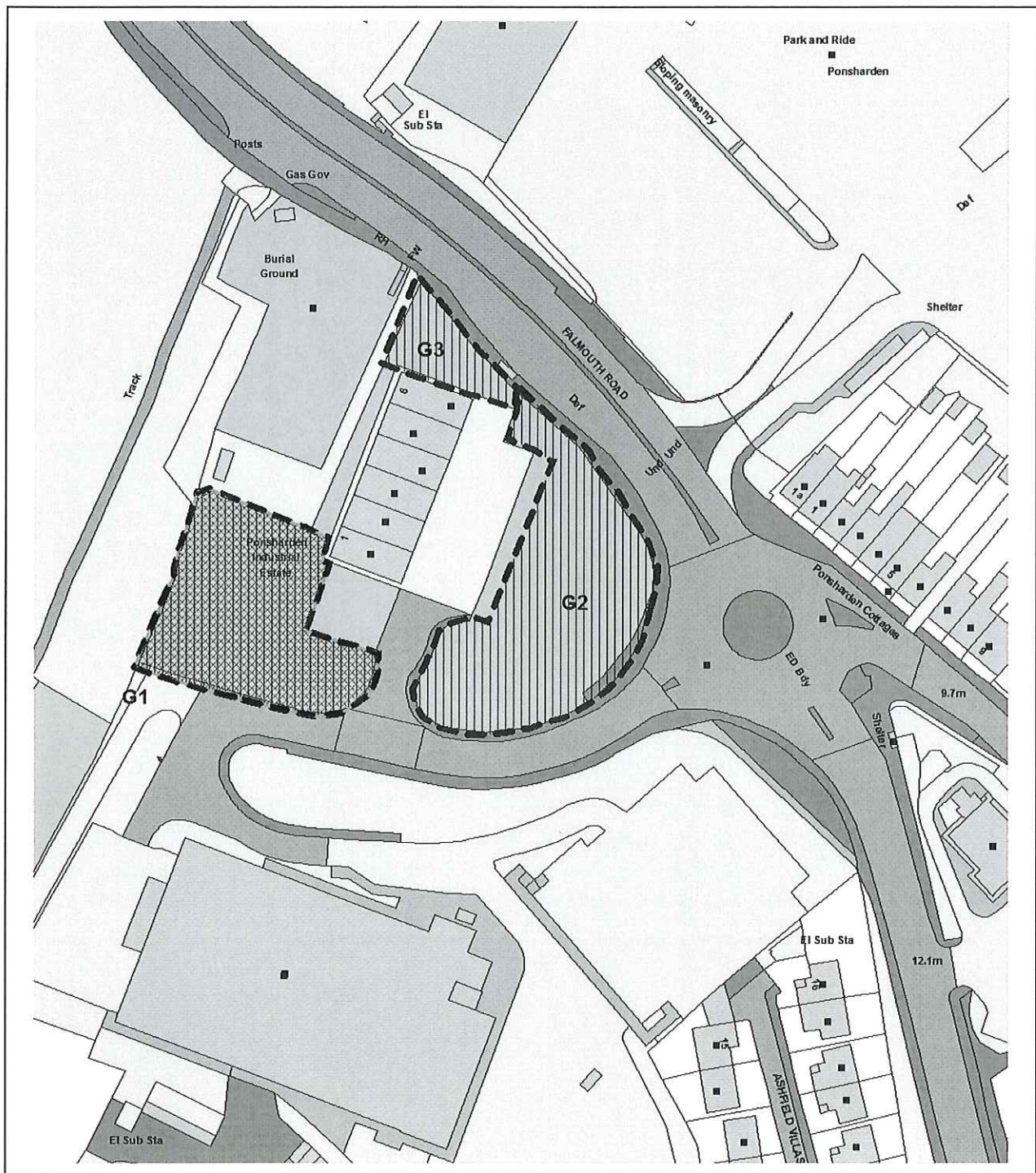

Grid Reference :179451 33787

Based on the Ordnance Survey mapping with the permission of the Controller of her Majesty's Stationery Office © Crown Copyright. Cornwall Council 100049047 Year 2012

Date: 31st July 2018

MODIFIED SCHEDULE

SPECIFICATION OF TREES

Trees specified individually (encircled in black on the map)

<u>Reference on Map</u>	<u>Description</u>	<u>Situation</u>
None	N/A	N/A

Trees specified by reference to an area (within a dotted black line on the map)

<u>Reference on Map</u>	<u>Description</u>	<u>Situation</u>
None	N/A	N/A

Groups of Trees (within a broken black line on the map)

<u>Reference on Map</u>	<u>Description</u>	<u>Situation</u>
G1	7 London Plane, 1 Corsican Pine, 1 Scots Pine, 2 Willow, 3 Beech, 1 Oak, 13 Sycamores	In the position identified on the map within the broken black line
G2	5 Limes, 15 Beech, 2 Maple, 1 Sycamore, 1 Horse Chestnut	"
G3	5 Beech, 1 Pine	"

Woodlands

(within a continuous black line on the map)

<u>Reference on Map</u>	<u>Description</u>	<u>Situation</u>
None	N/A	N/A

CORNWALL COUNCIL

Ponsharden Industrial Estate Falmouth Tree Preservation Order 2018

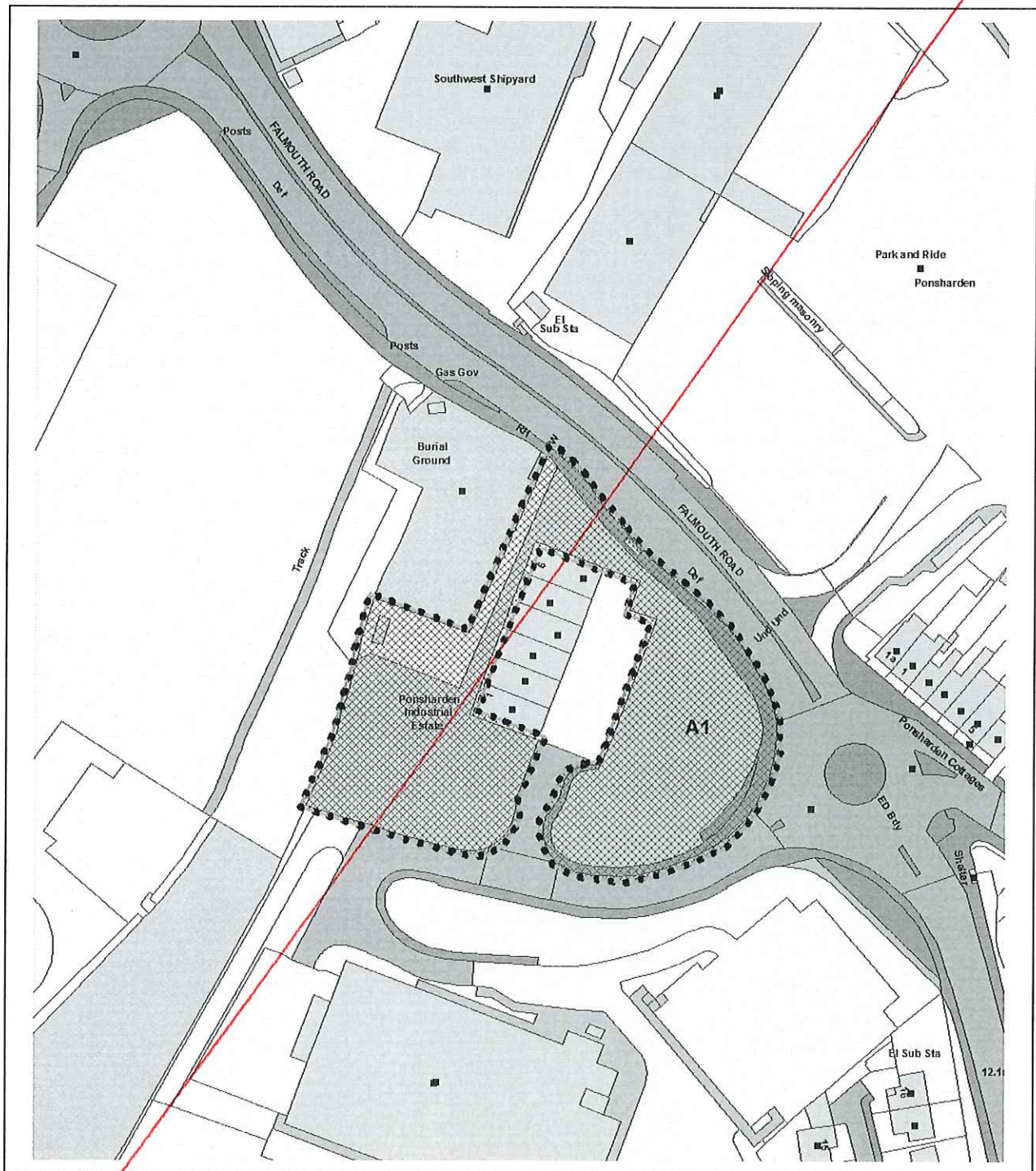

Grid Reference :179483 33809

Based on the Ordnance Survey mapping with the permission of the Controller of her Majesty's Stationery Office © Crown Copyright. Cornwall Council 100049047 Year 2012

Date: 6th February 2018

Anne Brown.

SCHEDULE

SPECIFICATION OF TREES

Trees specified individually (encircled in black on the map)

<u>Reference on Map</u>	<u>Description</u>	<u>Situation</u>
None	N/A	N/A

Trees specified by reference to an area (within a dotted black line on the map)

<u>Reference on Map</u>	<u>Description</u>	<u>Situation</u>
A1	All trees of whatever species	In the position identified on the map within the dotted black line

Groups of Trees (within a broken black line on the map)

<u>Reference on Map</u>	<u>Description</u>	<u>Situation</u>
None	N/A	N/A

Woodlands

(within a continuous black line on the map)

<u>Reference on Map</u>	<u>Description</u>	<u>Situation</u>
None	N/A	N/A

