

Note : For full specification for detailing and workmanship, refer to supporting HSHAZ "Detail Specification" document.

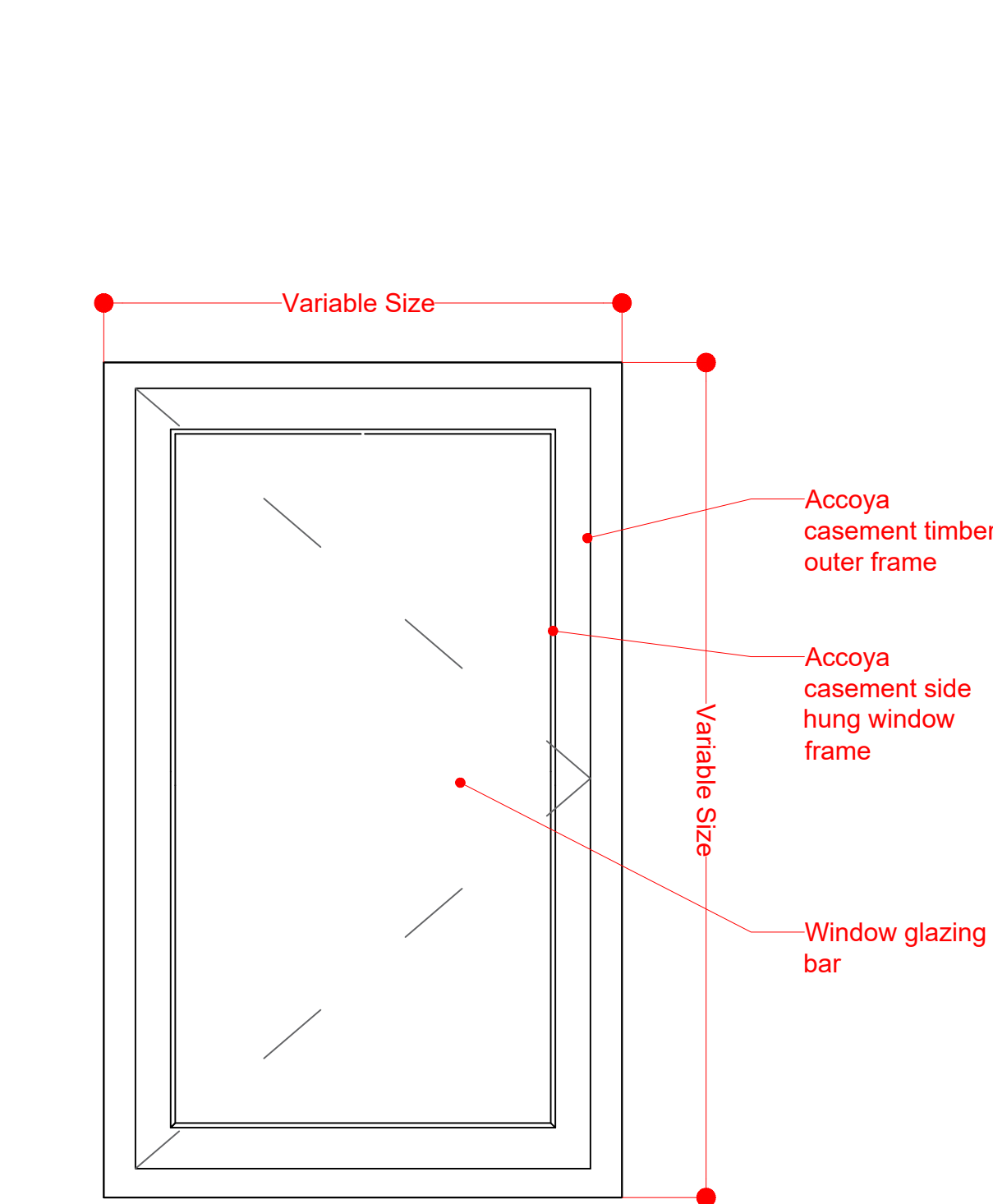

1 Casement Window Elevation  
Scale 1:10 @A3

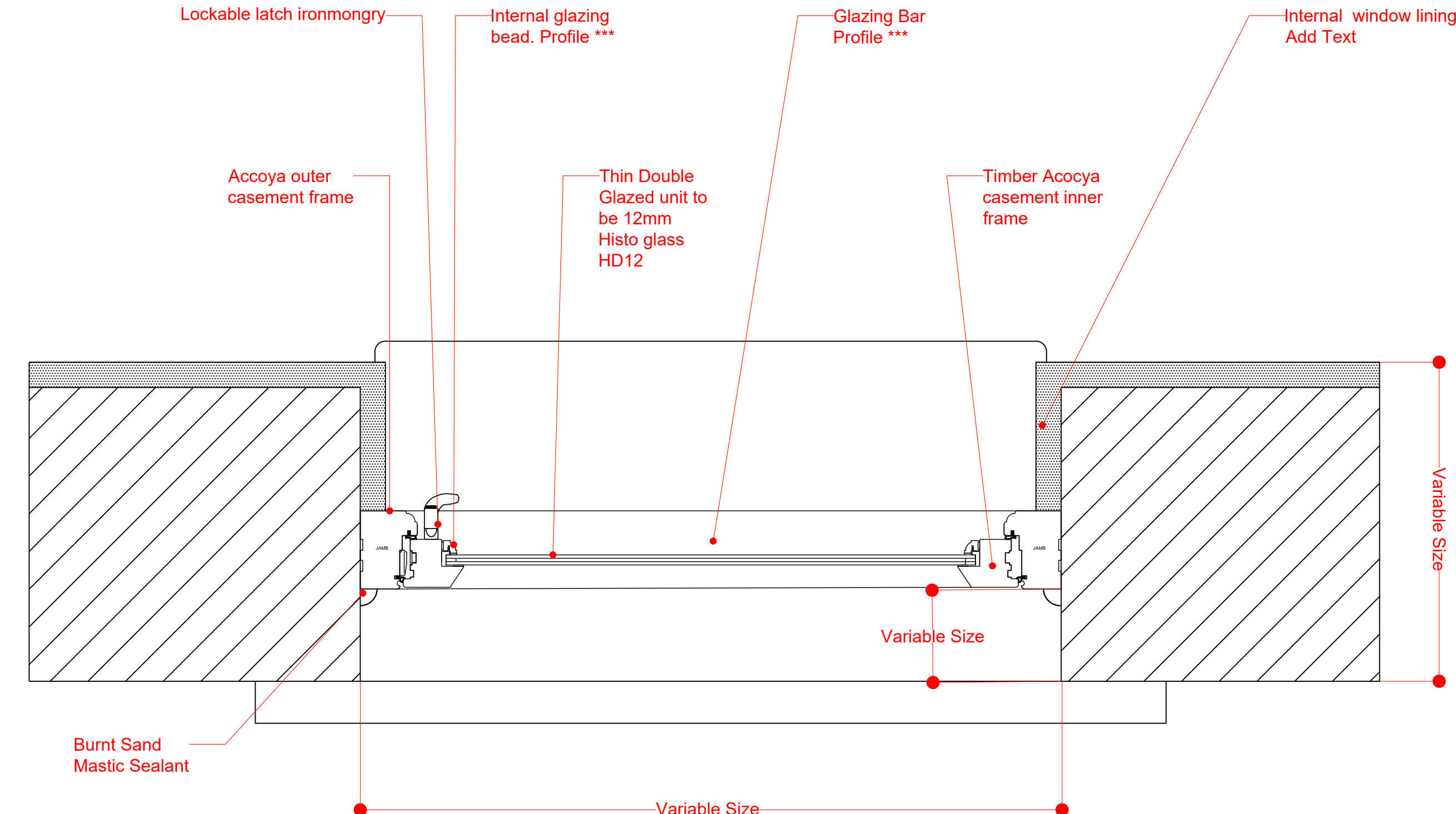

2 Casement Window Plan Detail  
Scale 1:5 @A3

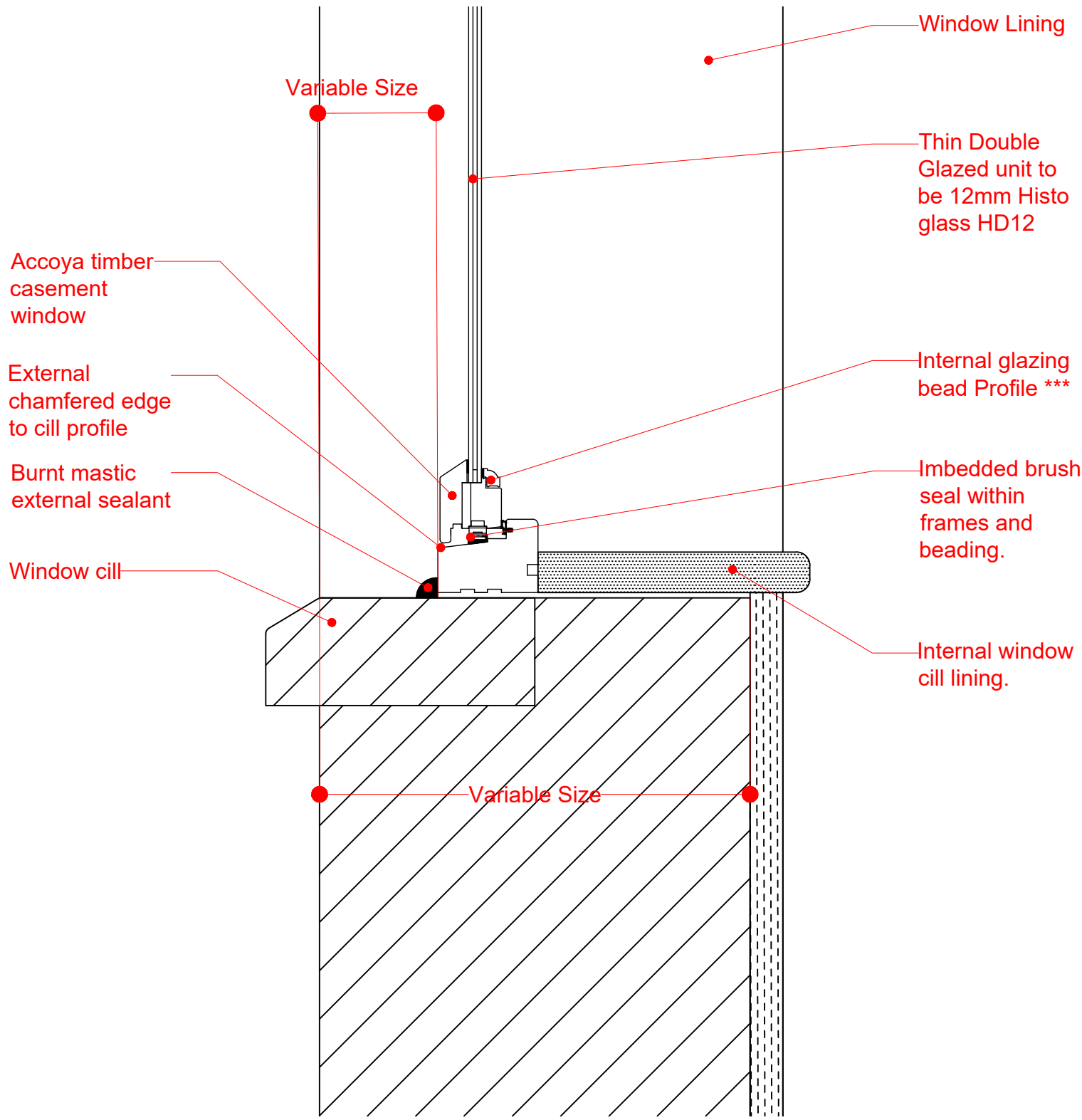

3 Casement Window Cill Detail  
Scale 1:5 @A3

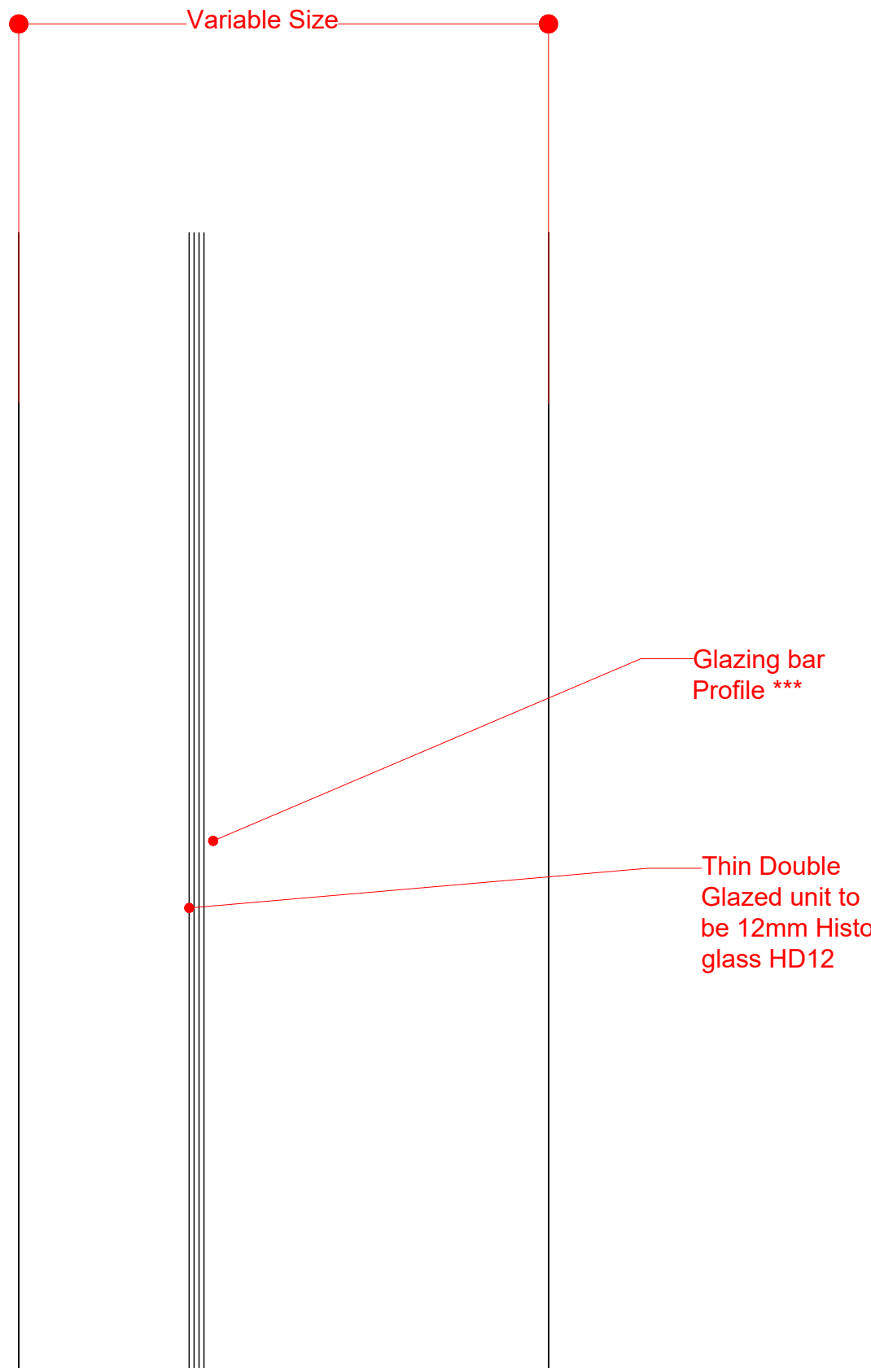

4 Casement Window Glazing Bead Detail  
Scale 1:5 @A3

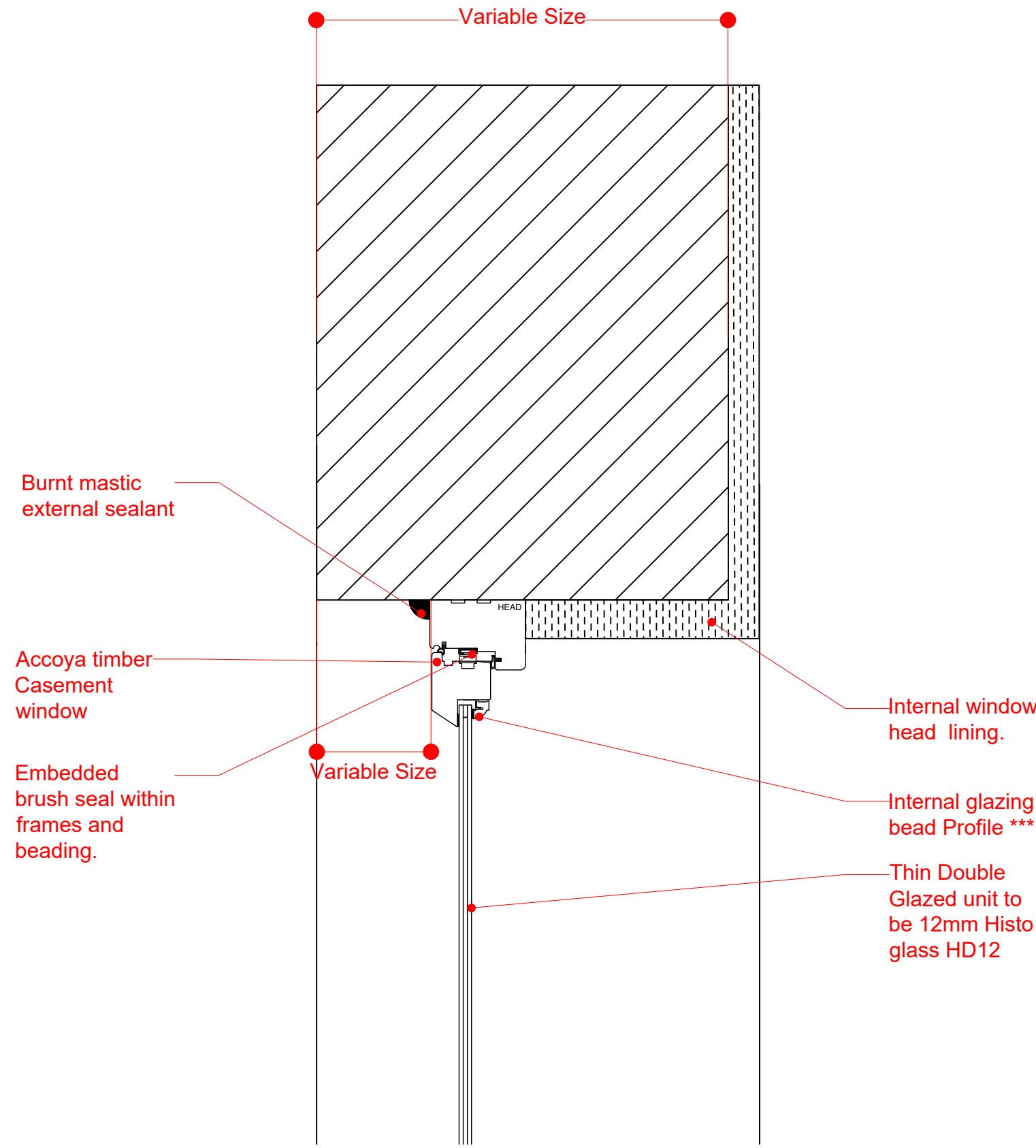

5 Casement Window Head Detail  
Scale 1:5 @A3

Rev 11/12/2020 Tender Review  
LB

Rev Date/Ints Details

© The moral rights of the author are hereby asserted.  
This drawing and design is the sole property of Buttress Ltd and must not be reproduced without permission.  
Buttress Ltd is Registered in England and Wales: 368372.

## Buttress

41, Bengal St  
Manchester  
M4 6AF

T 0161 236 3303  
E contact@buttress.net  
W www.buttress.net

Project Title	Bacup Derelict Buildings		
Client	Rossendale Borough Council		
Location	Bacup		
Drawing Title	Casement Window Type - Ultra Thin Double Glazed Detail Drawings		
Date	10/12/2020	Scale	1:10 & 1:5
Checked	KC	Orig Paper Size	A1
Status <b>Tender</b>			
Drawing ref	Job No	Drawing No	Revision
8920		(31) 006	B