

Contractor must check all dimensions on site. All plan dimensions are to structural faces unless otherwise stated.
Only figured dimensions are to be worked from. Discrepancies must be reported immediately to the Architect before
proceeding. Drawings supplied for purposes of obtaining planning permission must not be used for
construction/ender purposes
© Copyright.

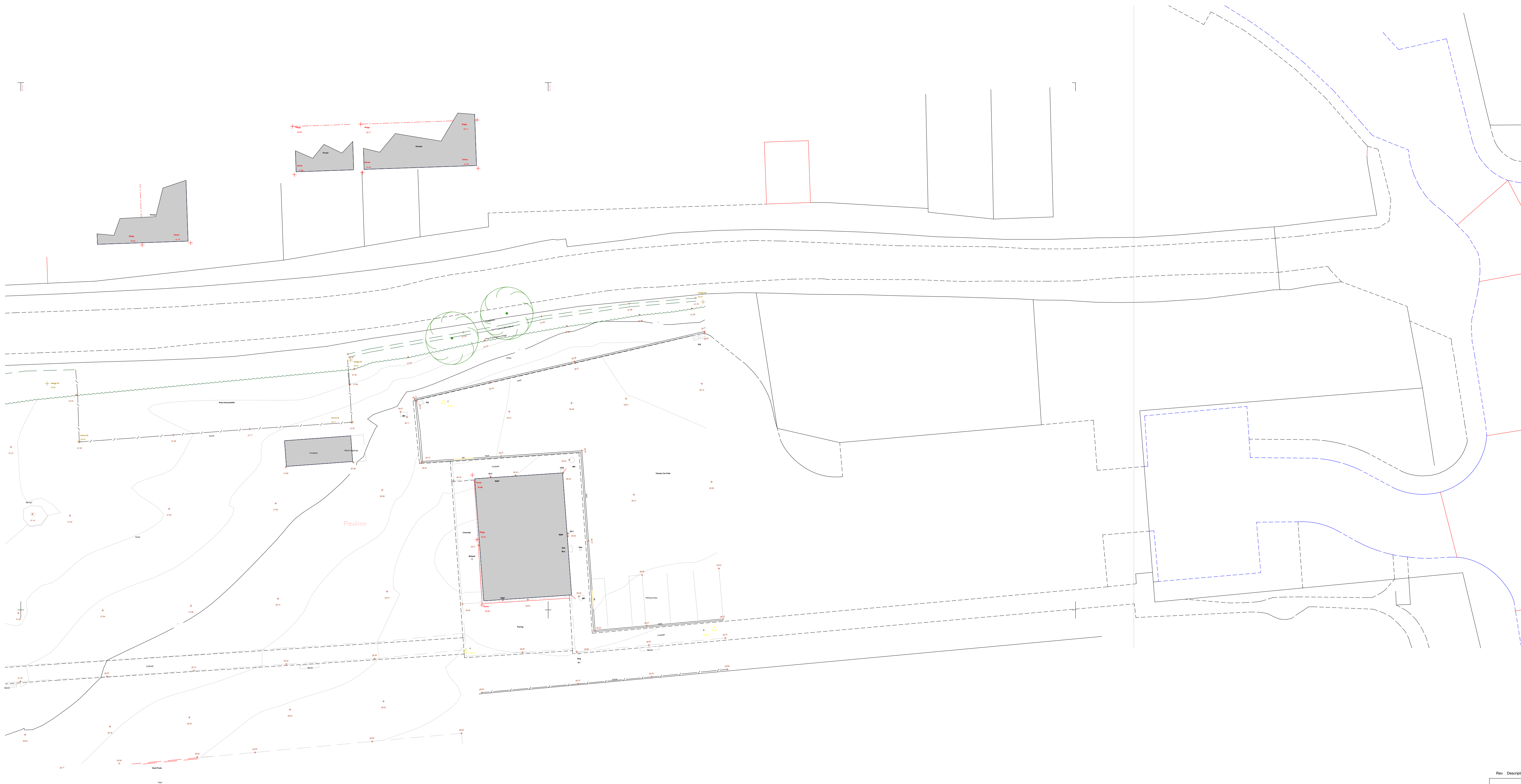

Paper Size: A1

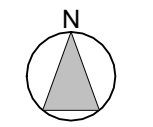

00 Existing Site Plan
1 : 200

Rev	Description	Date	(Ses)
 WOODWARD SMITH CHARTERED ARCHITECTS			
www.woodward-smith.co.uk			
Proposed Queen Elizabeth II Community Pavilion Tews Lane Playing Field			
Existing Site Plan			
F175 24 203			