

Brixham College-Classroom AV Tender



THINKING SCHOOLS
ACADEMY TRUST

OPERATIONS DEPARTMENT

Contents

INTRODUCTION	1
Tender Conditions	1
Timetable	1
Submission of Tender Responses	1
Tender Evaluation Criteria	2
Requirements	3
INDIVIDUAL CLASSROOM REQUIREMENTS	1
SITE PLAN	5
APPENDIX 1 – DECLARATION OF NON-COLLUSION	6

Introduction

The Thinking Schools Academy Trust ("TSAT" or the "Trust") are looking to appoint a partner to supply and install 74 new Interactive Display Panels within classrooms at Brixham College (Higher Ranscombe Road, Brixham, TQ5 9HF).

The installation of the new interactive display panels will need to be installed during a school holiday and completed within a single school holiday, although access to the site will be arranged for weekend working to allow the project to be completed within a two-week period. Access arrangements outside of standard school working hours (8am – 4pm) can be arranged in advance and the school will consider requests for contractors to be issued with keys and an alarm fob to continue works outside of these hours.

Depending on whether equipment is in stock and can be delivered, the school requires the project to be delivered between Saturday 1st April 2023 and Friday 14th April 2023.

Tender Conditions

In order for the bidders' tenders to receive proper consideration, it is important that the tender evaluation criteria requirements are met. Failure to meet any of the requirements may result in disqualification from the tendering process.

Timetable

Event	Completion Date
ITT issued	27 th January 2023
Deadline for clarification questions (before 12:00 noon)	3 rd February 2023
Deadline for submitting electronic tender response (before 12:00 noon)	28 th February 2023
Appointment of Preferred Bidder, unsuccessful Bidders informed	1 st March 2023
Acetal (Standstill)	13 th March 2023
Order raised with preferred bidder	14 th March 2023

Submission of Tender Responses

All ITT responses are to be submitted electronically by email to Steve Griffiths (Service Operations Manager) by using the email address: its-procurement@tsatrust.org.uk

Note: other recipients must not be included on the tender submission email. Email submissions must be 10Mb or less in size (submissions can be split into multiple emails clearly stating part numbers and total number of parts on each email, if required).

Tender Evaluation Criteria

Tenders will first be evaluated against the following requirements which will be scored on a pass/fail basis. Any tender that scores "Fail" against any of these requirements may be deemed non-compliant and rejected without further evaluation.

- Provision of Declaration of Non-Collusion at Appendix 1;

The successful tenderer will be selected based on an evaluation using the criteria set out below which align to the required headings for the proposal as set out above:

Criteria	Summary	Scoring
Price (70%)	Total cost of supply & installation of required equipment	$70 \times (\text{Lowest Tender Price}) \div (\text{Tenderer X's Price})$
Accuracy & Deliverability (15%)	Accuracy of the tender response compared against the Trust's requirements and delivery of all items by the dates specified in the requirements below	0-5 x 3 (Max 15) (see table below)
Quality (15%)	Additional information included within tender response to outline recommended changes to the Trust's requirements, or to justify differences between tender response and requirements	0-5 x 3 (Max 15) (see table below)

Tenderer's scores for each criterion will then be added together to produce an overall score and the tenderer with the highest overall score will be awarded the contract. Rejected or eliminated tenders will not be scored.

Quality Scoring	
0	The tenderer has given no response and/or the response is not acceptable and/or does not cover the relevant heading/s.
1	There are major weaknesses or gaps in the information provided. There are serious concerns about the tenderer's experience and capability.
2	The proposal is vague in parts with little or no detail given of how the tenderer will meet the criteria. Information provided is considered weak or inappropriate and is unclear on how this relates to our requirements or the outputs/outcomes of the project.
3	The proposal has addressed the majority of our requirements but lacks some clarity or detail in how the proposed solutions will be achieved. While evidence provided, gives generic or general statements, it is not specifically directed toward the requirements or the outcomes/outputs of this project.
4	The proposal has addressed, in some detail, all or the majority of our requirements. Evidence has been provided that shows not only what will be provided but gives some detail of how this will be achieved. It is clear how the proposal relates directly to the aims of the project and are specific, rather than general, in the way proposed solutions will deliver the desired outcomes and outputs.
5	As well as addressing all of our requirements the tenderer demonstrates a deep understanding of the project and/or presents innovative ideas (where appropriate). Proposal links directly to the relevant project requirements, outcomes and outputs (as the case may be) and show how they will be delivered and the impact that they will have on other areas/stakeholders.

Requirements

Brixham College are looking to appoint a partner to install a new interactive display panel, amplifier, speakers and AV faceplate in up to 74 classrooms, with most being wall mounted but a number will standalone and require trolleys.

Bidders do not need to allow for the installation of power. Each room will have either a 13amp fused spur or 13amp switched double socket, available at the time of installation.

The specification of the new equipment can be found below:

The interactive display panel must:

- Provide a minimum screen size of 75";
- Support 4k display;
- Have a minimum of 10 touch points;
- Have toughened glass, at least 4mm thick;
- Be capable of being connected to the school's network via a wired connection;

The AV faceplate must:

- Support being installed within a double gang back box
- Use a modular approach for adding additional components
- Provide a minimum of 1x HDMI, 1x USB, 1x VGA with 5 Meter cable kit to the new display panel
- Allow for the amplifier to be installed within faceplate

The amplifier must:

- Support being installed with the specified AV faceplate
- Be capable of delivering required output to specified speakers
- Allow for a minimum of two audio input sources
- Provide a volume dial control with on/off control

The speaker must:

- Delivery a minimum of 50W RMS at 8 ohms
- Support being installed on a wall mount

A summary of these requirements is shown in the table below

Item	Quantity
Interactive Display Panel	74
AV Cable Looms with mounted faceplate (Minimum of 1x HDMI, 1x USB, 1x VGA)	Please see individual classroom requirements below for length
Heavy duty wall mounts (Must include patress for rooms requiring extended mount)	Please see individual classroom requirements below for wall type & appropriate fixing
Amplifier & wall mounted speakers (2 speakers per classroom)	74
Motorised mobile trolley	2

Photographs of all classrooms can be found in the appendix and site surveys can be arranged upon request between 30th January - 3rd February 2023.

The bidder's response must include the removal of existing equipment and WEEE disposal and for the removal & recycling of all packaging of new equipment.

The Trust reserves the right to amend the number of classrooms, requiring interactive display panels, at the point of order, pending final costs and funding available, though this is unlikely to be beyond a 10% change.

Individual classroom requirements

Classroom ref*	Block	Floor	Wall Type (Brick/Plasterboard)	Installation Type (Wall Mounted/Mobile Trolley)	Cable Kit (5 Meter/10M+)	Current Cable Route (Surface mounted trunking / under floor / in ceiling)	Required Route
E1	Main	G	Plasterboard	Wall Mounted	5m	Under floor cabling from PC and Ceiling Dock	To bypass the dock
E2	Main	G	Plasterboard	Wall Mounted	5m	Under floor cabling from PC and Ceiling Dock	To bypass the dock
E3	Main	G	Plasterboard	Wall Mounted	5m	Under floor cabling from PC and Ceiling Dock	To bypass the dock
E4	Main	G	Plasterboard	Wall Mounted	5m	Under floor cabling from PC and Ceiling Dock	To bypass the dock
M1	Main	G	Plasterboard	Wall Mounted	5m	Wall trunking with dock	To bypass the dock
M2	Main	G	Plasterboard	Wall Mounted	5m	Wall trunking with dock	To bypass the dock
M3	Main	G	Plasterboard	Wall Mounted	5m	Wall trunking with dock	To bypass the dock
M4	Main	G	Plasterboard	Wall Mounted	5m	Wall trunking with dock	To bypass the dock
M5	Main	G	Plasterboard	Wall Mounted	5m	Wall trunking with dock	To bypass the dock
M6	Main	G	Plasterboard	Wall Mounted	5m	Wall trunking with dock	To bypass the dock
M7	Main	G	Plasterboard	Wall Mounted	5m	Wall trunking with dock	To bypass the dock
M8	Main	G	Plasterboard	Wall Mounted	10m	Wall trunking with dock	To bypass the dock
M9	Main	G	Brick	Wall Mounted	5m	Wall trunking	
BS1	Main	G	Brick	Wall Mounted	5m	Wall trunking	
BS2	Main	G	Plasterboard	Wall Mounted	5m	Wall trunking	
MU1	Main	G	Plasterboard	Wall Mounted	5m	Wall trunking	
6 th Form	Main	G	Plasterboard	Wall Mounted	5m	Wall surface mounted trunking	
TE1	Main	G	Brick	Wall Mounted	5m	Wall trunking with dock	
TE2	Main	G	Brick	Wall Mounted	5m	Wall trunking with dock	To bypass the dock
F1	Main	G	Plasterboard	Wall Mounted	5m	Wall trunking	
F2 –	Main	G	Plasterboard	Trolley	No cable loom, cables to be installed in sock and not terminated into fixed AV plate	Motorised mobile trolley	
F3	Main	G	Plasterboard	Wall Mounted	5m	Wall trunking	
ICT Healthy Living	Main	G	Plasterboard	Wall Mounted	5m	Wall trunking and ceiling cabling	

HS1	OUTSIDE HUT	G	Plasterboard	Trolley	No cable loom, cables to be installed in sock and not terminated into fixed AV plate	Wall trunking	
ST1	Lighthouse	G	Brick	Wall Mounted	10m	Ceiling cabling with dock	To bypass the dock
ST2	Lighthouse	G	Plasterboard	Wall Mounted	10m	Ceiling cabling with dock	To bypass the dock
ST3	Lighthouse	G	Brick	Wall Mounted	10m	Wall trunking with dock	To bypass the dock
E5	Main/English Block	1	Plasterboard	Wall Mounted	5m	Under floor cabling from PC and Ceiling Dock	To bypass the dock
E6	Main/English Block	1	Plasterboard	Wall Mounted	5m	Under floor cabling from PC and Ceiling Dock	To bypass the dock
E7	Main/English Block	1	Plasterboard	Wall Mounted	5m	Under floor cabling from PC and Ceiling Dock	To bypass the dock
E8	Main/English Block	1	Plasterboard	Wall Mounted	5m	Under floor cabling from PC and Ceiling Dock	To bypass the dock
E9	Main/English Block	1	Plasterboard	Wall Mounted	5m	Wall Trunking and Ceiling Dock	To bypass the dock
B1	Main	1	Plasterboard	Wall Mounted	10m	Wall Trunking and Ceiling Dock	To bypass the dock
B2	Main	1	Brick	Wall Mounted	10m	Wall Trunking	
B3	Main	1	Brick	Wall Mounted	10m	Wall Trunking	
B4	Main	1	Plasterboard	Wall Mounted	10m	Under floor cabling from PC and Ceiling Dock	To bypass the dock
B5	Main	1	Brick	Wall Mounted	10m	Under floor cabling from PC and Ceiling Dock	To bypass the dock
B6	Main	1	Brick	Wall Mounted	10m	Under floor cabling from PC and Ceiling Dock	To bypass the dock
B7	Main	1	Plasterboard	Wall Mounted	10m	Under floor cabling from PC and Ceiling Dock	To bypass the dock
B8	Main	1	Plasterboard	Wall Mounted	10m	Under floor cabling from PC and Ceiling Dock	To bypass the dock
B9	Main	1	Brick	Wall Mounted	5m	Wall trunking and ceiling dock	To bypass the dock
C1	Main	2	Plasterboard	Wall Mounted	10m	Wall Trunking	
C2	Main	2	Brick	Wall Mounted	5m	Wall Trunking	
C4	Main	2	Brick	Wall Mounted	5m	Wall Trunking	
ICT1 / C5	Main	2	Brick	Wall Mounted	5m	Cabling through trunking on desk	
C6	Main	2	Brick	Wall Mounted	5m	Wall Trunking	
ICT2 / C7	Main	2	Brick	Wall Mounted	5m	Cabling through trunking on desk	
C8	Main	2	Brick	Wall Mounted	5m	Wall Trunking	

C9	Main	2	Brick	Wall Mounted	10m	Wall Trunking	
C10	Main	2	Brick	Wall Mounted	10m	Wall Trunking with dock	To bypass the dock
C11	Main	2	Brick	Wall Mounted	10m	Wall Trunking with ceiling dock	To bypass the dock
C12	Main	2	Brick	Wall Mounted	5m	Wall trunking with ceiling dock	To bypass the dock
C13	Main	2	Brick	Wall Mounted	10m	Trunking with ceiling cabling	To bypass the dock
C14	Main	2	Brick	Wall Mounted	5m	Wall Trunking with ceiling dock	To bypass the dock
C15	Main	2	Brick	Wall Mounted	5m	Wall Trunking with ceiling dock	To bypass the dock
C20	Main	2	Brick	Wall Mounted	5m	Wall Trucking with ceiling dock	To bypass the dock
PE1	Sports Hall	1	Brick	Wall Mounted	5m	Wall Trunking	
PiP Intervention	Main	G	Brick	Wall Mounted	10m	Wall trunking with ceiling cabling	To bypass the dock
Pastoral Room	Main	G	Brick	Wall Mounted	5m	Wall trunking	
Principal Office	Main	G	Brick	Wall Mounted	5m	Wall trunking	
CPD Room	Main	G	Brick	Wall Mounted	5m	Wall trunking	
TSAT Board Room	Main	G	Brick	Wall Mounted	5m	Wall trunking	
Sixth Form Creative Media Classroom	Lighthouse	G	Brick	Wall Mounted	10m	Wall trunking with dock	To bypass the dock
Lighthouse Gallery	Lighthouse	G	Plasterboard	Wall Mounted	10m	Wall Trunking	
Sixth Form Art Classroom	Sixth Form	G	Plasterboard	Wall Mounted	10m	Wall trunking and ceiling cabling	
ELZ Classroom	Main	1	Plasterboard	Wall Mounted	10m	Wall trunking and ceiling cabling	
Intervention 1	Main	1	Plasterboard	Wall Mounted	5m	NO PC	
Intervention 3	Main	1	Plasterboard	Wall Mounted	5m	NO PC	
Learning Zone Room 1	Main	1	Brick	Wall Mounted	10m	Ceiling cabling	

Learning Zone Room 2	Main	1	Brick	Wall Mounted	5m	NO PC	
Harbour 1	Harbour	G	Brick	Wall Mounted	5m	Wall Trunking	
Harbour 2	Harbour	G	Plasterboard	Wall Mounted	5m	Wall Trunking	
Harbour 3	Harbour	G	Brick	Wall Mounted	5m	Wall Trunking	
Harbour 2	Harbour	G	Brick	Wall Mounted	5m	Wall Trunking	

*Photographs are to be named as per the classroom reference.

Room Plan

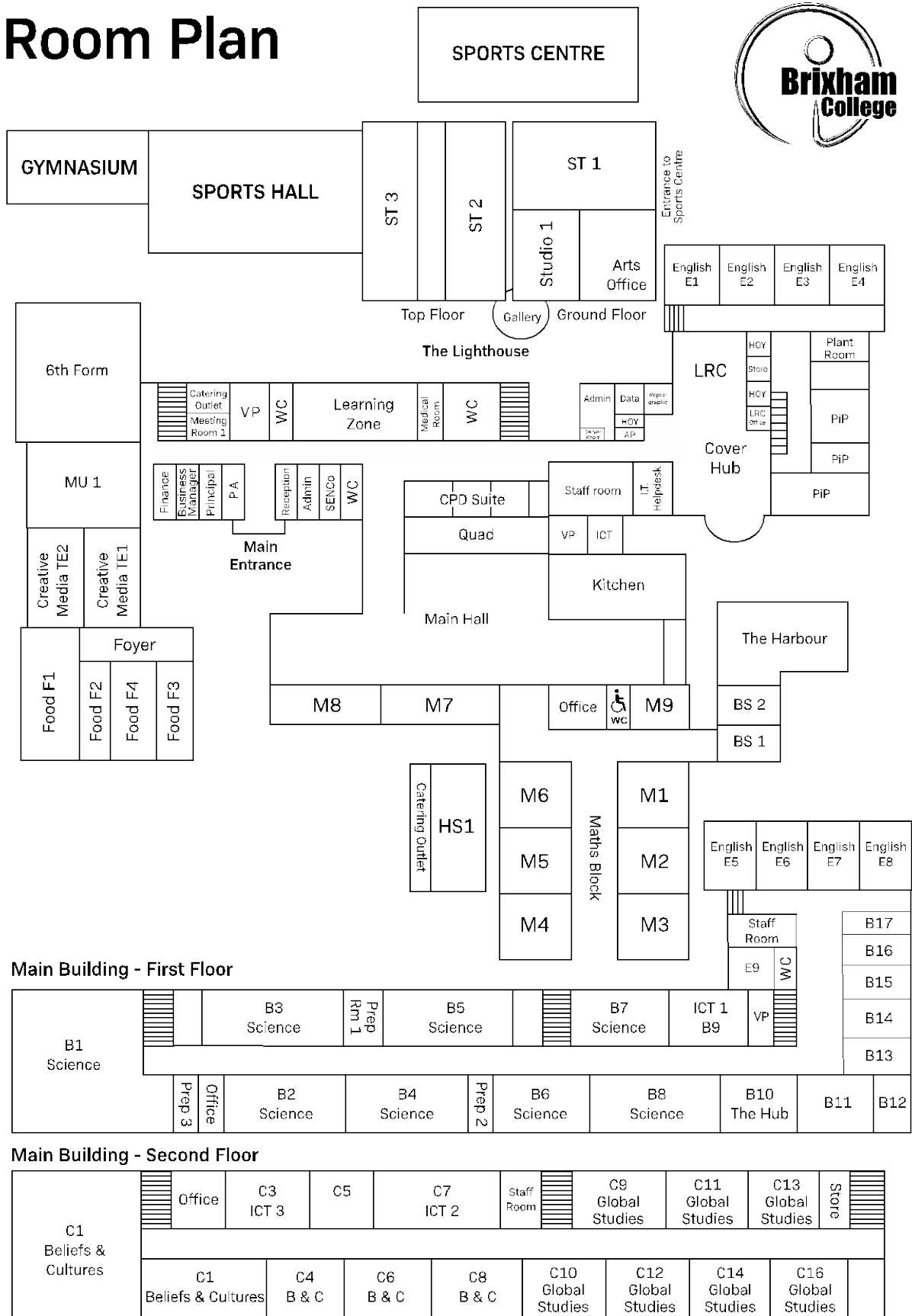

Appendix 1 – Declaration of Non-Collusion

To: The Thinking Schools Academy Trust

The essence of selective tendering is that the Authority shall receive bona fide competitive tenders from all firms tendering. In recognition of this principle, I/We certify that this is a bona fide tender, intended to be competitive and that I/we have not and will not (either personally or by anyone on my/our behalf):-

- Fix or adjust the amount of the tender (or the rate and prices quoted) by agreement with any other person.
- Communicate to anyone, other than the person calling for this tender, the amount or approximate amount or terms of the proposed tender (except other than in confidence, where essential to obtain professional advice or insurance premium quotations required for the preparation of the tender).
- Enter into any agreement or arrangement with any other person that he shall refrain from tendering or as to the amount or terms of any tenders to be submitted.
- Canvass or solicit any member, officer or other employee of the Authority in connection with the award of this or any other Authority contract or tender.
- Offer, give or agree to give any inducement or reward in respect of this or any other Authority contract or tender.
- Commit any offence under the Public Bodies Corrupt Practices Act 1889, Bribery Act 2010 or under Section 117 of the Local Government Act 1972.

Signed (as in Tenders) duly authorised to sign

For on behalf of Date

The Thinking Schools Academy Trust

The Thinking Schools Academy Trust, Park Crescent, Chatham, Kent, United Kingdom, ME4 6NR.
Company Limited by Guarantee Registered in England and Wales. Company Number: 07359755.

© Copyright The Thinking Schools Academy Trust, All Rights Reserved