

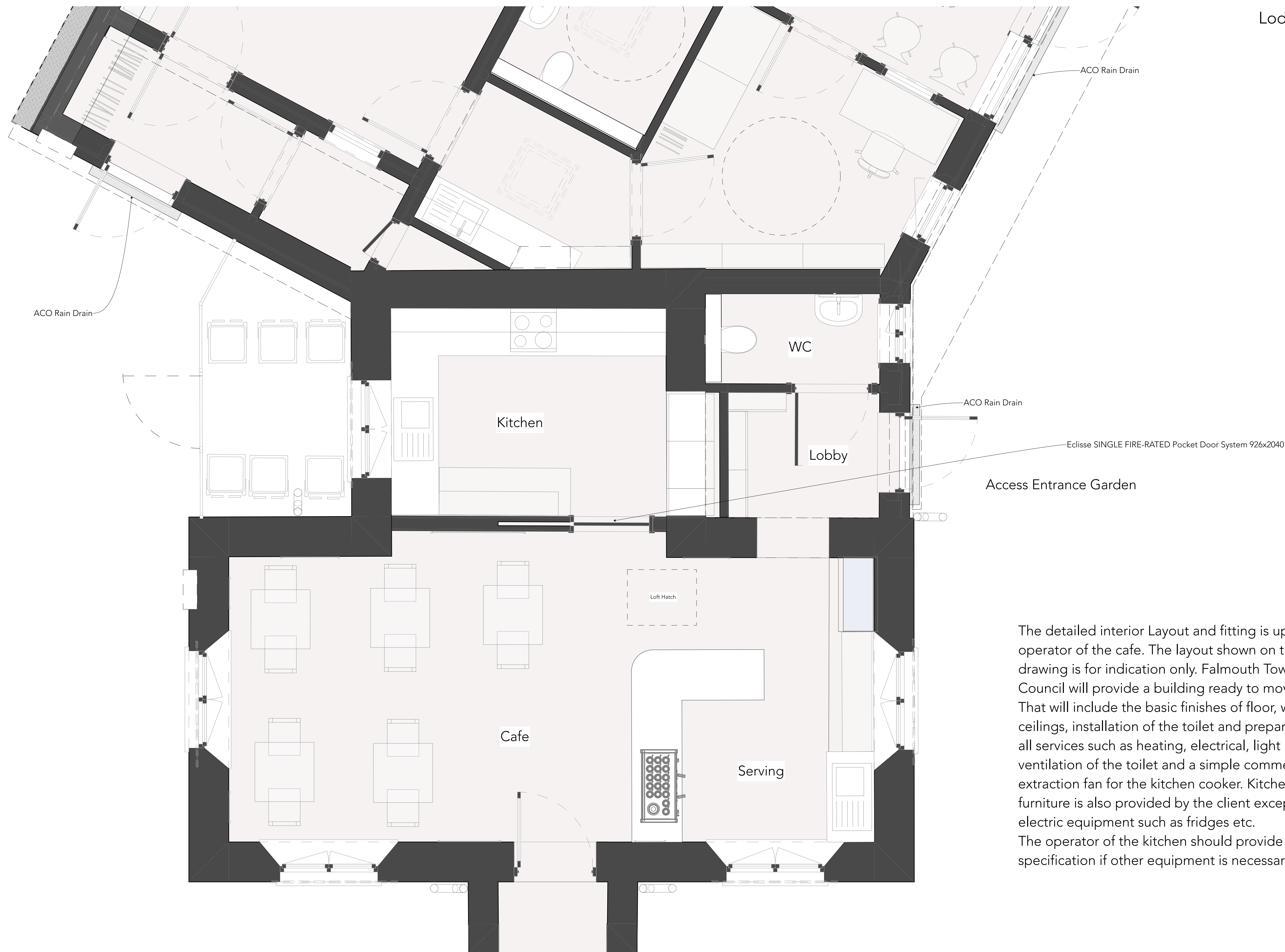

Lodge / Cafe



The detailed interior Layout and fitting is up to the operator of the cafe. The layout shown on the drawing is for indication only. Falmouth Town Council will provide a building ready to move in. That will include the basic finishes of floor, walls and ceilings, installation of the toilet and preparation of all services such as heating, electrical, light and the ventilation of the toilet and a simple commercial extraction fan for the kitchen cooker. Kitchen furniture is also provided by the client except for all electric equipment such as fridges etc. The operator of the kitchen should provide a specification if other equipment is necessary.

Original Access with a steps

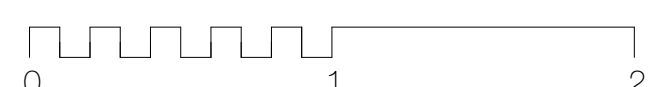

Design Risks & Hazards: Please inspect the site and study all drawings before any work is carried out. There are services around and pipes in the ground. Any work on an existing property should have an asbestos survey. The site is located within a park with many visitors.

This drawing is copyright to Horner Architects Limited and any use of the information requires written permission. Do not rely for construction purposes from this drawing and all dimensions are to be checked on site and any discrepancy, error or omission is to be reported to the architect. This drawing shall be void in the event of any alteration without written agreement and signature.

Rev	Date	By	Description

project
Kimberley Park Lodge, 33 Kimberley Park Rd,
Falmouth TR11 2DA
Kimberley Park Lodge

client
Falmouth Town Council

drawing
01-Existing, 06-Proposed

Ground Floor

Horner Architects
RIBA 

Technical Design First Draft			
scale 1:25	paper size A1-L	drawn MH	
project no. 0141.a	drawing no. 487	checked ###	date 25/03/2024