

2

Brief Development

2.4

Precedent Analysis - Existing Facilities

2.4.2

ICTEM

Similarly to the CRB study, the basement, ground, first, and third to seventh floors of ICTEM have not been considered in the analysis of the space allocation as all of these floors are occupied by Imperial College.

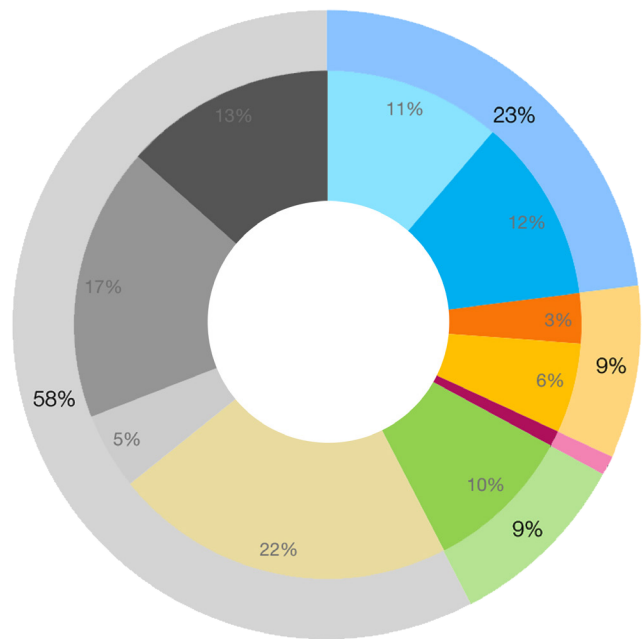
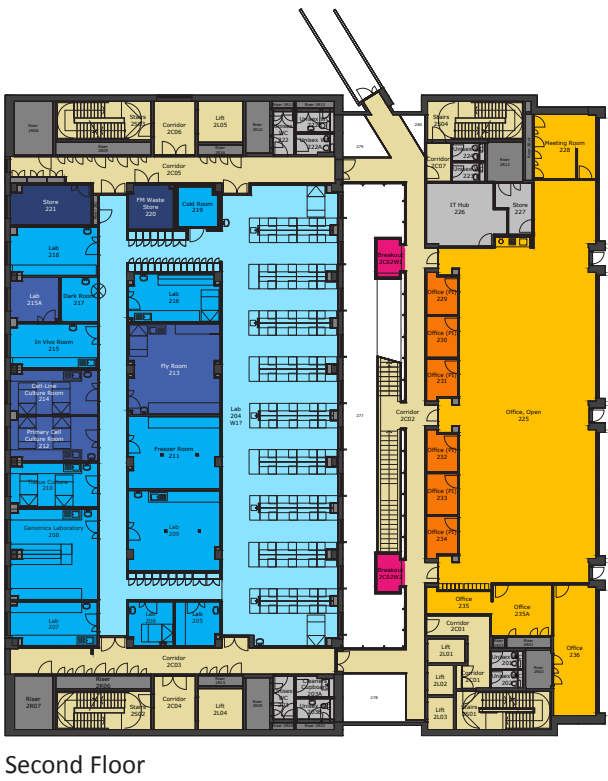

- Primary Laboratories
- Shared Secondary Laboratories
- Direct Secondary Laboratories
- Tertiary Space
- Cellular Office
- Shared Office
- Meeting Space
- Collaboration Space
- Social Space
- Specialist Teaching Space
- General Teaching Space
- Other - Specialist
- Circulation
- Balance
- Plant (inclu. roof plant)
- Engineering



ICTEM Building - Central linear atrium divides the laboratory and write-up spaces allowing natural light into the centre of the building



ICTEM Building - Linear laboratories look out onto the central feature stair

2

Brief Development

2.4

Precedent Analysis - Existing Facilities

2.4.3

Lab/ Write-Up Adjacencies & Accommodation Ratios

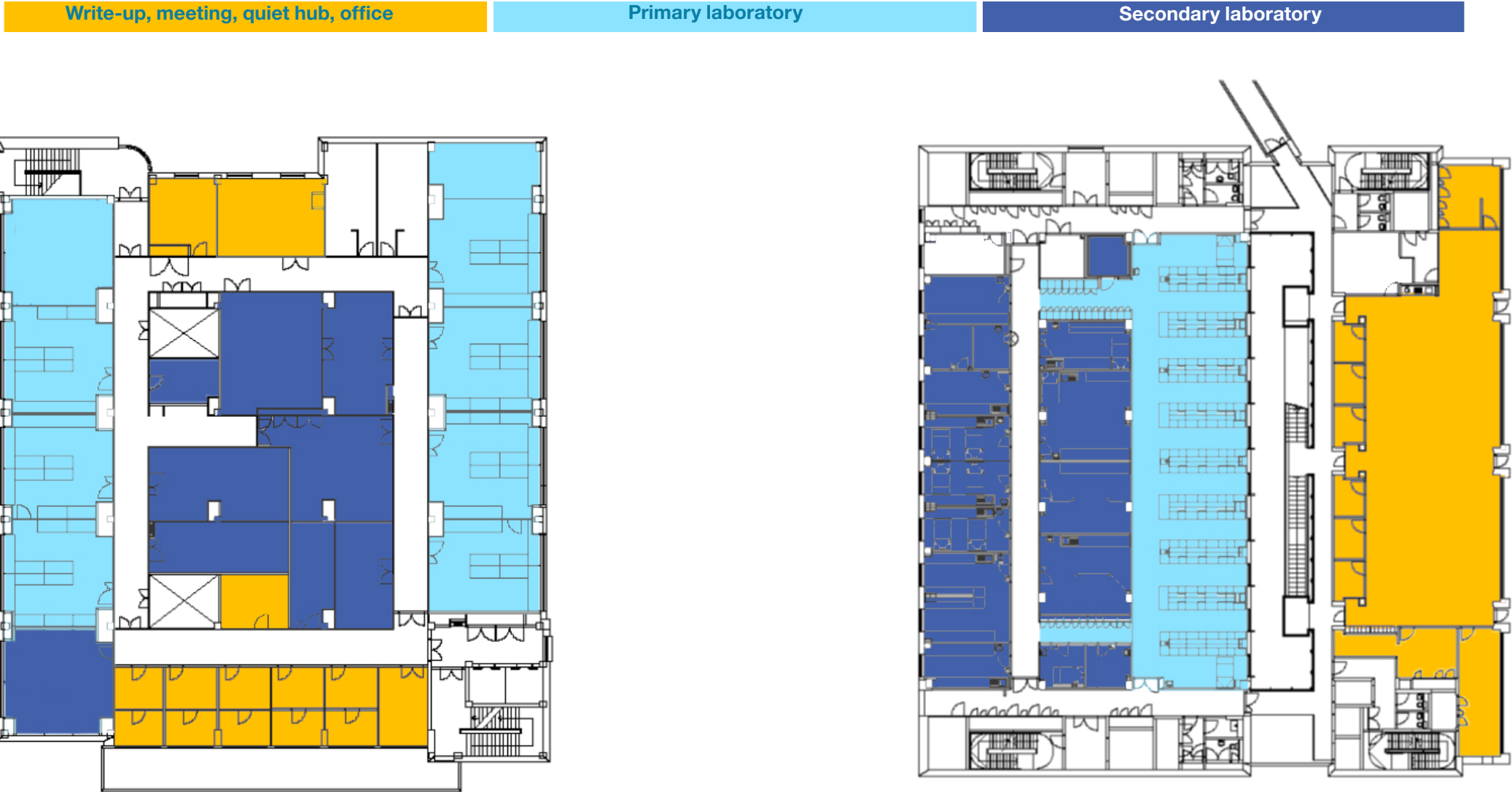

CRB

Dimensional Statistics		Area Distribution	
– Structural grid (mm):	6600	– Primary Labs:	28%
– Bench bay spacing:	3300	– Secondary Labs:	21%
– Aisle width:	1800	– Primary Office:	15%
– Wall bench depth:	750	– Tertiary:	3%
– Island bench depth:	1500	– Balance:	33%

ICTEM

Dimensional Statistics		Area Distribution	
– Structural grid (mm):	6800	– Primary Labs:	21%
– Bench bay spacing:	3400	– Secondary Labs:	19%
– Aisle width:	1600	– Primary Office:	19%
– Wall bench depth:	750	– Tertiary:	5%
– Island bench depth:	1500	– Balance:	36%