

As Existing  
Parapet Details  
Scale 1:10

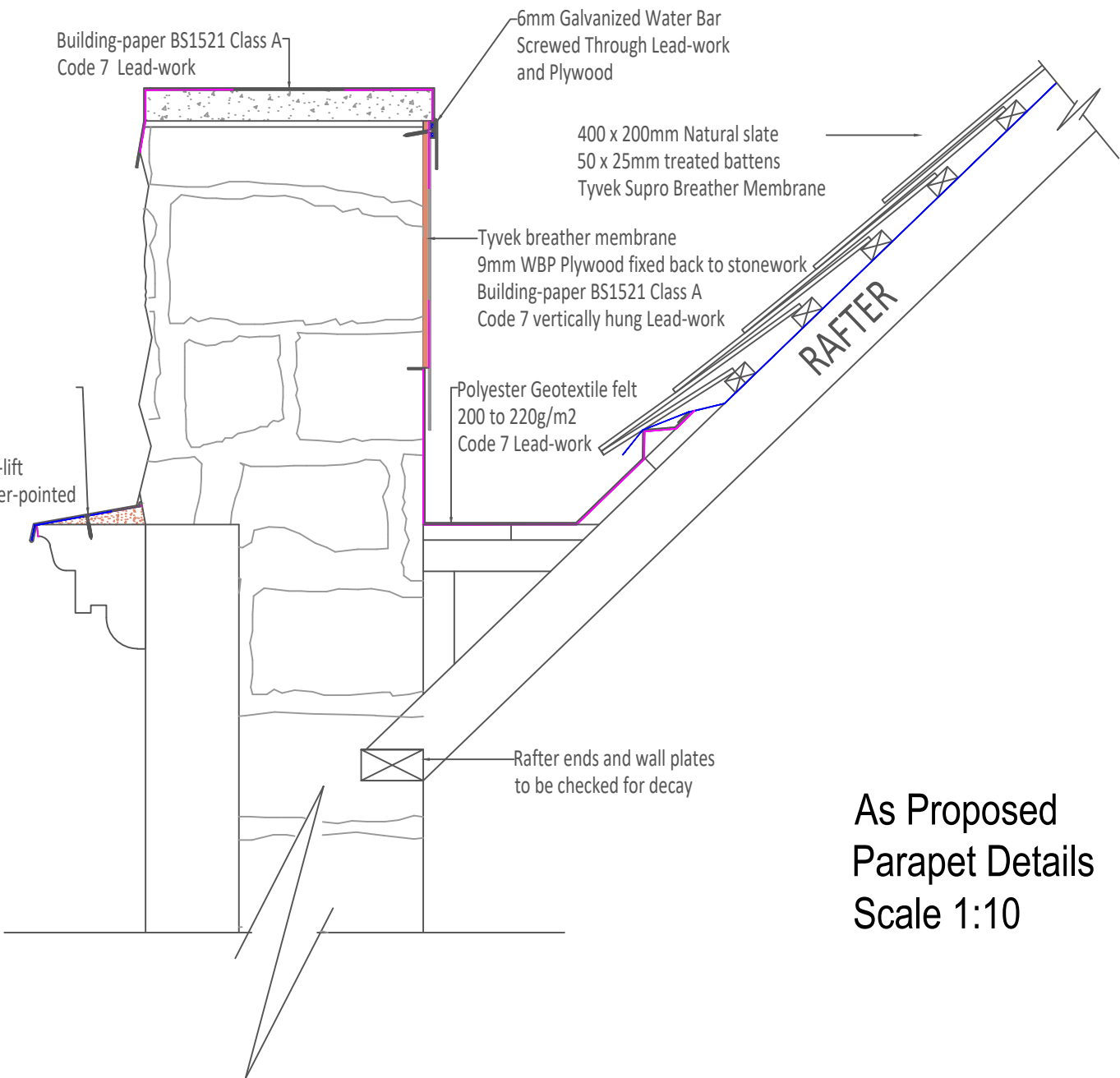

As Proposed  
Parapet Details  
Scale 1:10

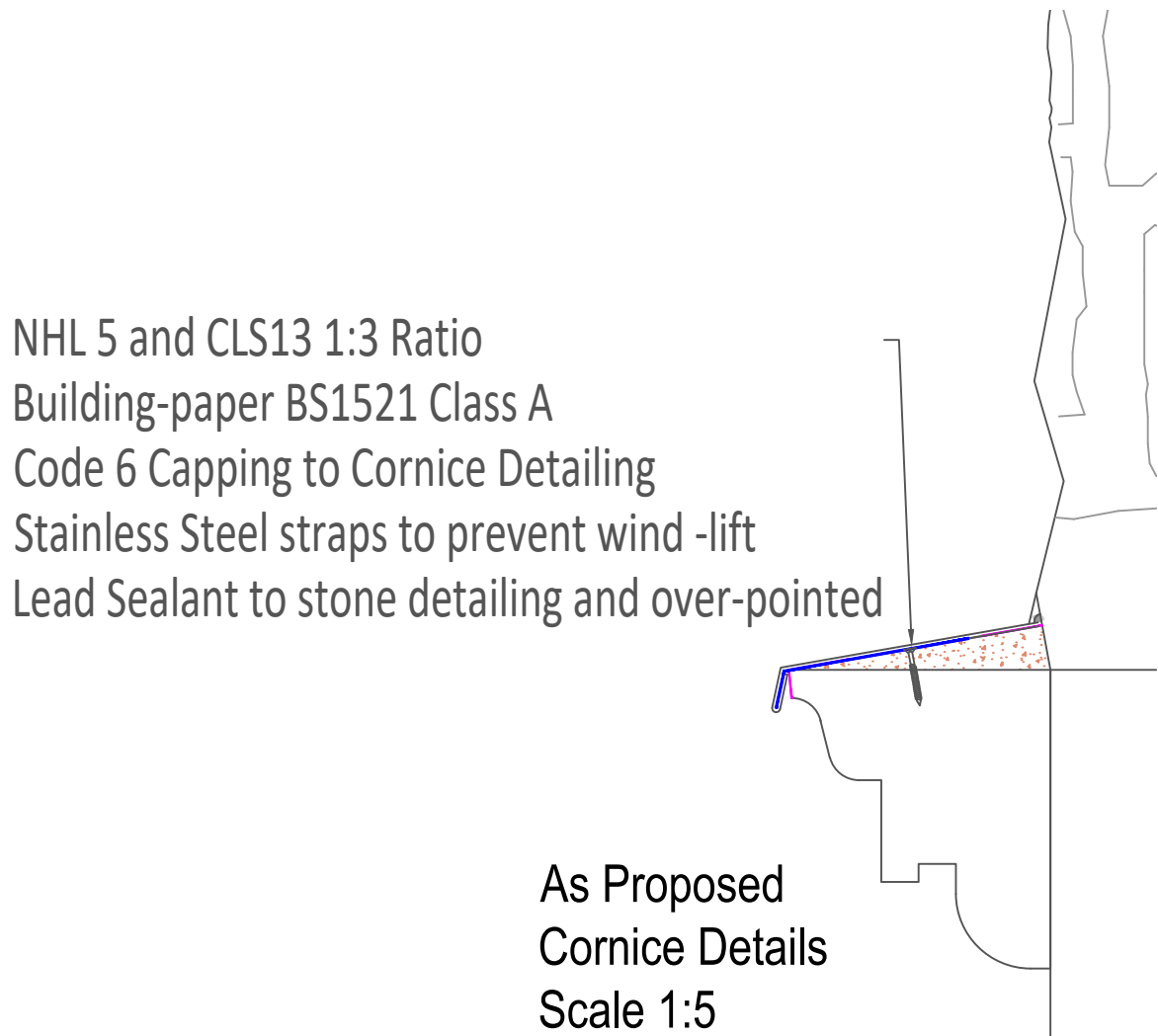

As Proposed  
Cornice Details  
Scale 1:5

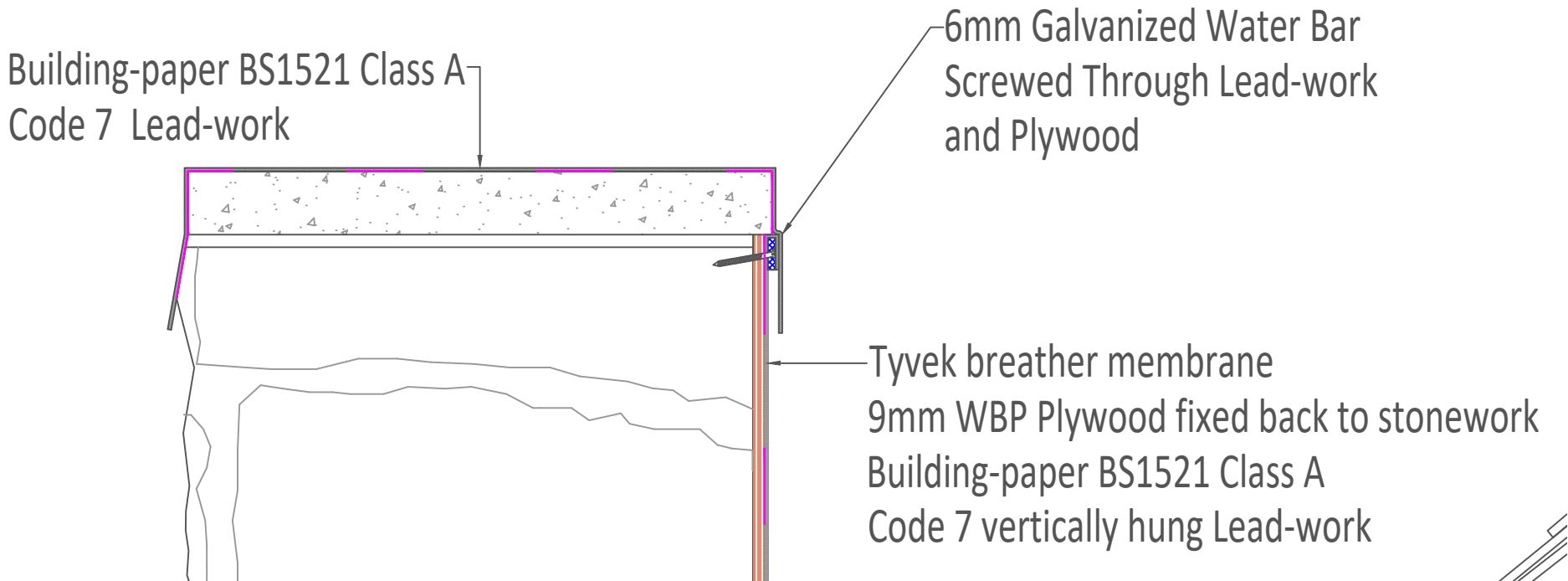

As Proposed  
Parapet Capping Details  
Scale 1:5

GENERAL NOTES

DRAFT

FOR DISCUSSION PURPOSES ONLY

REVISION	AMENDMENT	INITIAL	DATE

STATUS

☐

 Sketch Scheme

☐

 Planning

☐

 Building Regulations

☒

 Tender

☐

 Contract

☐

 As Built

PROJECT

Passmore Edwards Building  
Camborne Library  
The Cross, Cross Street  
Camborne TR14 Bha

CLIENT

Camborne Town Council  
Camborne Library

DRAWING TITLE

Parapet and Cornice  
Details

RTP

CHARTERED BUILDING SURVEYORS

RTP Surveyors  
9 Mount Folly Square  
Bodmin, Cornwall, PL31 2DF

T 01208 892020  
F 01208 269476  
E Bodmin@rtpsurveyors.co.uk  
www.rtpsurveyors.co.uk

Office also at Falmouth

This drawing is copyright. All materials and workmanship to comply with the current British Standards and codes of practice. Contractors to check ALL dimensions. Work from figured dimensions ONLY. Report ANY discrepancy to Architect or Surveyor before proceeding. IF IN ANY DOUBT ASK.