

SECTION A-A

Scale 1:20

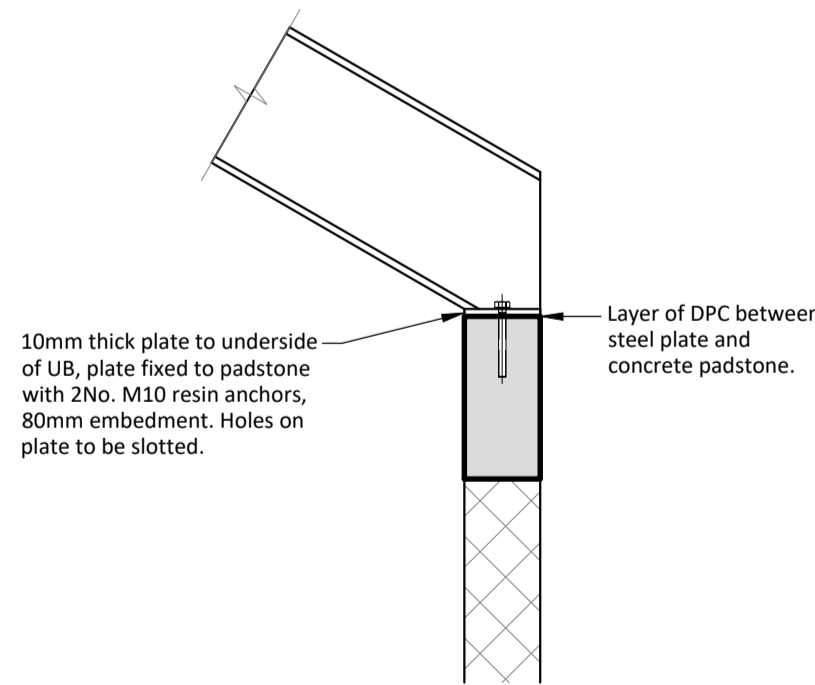
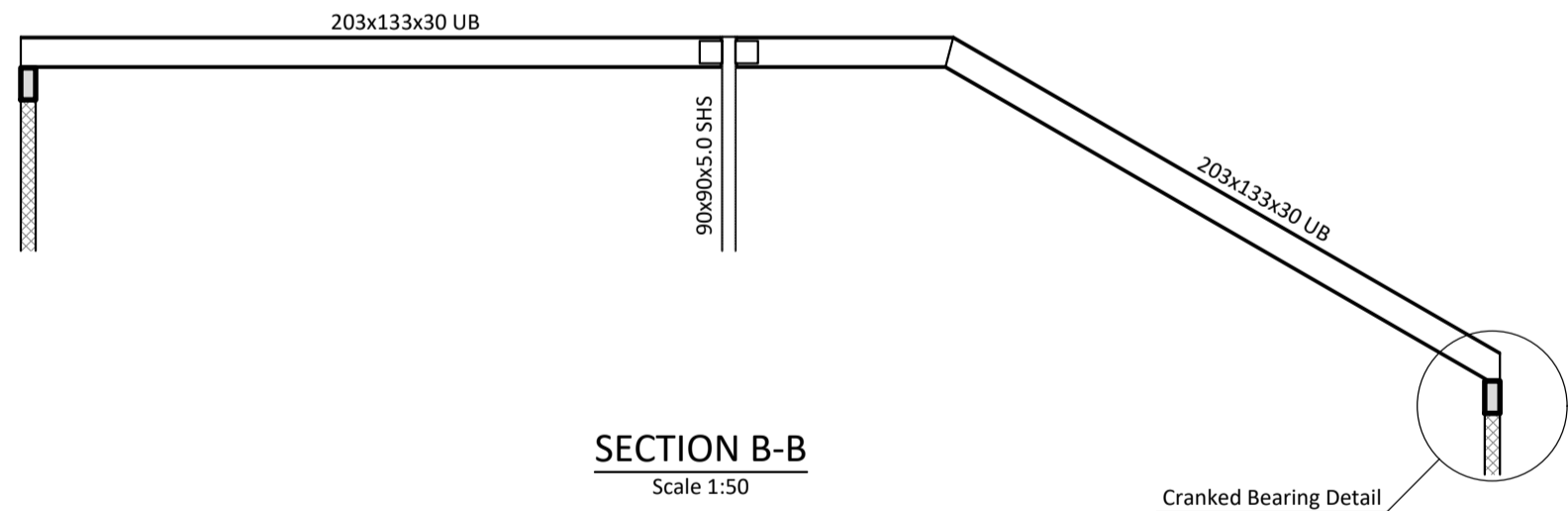

CRANKED BEARING DETAIL

Scale 1:10

## GENERAL

- DO NOT SCALE THIS DRAWING. USE ONLY WRITTEN DIMENSIONS. ANY DISCREPANCIES TO BE REPORTED TO THE ENGINEERS. IF IN DOUBT ASK.
- SETTING OUT TO ARCHITECT'S DRAWINGS.
- THIS DRAWING IS TO BE READ IN CONJUNCTION WITH ALL OTHER RELEVANT ARCHITECTS, ENGINEERS, AND SPECIALISTS DRAWINGS, AND WITH THE SPECIFICATIONS.
- WORKS TO COMPLY WITH ALL RELEVANT BRITISH STANDARDS, CODES OF PRACTICES, EURO CODES AND THE BUILDING REGULATIONS.
- THE CONTRACTOR SHALL BE RESPONSIBLE FOR MAINTAINING THE STRUCTURAL INTEGRITY OF THE WORKS AT ALL TIMES BY THE PROVISION OF ADEQUATE TEMPORARY WORKS.
- ALL DIMENSIONS IN MILLIMETRES (mm).
- ALL LEVELS IN METRES (m).

## BLOCKWORK ABOVE GROUND

- ALL LOADBEARING BLOCKWORK ABOVE GROUND LEVEL TO BE MIN 3.6N/mm<sup>2</sup>, ALL IN GRADE M6 (ii) MORTAR
- ALL MOVEMENT JOINTS TO BE FORMED WITH 10mm. LOW DENSITY CLOSED CELL POLYTHENE FILLER WITH FLAT TIES, FITTED WITH PLASTIC DEBONDING SLEEVES, AT 225mm. VERTICAL CENTRES. SEALED WITH POLYSULPHATE SEALANT TO ARCHITECT'S REQUIREMENTS.
- ALL WALL TIES ARE TO BE STAINLESS STEEL AND COMPLY WITH BS 1243 AND MEET THE PERFORMANCE REQUIREMENTS OF STANDARD DD140. CLASS 1, AND ARE TO BE INSTALLED IN FULL ACCORDANCE WITH BS 5628 - PART 3 : 2001. MIN 2.5 TIES PER m<sup>2</sup>. TIES AT MAX. 450mm VERTICAL CENTRES AND MAX. 900mm HORIZONTAL CENTRES. TIES TO BE AT MAX. 225mm VERTICAL CENTRES AROUND OPENINGS.
- VERTICAL RESTRAINT STRAPS TO BE 30 x 2.5mm. THICK SECTION GALVANIZED MILD STEEL IN ACCORDANCE WITH BUILDING REGULATIONS U.N.O. (STRAP LEGS 100 & 900mm. Lg). 100mm. LEG NAILED TWICE TO WALL PLATE, 900mm. LEG PLUGGED AND SCREWED TO THE WALL A MINIMUM OF 3 TIMES USING 50mm. LONG No.10 SCREWS. (LAST FIXING 150mm. MAXIMUM FROM END OF STRAP).
- PADSTONES TO BE GRADE C20 CONCRETE WITH A MINIMUM CEMENT CONTENT OF 220kg/m<sup>3</sup> AND A FREE WATER/CEMENT RATIO OF 0.8. OR ALTERNATIVE APPROVED.

## STEELWORK

- ALL STEELWORK TO BE GRADE S275 TO BS EN 10025 UNLESS NOTED OTHERWISE ON THE DRAWINGS. FABRICATION AND ERECTION OF STEELWORK TO COMPLY WITH THE RELEVANT SECTIONS OF BS 5950 AND "THE NATIONAL STRUCTURAL STEELWORK SPECIFICATION".
- ALL DIMENSIONS ARE TO BE CHECKED ON SITE PRIOR TO ANY FABRICATION WORKS. ANY DISCREPANCIES ARE TO BE BROUGHT TO THE ENGINEERS ATTENTION IMMEDIATELY.
- ALL STEELWORK BELOW GROUND TO BE ENCASED IN 100mm CONCRETE UP TO TOP OF STRUCTURAL SLAB LEVEL, UNLESS NOTED OTHERWISE.
- ALL STEELWORK WITHIN CAVITY WALLS, OR TOTALLY ENCASED, TO BE BLAST CLEANED TO SA 2½ AND PAINTED WITH 1 COAT OF ZINC PHOSPHATE EPOXY PRIMER TO A MINIMUM 80µm. DFT.
- ALL EXPOSED INTERNAL STEELWORK TO BE BLAST CLEANED TO SA 2½ AND PAINTED WITH 1 COAT OF HIGH BUILD ZINC PHOSPHATE EPOXY PRIMER TO A MINIMUM 80µm. DFT WITH A SITE APPLIED ALKYD FINISH TO A MINIMUM 60µm. DFT, COLOUR TO ARCHITECTS SPECIFICATION.
- ALL BOLTS TO BE GRADE 8.8 U.N.O.
- ALL STEEL TO BE FIRE PROTECTED EITHER WITH BOARDING OR INTUMESCENT PAINT. RATING TO BE IN ACCORDANCE WITH BUILDING REGULATIONS.

## TIMBER ROOFS

- TIMBER TO BE GRADE AS FOLLOWS: GRADE C24 TO BS 5628-2:2002 MINIMUM.
- VERTICAL RESTRAINT STRAPS TO BE 30mm. x 2.5mm. THICK GALVANIZED M.S. AT 2000mm. Ctrs. (STRAP LEGS 100 x 900lg). 100mm. LEG NAILED TWICE TO WALL PLATE AND PLUGGED AND SCREWED TO WALL A MINIMUM OF 3 TIMES USING 50mm. LONG No.10 SCREWS. (LAST FIXING 150mm. MAXIMUM FROM END OF STRAP).
- HORIZONTAL RESTRAINT STRAPS TO BE PROVIDED AT RAFTER AND CEILING JOIST LEVEL AT 2000mm. Ctrs. STRAPS TO BE 30mm. x 5.0mm THICK GALVANIZED MILD STEEL. 100mm. LEG OF STRAP TO BE BUILT INTO WALL. STRAPS TO EXTEND OVER 3 No. RAFTERS / CEILING JOISTS AND TO BE NAILED TWICE TO EACH USING 50mm. LONG 8 SWG NAILS. SOLID NOGGINS ARE TO BE PROVIDED AT STRAP LOCATIONS BETWEEN RAFTER/CEILING JOIST POSITIONS AND BETWEEN RAFTER/CEILING JOIST AND WALL.



All Temporary works to be designed by contractor.

All existing external walls are assumed to be standard masonry cavity construction - inform Engineers of any discrepancies.

Existing structural elements indicated on this drawing are assumed only. To be checked on site by the contractor.

REV	DESCRIPTION	DRAWN	CHK'BY	DATE
A1	ISSUED FOR BUILDING CONTROL	MD	MC	23.02.23
A2	GENERAL REVISIONS	MD	MC	07.03.23

CLIENT: Westfield Parish Council			
PROJECT REF:	FILE:	DRG NO.:	REV:
M2-2572	GA	002	A2
SCALE (A1):	DRAWN:	CHECKED:	DATE:
As Shown	MD	MC	FEB 2023

PROJECT TITLE: West Hill Pavilion
DRAWING TITLE: Proposed Superstructure



W: www.m2structural.co.uk  
E: info@m2structural.co.uk  
T: 01225 285073