



Note.

All Contractors working from this drawing must satisfy themselves as to its accuracy and verify all dimensions on site before commencing any works or producing any working drawings.

1, All items are deemed to be correct at time of survey only.
2, This drawing should only be used for the purpose for which it was originally intended.
3, Services have been established by a visual cover inspection only. No covers have been lifted.
4, Fences and walls are shown as surveyed features only. They do not necessarily denote land ownership or site boundaries.
5, Levels relate to an Arbitrary datum level of 10.0m at Survey station pin.

Due to the age and nature of the building all critical dimension should be checked on site as variances may occur.

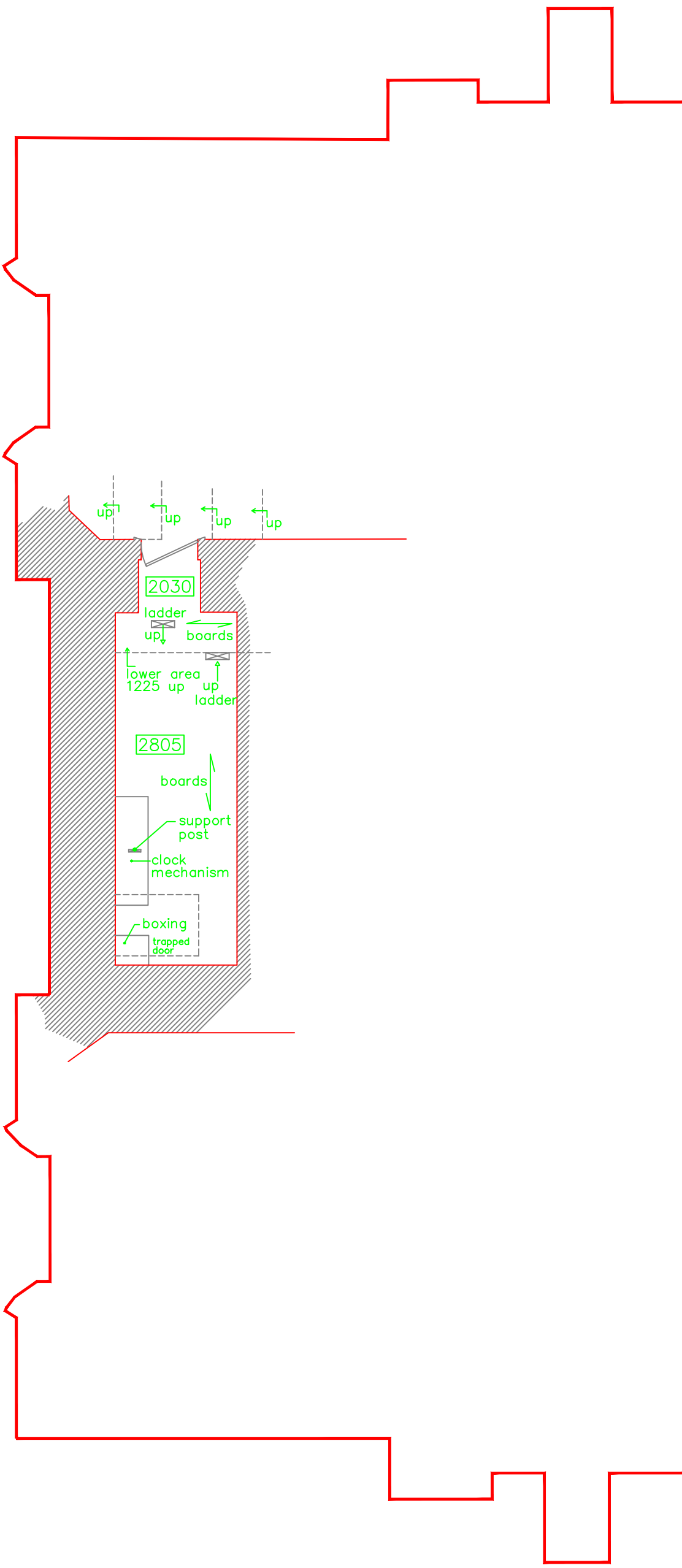

First Floor Tower Plan
1:50

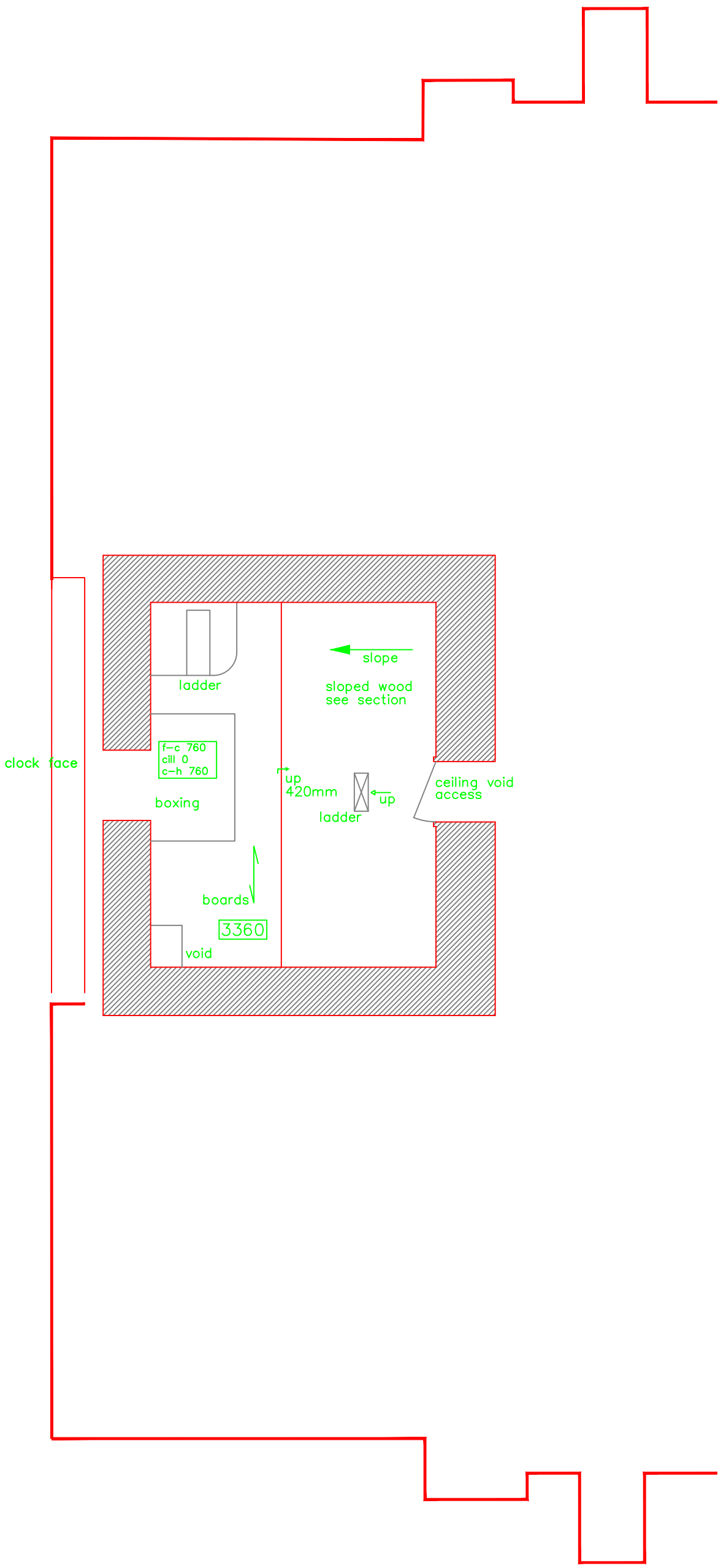

Second Floor Tower Plan
1:50

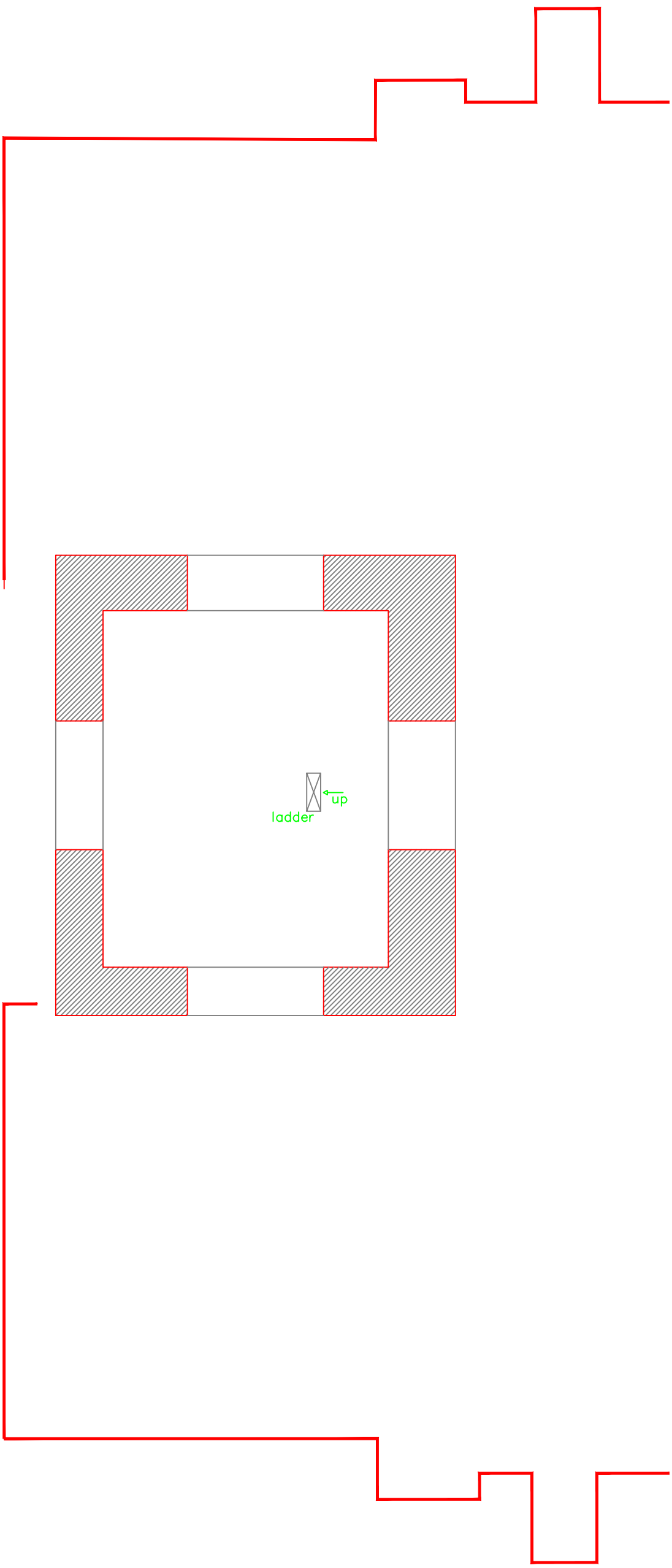

Top Floor Tower Plan
1:50



This drawing is 1:50 at A1

- 2685 floor covering to underside of ceiling
3730 floor covering to underside of ceiling slope or item shown
- rad radiator shown as measured length and location
- elec electric consumer unit
- gas main gas incoming point
- combi combi boiler
- f=c 895 floor to cill window height
cill 20 cill thickness
c=h 1155 cill to head
- boards direction of floorboards
- up xx height of step
- xx deep depth of beam
- X spot level relating to 10.0m datum

Issue	Amendment	Date
G.Q.G. Services		
Measured Land and Building Surveys		
Tel: 01983 812522. Mobile: 077 7211 8479. E-mail: brianquirk@live.co.uk		
Contract: St Thomas Church		
Date: Nov 2021	Scale: 1:50	
Client: Ryde Town Council Lind Street, Ryde, Isle of Wight.		
Title: St Thomas Church St Thomas Street, Ryde, Isle of Wight.		
Tower Plans		
Dwg Number : 1790/S/05.		