

DO NOT SCALE FROM THIS DRAWING

This drawing is the copyright of Rhodes & Partners and must not be copied or passed to a third party without consent of the company.

**Construction Notes:**

For all Construction Notes please refer to Rhodes and Partners drawing D26536-102.

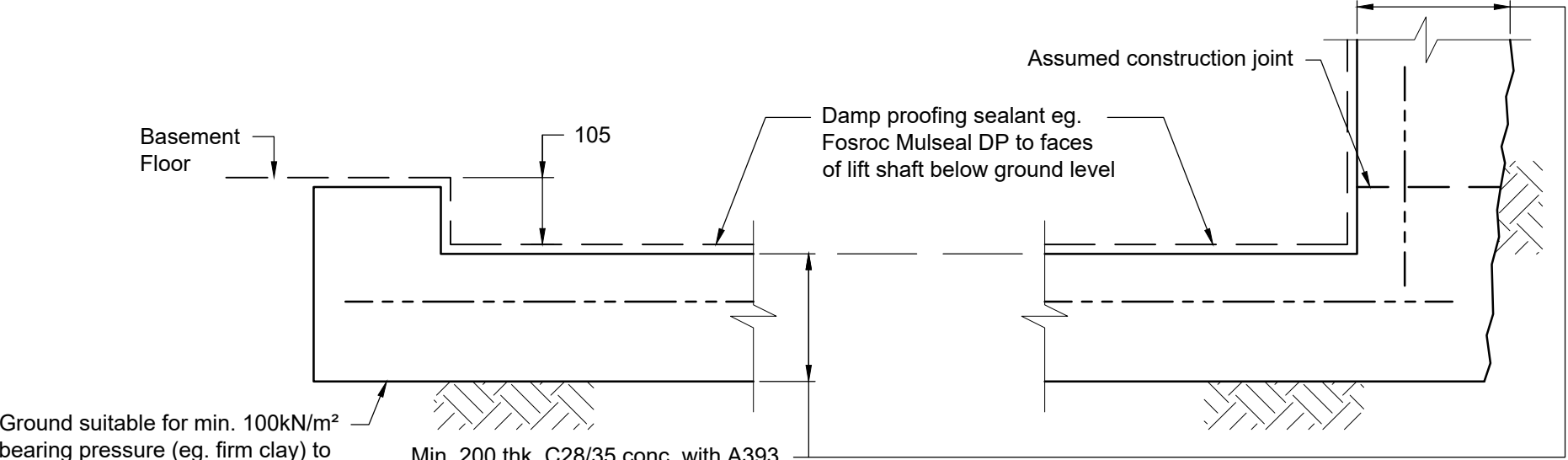

**Detail A**  
[Scale 1:10]

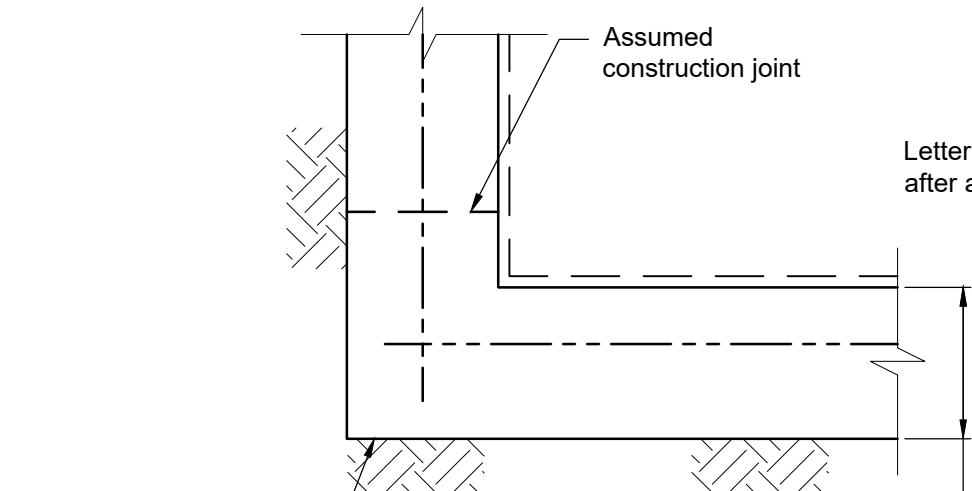

**Detail C**  
[Scale 1:10]

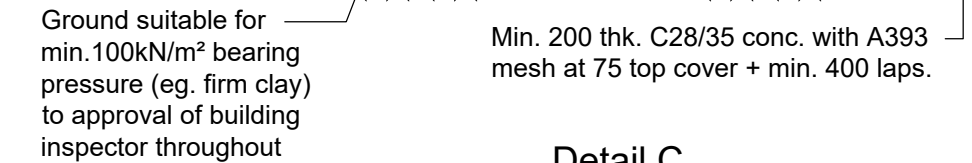

Ground suitable for min. 100kN/m² bearing pressure (eg. firm clay) to approval of building inspector throughout

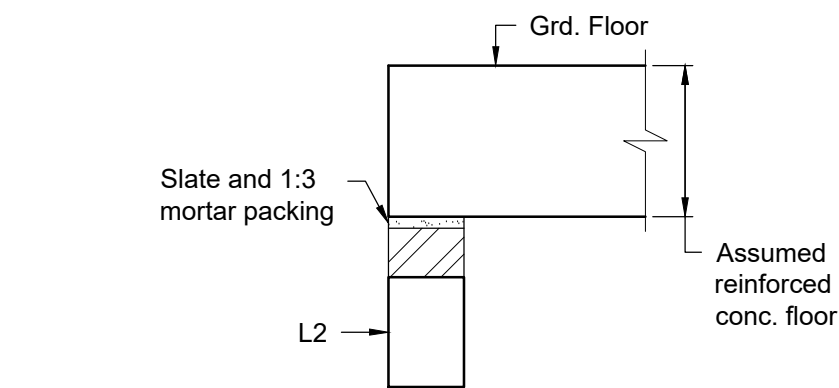

**Detail E**  
[Scale 1:10]

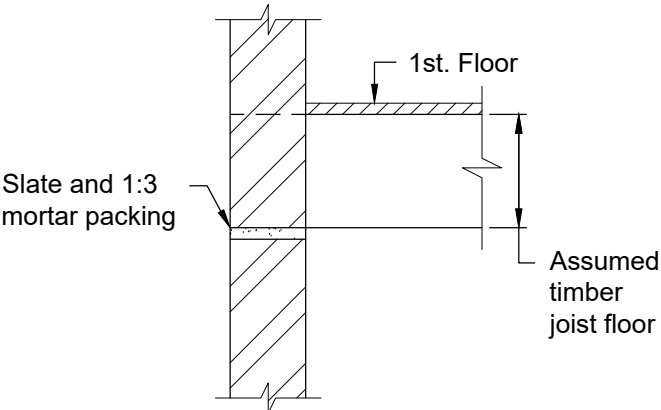

**Detail F**  
[Scale 1:10]

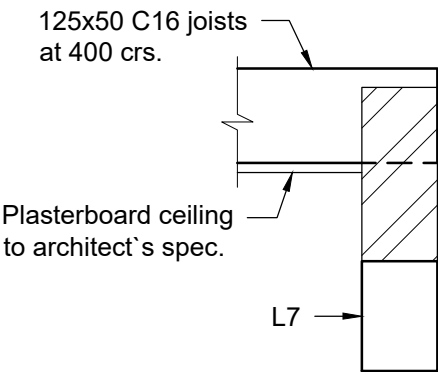

**Detail G**  
[Scale 1:10]

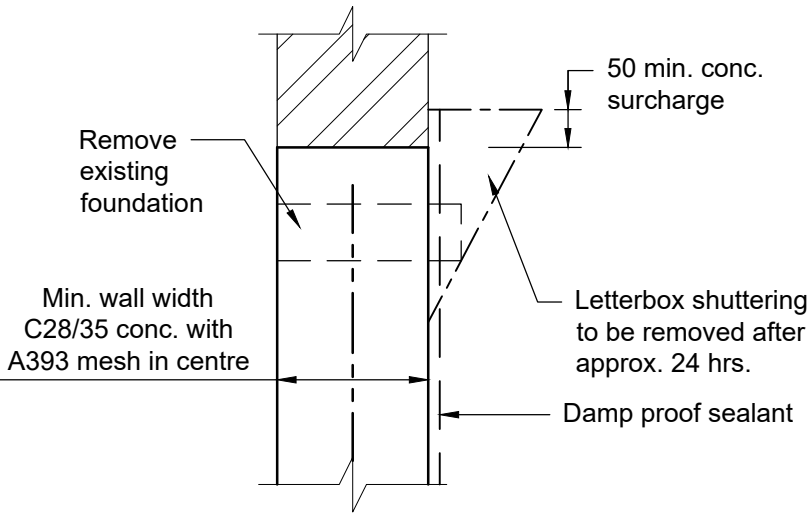

**Detail H**  
[Scale 1:10]

A	Detail C-C revised. Detail H-H added.	DB	PRG	13/11/2023
Rev	Description	By	Chkd	Date

Drawing Status:  
-

**Rhodes & partners**  
Consulting Civil and Structural Engineers  
Suite 4, Marple House, 39 Stockport Road, Marple, Stockport SK6 6BD  
t:0161 427 8388 e:office@rhodesandpartners.co.uk

Client:  
High Peak Architects Ltd

Project:  
The Mechanics Institute, Whaley Bridge  
SK23 7AA

Drawing Title:  
Lift Installation Structural Details  
- Sheet 4

Drawn By: DB	Checked By: PRG	Date: 01/06/2023	Scale: As shown on A3
-----------------	--------------------	---------------------	--------------------------

Drawing No: D26536-104	Revision: A
---------------------------	----------------