

This drawing is copyright to hormann architects limited and any use of the information requires written confirmation. Do not scale for construction purposes from this drawing and all dimensions are to be checked on site and any discrepancy, error or omission is to be reported to the architect. This drawing shall be read in conjunction with all relevant architects and engineers drawings and specifications.

Traffic Surfaces

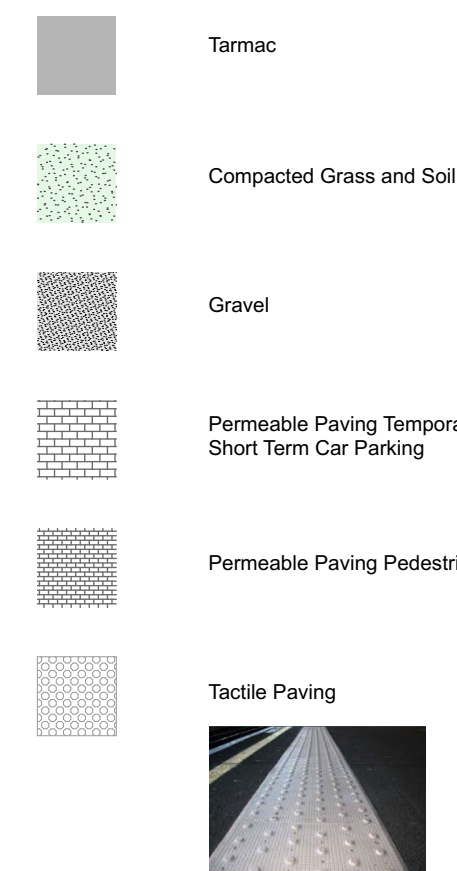

2.5m2 concrete base picnic bench raised

2.5m2 concrete base picnic bench floor level

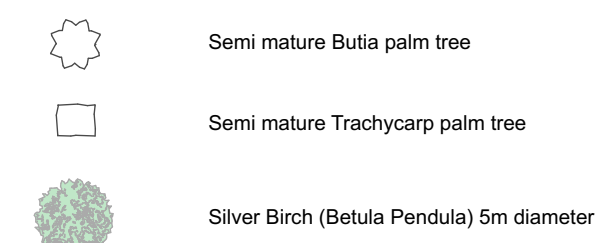

Design Risks & Hazards: Please inspect the site before any work is carried out. There are services in the ground as well as overhead services on site.

project

Dracaena Centre Skatepark Preparation

Dracaena Centre Falmouth,

client

Falmouth Town Council

drawing 06-Proposed

Site Plan



Studio2
Vonn Creative
59-61 Killgrew Street
Falmouth
TR11 3PP

01326 761 280

status			Technical Design		
scale			paper size		
1:250			A1		
project no.		drawing no.		drawn	
0270.a		301		MH	
				checked	
				MH	
date				rev	
20/02/2023				-	