

PLAN VIEW

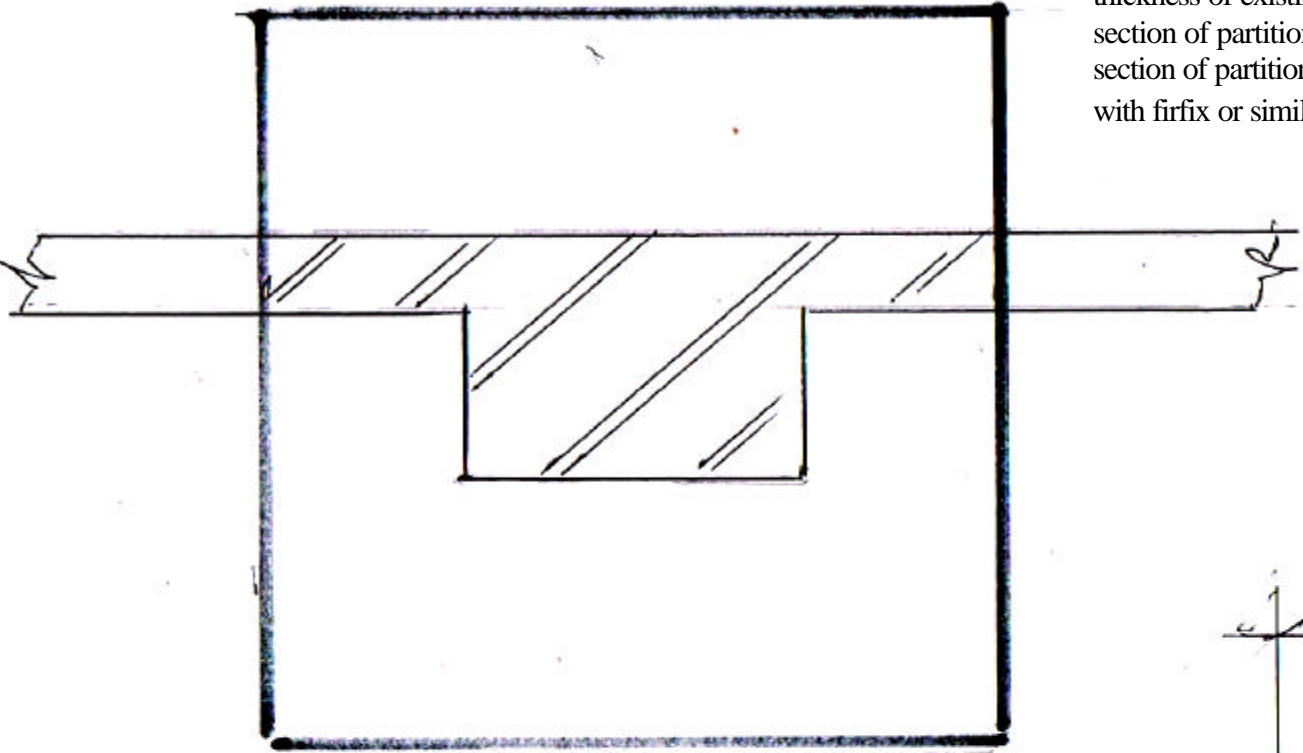

1.000 x 1.000 new
concrete base

450 x 225 brick ,or dense
concrete, pier added on to
thickness of existing rebuilt
section of partition. Bond new
section of partition to existing
with firfix or similar approved

1.000 deep or as
directed by Building
Control Officer

SECTION

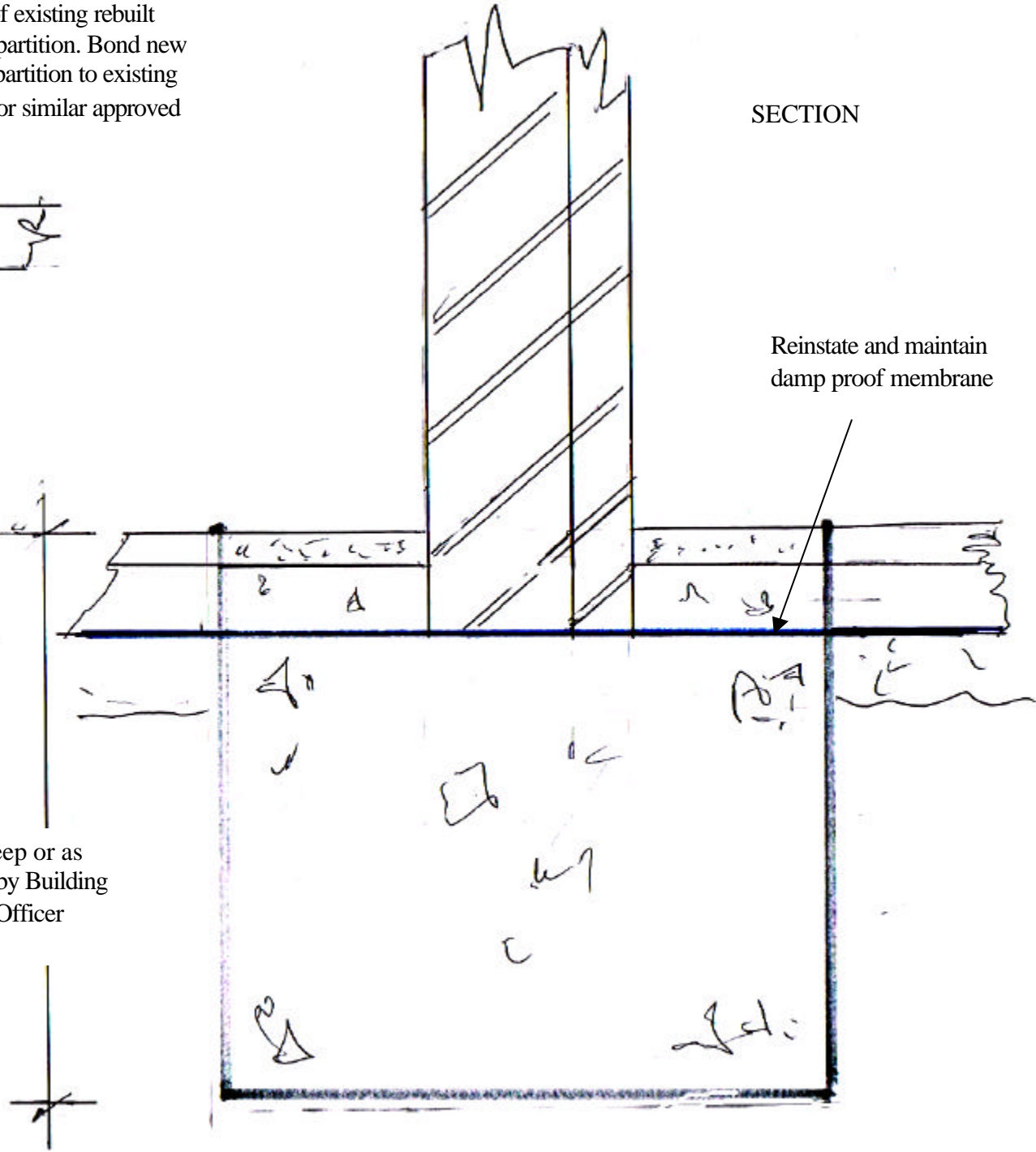

Reinstate and maintain
damp proof membrane

Keith Sanger Associates Ltd, Chartered Surveyors
23 Hazel Road, Lymington, Hampshire, SO41 8GR Tel:
01590 676879 Fax 01590 675266

Project : **Lodge Road Pavilion**

Drawing No **Nine revision B**

Pier Foundation Details Preliminary

Scale **1:10 at A3**

Date **December 2018**