



J PAMMENT

UK SITE INVESTIGATIONS LTD

REF NO:

SITE ADDRESS: Leybourne Village Hall, Leybourne, Kent

DATE: 4.12.17

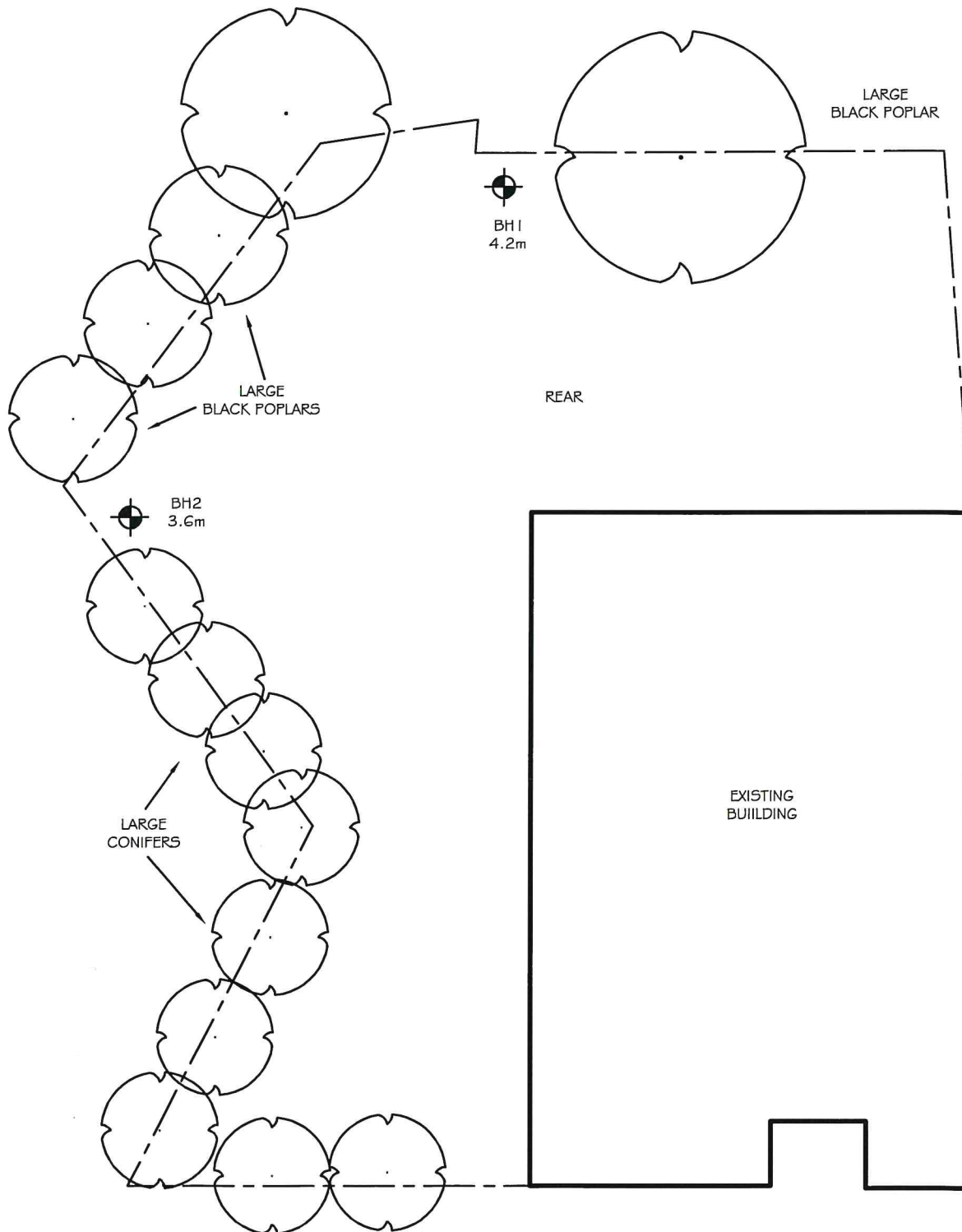



25 King Edward Avenue, Burnham-on-Crouch, Essex CM0 8PB
TEL/FAX: 01621 333343 - MOBILE: 07940 514 408

Key: D : Disturbed Sample M: Penetration Test by Mackintosh Probe W: Water Sample V: Vane Test



J PAMMENT

UK SITE INVESTIGATIONS LTD

25 King Edward Avenue, Burnham-on-Crouch, Essex CM0 8PB

TEL/FAX: 01621 333343 - MOBILE: 07940 514 408

BH No: 2		Sheet: 1 of 1	Ref:	Date: 4.12.17	For: Leybourne Village Hall, Leybourne, Kent				
Depth Mtrs.	Description of Strata	Thick-ness	Legend	Sample	Test Type	Result	Root Information	Depth to Water	Depth mtrs
G.L.	TOPSOIL.	0.5		D	M	50+ 50+ 50+ 50+	0.1 - Roots of live appearance to 1.8m. ↓ No roots observed below 1.8m.		1.0
0.5	Medium dense mid brown silty fine SAND with occasional fine gravel.	0.5							
1.0	Medium dense to dense mid brown as above.	0.5							
1.5	Medium dense to dense mid brown very gravelly silty fine SAND with numerous small to medium flints.	1.5		D	M	50+ 50+ 50+ 50+			2.0
3.0									
3.6	Medium dense to dense olive silty fine SAND with occasional thin layers of sandstone.	0.6		D	M	50+ 50+ 50+ 50+			
3.6	BOREHOLE ENDS AT 3.6m - POSSIBLE SANDSTONE - TOO HARD TO DRILL			D	M	50+ 50+ Too hard/dense to drive			3.6
Remarks: Borehole dry and slightly collapsing from 1.3m on completion.									

Key: D : Disturbed Sample

M: Penetration Test by Mackintosh Probe

W: Water Sample

V: Vane Test

Meridian Soils Limited

Electron House, Office & Technology Centre, West Hanningfield Road, Great Baddow, Essex. CM2 8JT
Tel: 01245 473113 E-mail: mail@meridiansoils.co.uk Web: www.meridiansoils.co.uk

Moisture Content and Index Property Determinations.

Our Ref:- S.9426

Client Ref:-

Location:- Leybourne Village Hall, Leybourne, Kent.

BH/TP No.	Sample No.	Depth m.	Natural Moisture %	Liquid Limit %	Plastic Limit %	Plasticity Index %	Passing 0.425 um %	Equivalent Moisture %	Class	Modified Plasticity Index %
1		4.00	7.2						Non-Plastic	
2		1.00		25	14	11	82		CL	9