

NOTES:
1. DO NOT SCALE FROM DRAWING.
2. ALL DIMENSIONS TO BE CHECKED ON SITE PRIOR TO COMMENCEMENT OF WORKS.
3. THIS DRAWING IS COPYRIGHT TO LEICESTERSHIRE FIRE AND RESCUE.
4. PERSONNEL SHOULD NOTE RELEVANT ITEMS REGARDING THE CONDITION OF THE EXISTING STRUCTURE CONTAINED WITHIN THE HEALTH & SAFETY FILE SHOULD THIS BE AVAILABLE

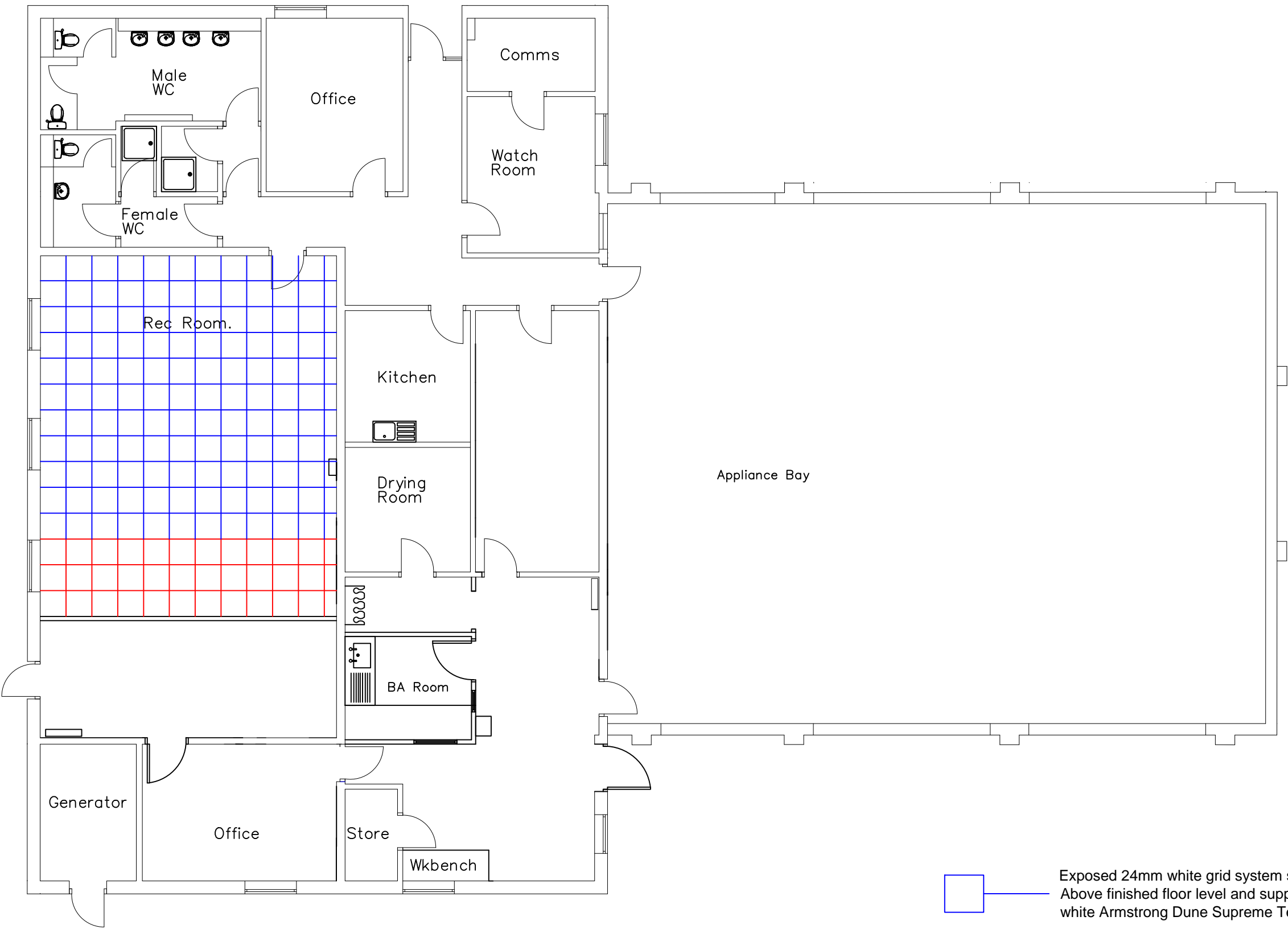

- Exposed 24mm white grid system set at a height of 3600mm
Above finished floor level and supply and install 600x600mm
white Armstrong Dune Supreme Tegular tile
- 24mm white grid exposed system set at a height of
3000mm and incorporate a bulkhead to dress into main
ceiling, supply and install Gyprex Satinspar vinyl-faced
ceiling tiles.

LEICESTERSHIRE FIRE and RESCUE SERVICE PREVENTING PROTECTING RESPONDING		
?		
REVISIONS		
LEICESTERSHIRE FIRE and RESCUE SERVICE		Estates Department Leicestershire Fire and Rescue Headquarters Geoff Monk Way Birstall TEL: 0116 2872241
PROJECT NUMBER		
PROJECT TITLE	Market Harborough Fire Station	
TITLE		
Proposed Lecture / Kitchen Ceilings		
DRAWING No	REV	SCALE
P/HARB/DC/16/113		1:100@A2
DRAWN BY	DATE	
DC	15/09/2016	
CHECKED BY	SIZE/PLOT	A2
ACAD FILE	UERN	