

This drawing is copyright to hormann architects limited and any use of the information requires written confirmation. Do not scale for construction purposes from this drawing and all dimensions are to be checked on site and any discrepancy, error or omission is to be reported to the architect. This drawing shall be read in conjunction with all relevant architects and engineers drawings and specifications.

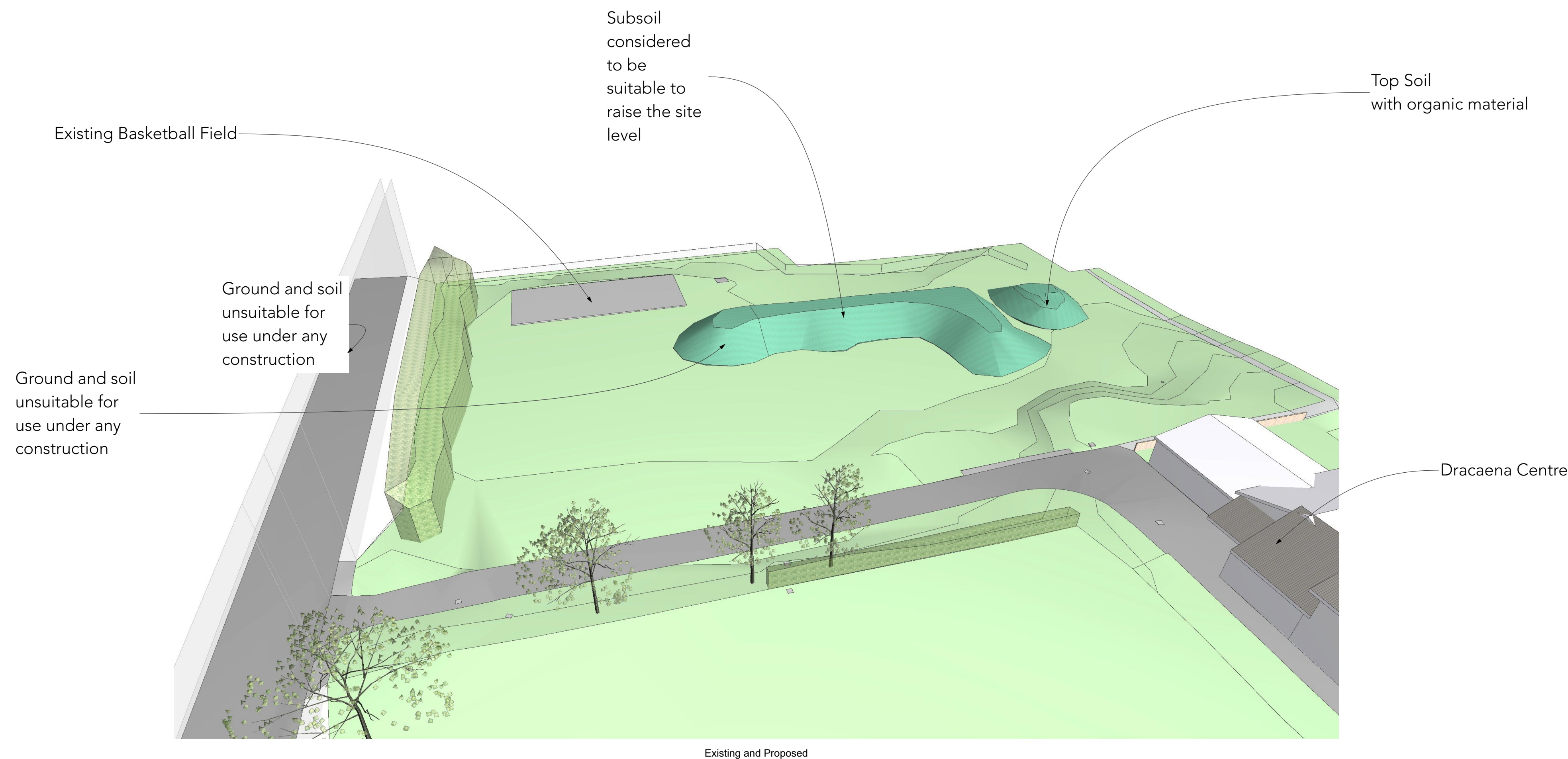

Design Risks & Hazards: Please inspect the site before any work is carried out. There are services in the ground as well as overhead services on site.

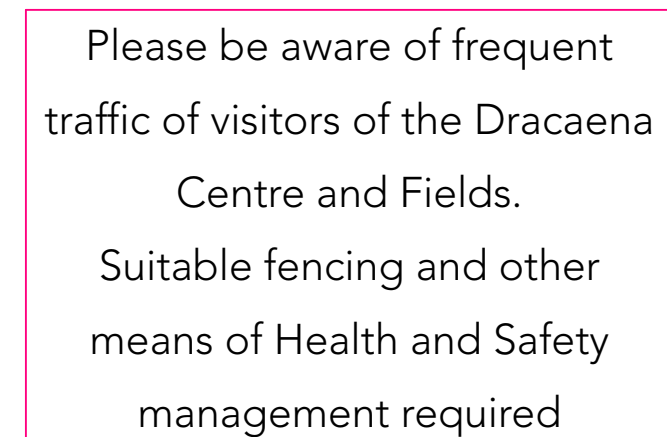
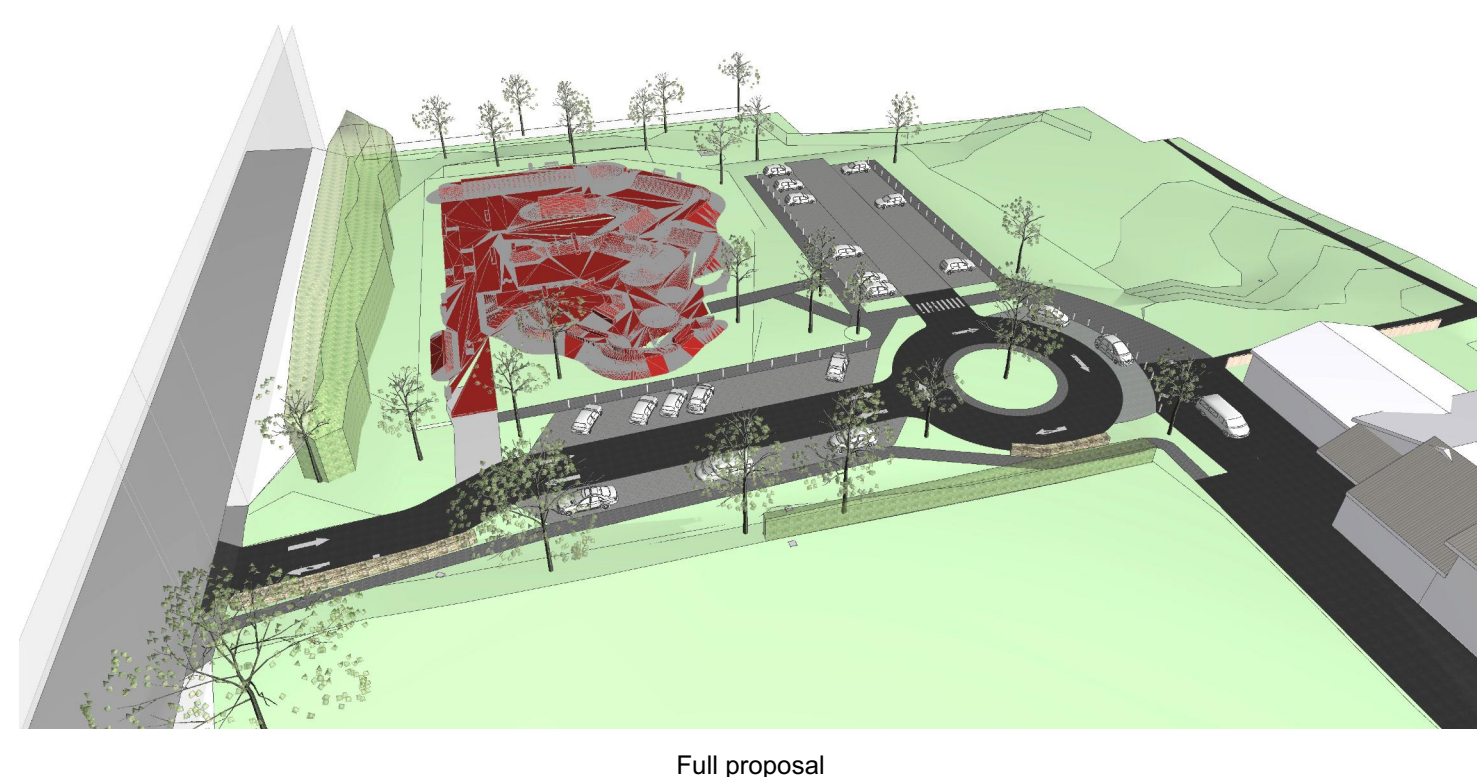
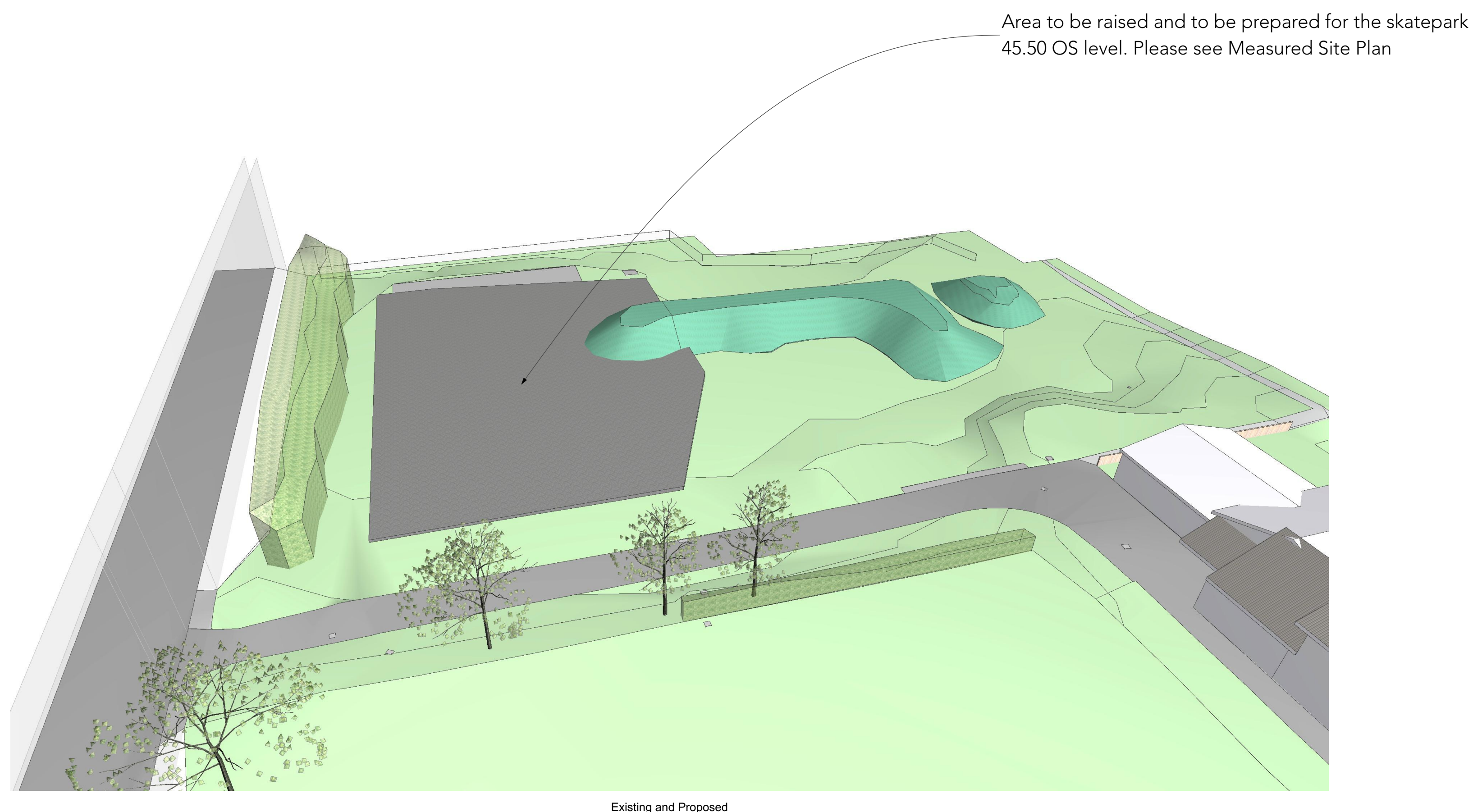
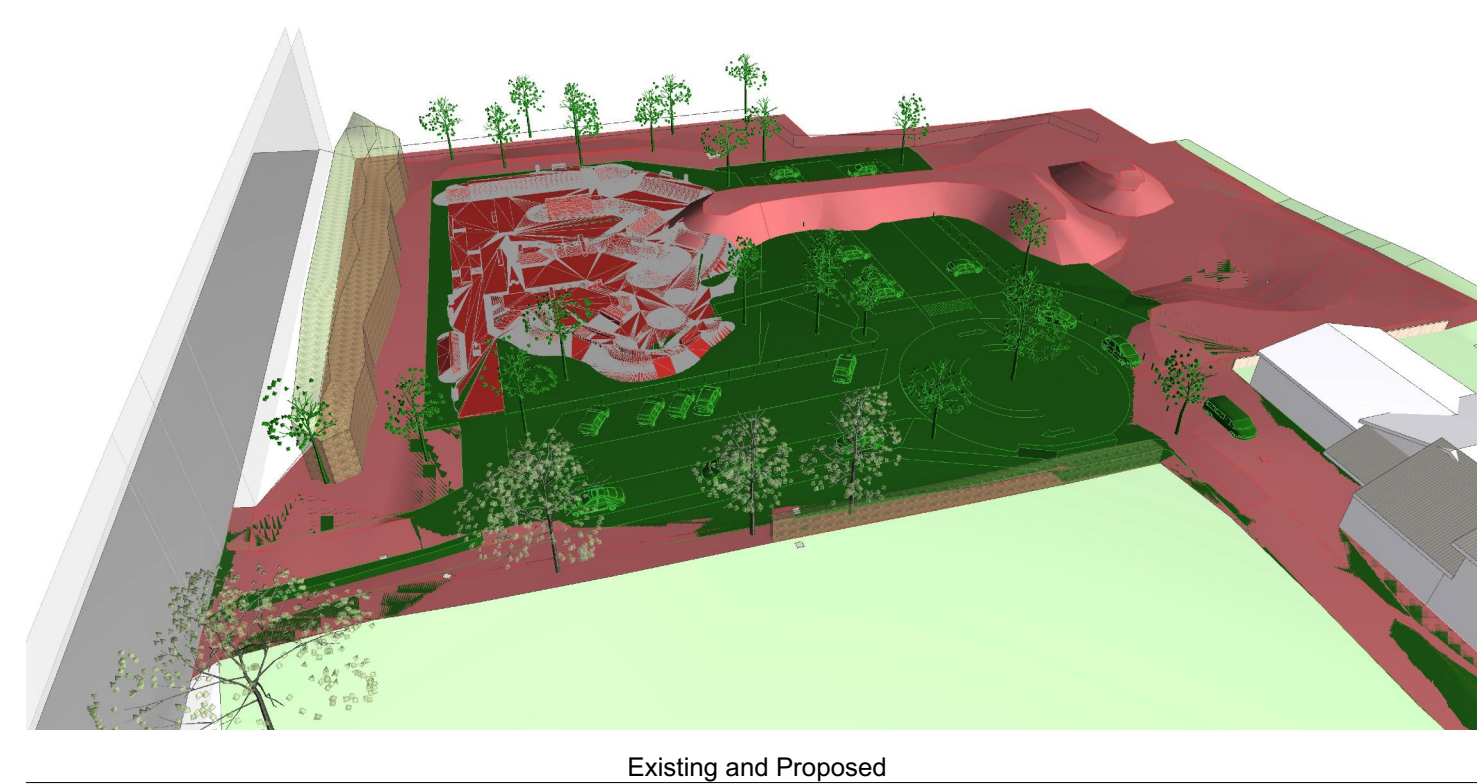

project

Dracaena Centre Skatepark Preparation

Dracaena Centre Falmouth,

client

Falmouth Towncouncil

drawing

01-Existing, 05-Proposed-overExisting,
06-Proposed

Existing and Proposed; Full proposal

 **Hormann Architects**

Curious . Smart . Creative

RIBA # arb Architects
Registration
Board

Studio2
Venn Creative
59-61 Kilgerr Street
Falmouth
TR11 3PF

01326 761 290

status			Technical Design		
scale			paper size		
			A1		
project no.		drawing no.		drawn	
0270.a		421		MH	
				checked	
				MH	
date			rev		
20/02/2023			-		