

Safety Health Environment and Welfare Information	
Risks listed here are not exhaustive. Refer to the DHEMR document ENVIMSW002194-BMM-XX-000-HS-1102020	
In addition to the hazards/risks normally associated with the types of work detailed on this drawing, note the following significant residual risks:	
Construction	
G. 01	Injury or death due to accidental strike of buried or contact with overhead services in proximity to construction or survey works. Refer to services drawings for more information.
G. 13	Injury or death due to collapse of existing structures resulting from working near/in/over structures of unknown structural capacity.
G. 17	Adverse impact on local fauna or protected species resulting from site works. Requirement for ecological supervision or review of method statements to be informed by licences/permits in place, specific species survey reports and the ecological pre-construction walkover.
G. 19	Injury or death due to UXO strike resulting from intrusive construction or survey works. Refer to UXO risk assessment for mitigation measures in each area.
G. 23	Injury or death due to oil or gas leak, potentially leading to explosion, as a result of damage to above ground pipelines. Adhere to minimum distance restrictions where required.
G. 31	Injury or death as a result of slope instability or flooding during construction of the flood embankment. Appropriate visual inspection and monitoring of embankment during construction
Decommissioning/Demolition	
G. 17	Adverse impact on local fauna or protected species resulting from site works. Requirement for ecological supervision or review of method statements to be informed by licences/permits in place, specific species survey reports and the ecological pre-construction walkover.
G. 19	Injury or death due to UXO strike resulting from intrusive construction or survey works. Refer to UXO risk assessment for mitigation measures in each area.

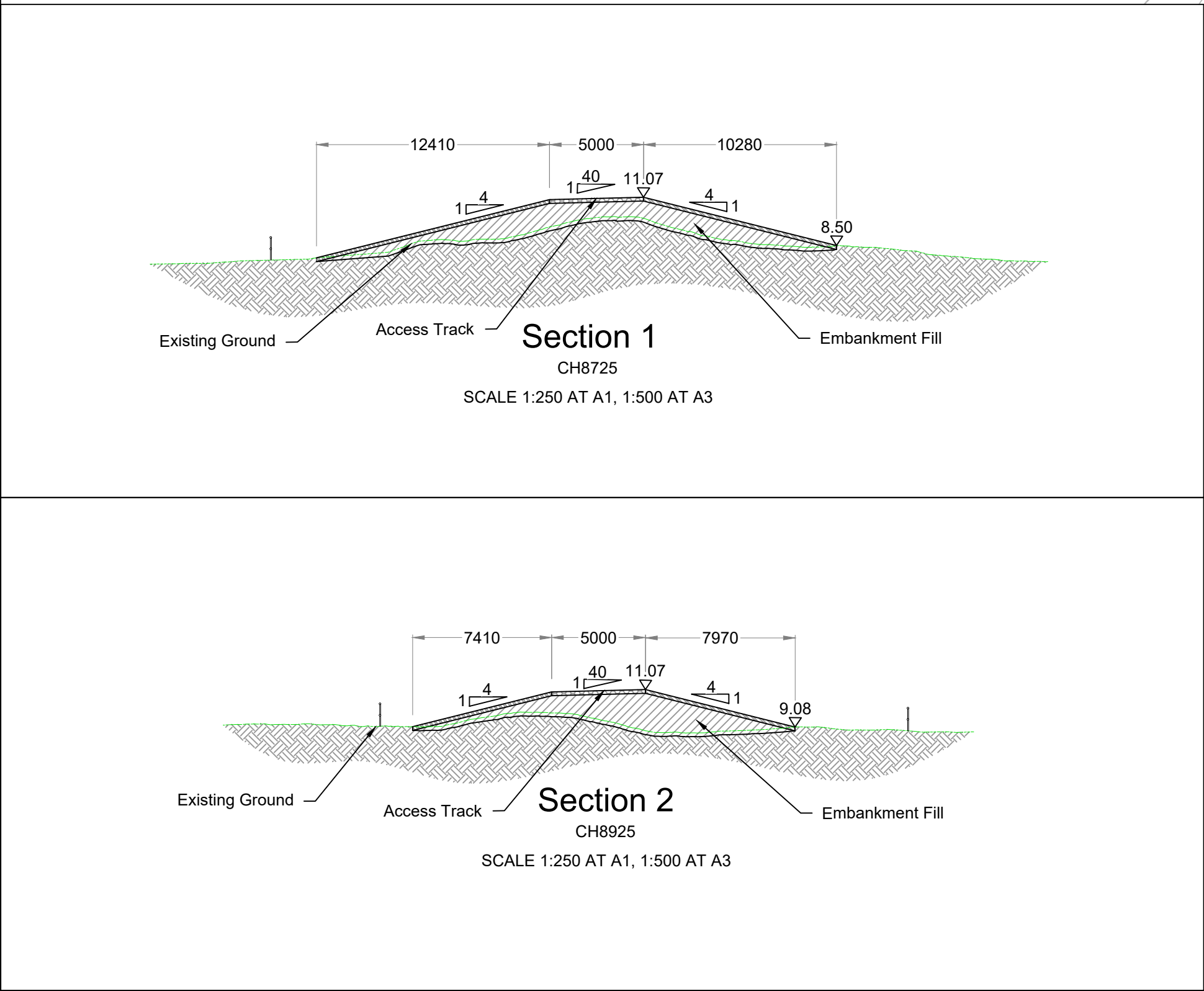

© Crown copyright and database rights 2019 Ordnance Survey Licence Number :100026380  
© Mott MacDonald Limited  
This document is issued for the party which commissioned it and for specific purposes connected with the captioned project only. It should not be relied upon by any other party or used for any other purpose.  
We accept no responsibility for the consequences of this document being relied upon by any other party, or being used for any other purpose, or containing any error or omission which is due to an error or omission in data supplied to us by other parties.

C:\users\che48345\appdata\local\projectwise\workdir\mott-gb-pw-03\0184573\ENVIMSW002194-BMM-XX-A32-DR-Z-0202484.dwg Aug 6, 2021 - 8:35AM POP60650

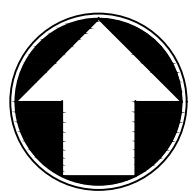
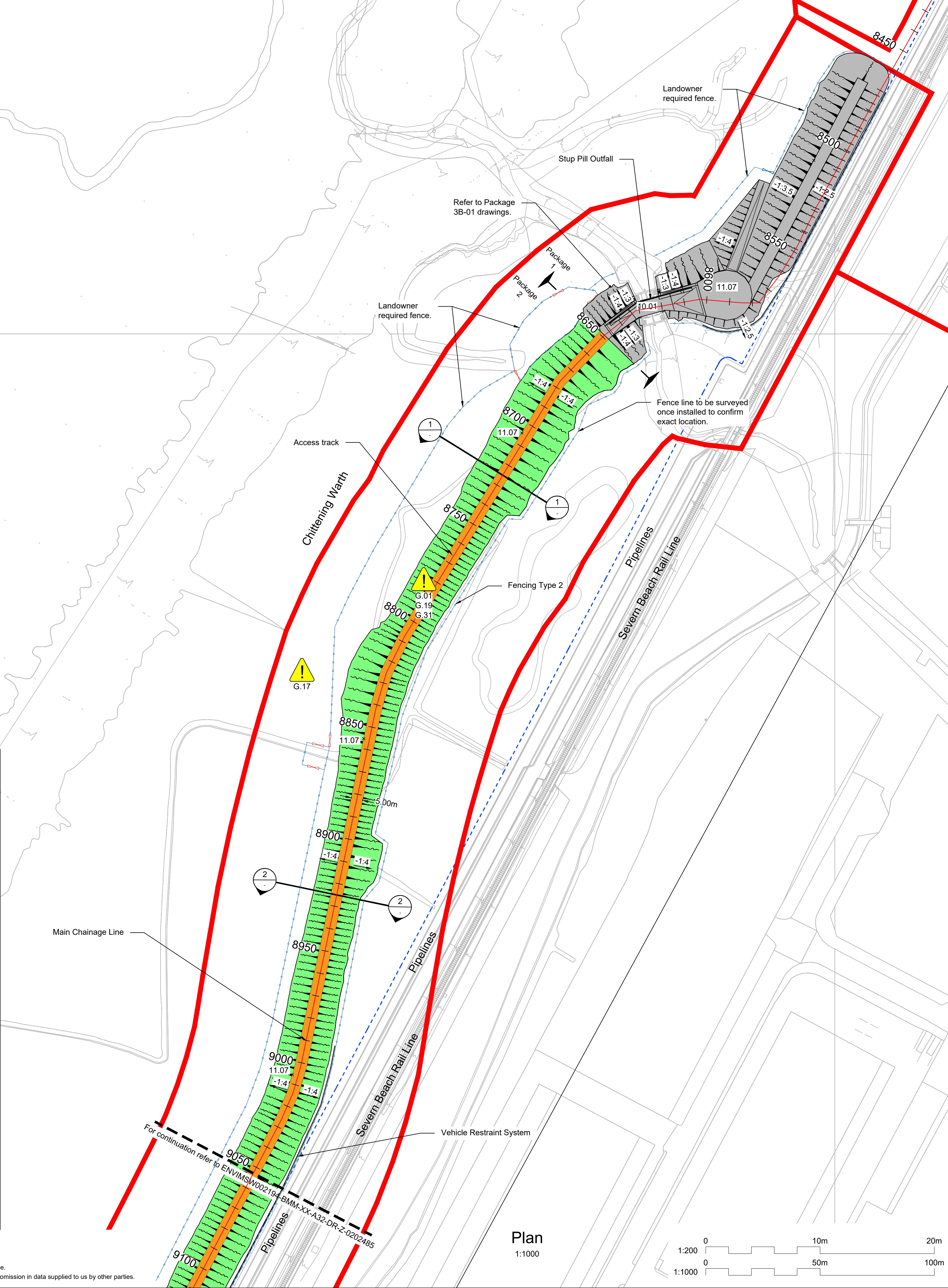

Notes

- All dimensions are in Millimetres unless stated otherwise.
- All levels are stated in Metres, and relative to ordnance datum. Levels are based on the topographical survey carried out by Texo Drone Survey and Inspection Ltd in December 2019.
- Contains Ordnance Survey Data © Crown copyright and database rights 2020 Ordnance Survey. All rights reserved. Environment Agency 100026791.
- Constructed embankment height may vary form the design crest level to allow for settlement of the embankment.
- Estuarine flood bank grassland mix (EFG mix) to be applied to all new earthwork embankments and disturbed ground in the near vicinity. (Refer to Landscape Specification: ENVIMSW002194-BMM-XX-A10-RP-L-0302134 & ENVIMSW002194-BMM-HB-A20-DR-L-0307061 which includes landscape overview notes.
- An edge protection is required along the access track to reduce the risk of vehicle impact onto the fuel lines. This shall comprise a proprietary vehicle restraint system (N1 containment, W3 working width), installed in accordance with the manufacturer's instructions, and with P1 terminals at either end. The extent of VRS shall be confirmed on site.

Key to symbols

	Site Boundary		3m Offset from Oil Pipeline
	Chainage Line		
	Embankment		
	Maintenance Access Track / Footpath		
	Vehicle Restraint System		
	Proposed Spot Level		
	Proposed Gradient		
	Fencing Type 1		
	Fencing Type 2		
	Gate Type 1		
	Gate Type 2		
	Gate Type 4A		

Key Plan

Reference drawings

ENVIMSW002194-BMM-XX-A32-DR-Z-0202485 - Area3B - General Arrangement - Sheet 2 of 2

Standard Details

ENVIMSW002194-BMM-XX-000-DR-C-0202898 - 0202899 - Typical Earthwork Sections

ENVIMSW002194-BMM-XX-000-DR-C-0202885 - 0202886 - Fencing

Specification Drawings:

ENVIMSW002194-BMM-XX-000-DR-C-0202912 - 0202914

Gate and Fencing Drawings:

ENVIMSW002194-BMM-XX-000-DR-C-0202887 Standard Detail Fencing

ENVIMSW002194-BMM-XX-000-DR-C-0202886 Standard Detail Gates

P01	09/06/21	ER	Preliminary Issue	GM	MS
C01	05/08/21	TR	For Construction	MC	MS

Rev	Date	Drawn	Description	Ch'k'd	App'd

10 Temple Back  
Bristol  
BS1 6FL  
United Kingdom  
  
T +44 (0)117 906 9500  
F  
W www.mottmac.com

Client

Title

ASEA Ecology & Flood Defence Scheme  
Area 3B - Package 2  
CH8+650 to CH9+050  
General Arrangement  
Sheet 1 of 2

Designed	A.HATHERLEY	AHA	Eng check	M.CHEETHAM	MC
Drawn	T.RISTOV	TR	Coordination	P.F.EASTON	PE
Dwg check	J.POPPERL	JP	Approved	M.D.SCKER	MS

Scale at A1	Status	Rev	Security
AS SHOWN	CON	C01	STD

Drawing Number  
ENVIMSW002194-BMM-XX-A32-DR-Z-0202484