

**Badger 210730_QS-14A_Final
A303 Amesbury to Berwick Down
PIM Clashes review report**

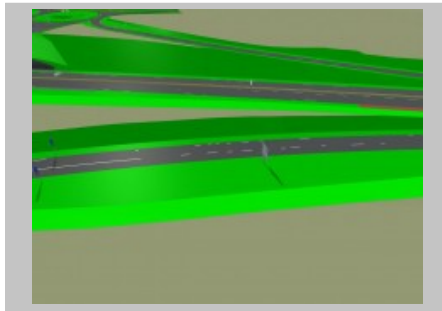

HE551506 - A303

ID [877](#)

↓ Minor

Solved

Title
HML vs HSNAssignee
Steve Smith
Reporter
Niteen PawarProject
HE551506 - A303Created
26/Feb/2021
Deadline
26/Feb/2021

Clash test

None

Date and Time

26/Feb/21

10:24 GMT

Commented by Niteen Pawar

Steve Dimmock - Please confirm if the sign post is designed as passively safe column and does need VRS protection.

Date and Time

26/Feb/21

10:35 GMT

Commented by Mara Sierra Alvarez

Changed to another assignee as Steve Dimmock is not available today

Date and Time

26/Feb/21

10:48 GMT

Commented by Steve Smith

The sign posts are passively safe

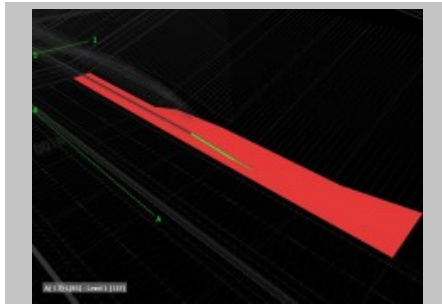
ID [374](#)

↓ Minor

Solved

Title
HML vs HMK: Clash4Assignee
Niteen Pawar
Reporter
Mara Sierra AlvarezProject
HE551506 - A303Created
26/Feb/21
Deadline
26/Feb/21

Clash test

HML vs HMK

Date and Time

26/Feb/21

10:14 GMT

Commented by Niteen Pawar

The barrier foundation will be flushed with the verge top level. So this is not a real clash.

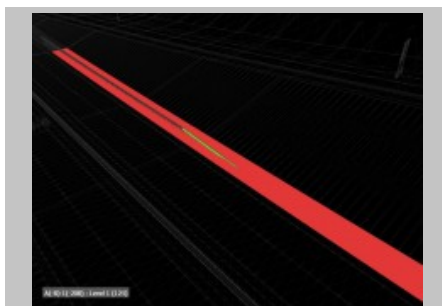

ID [407](#)



↓ Minor

Solved

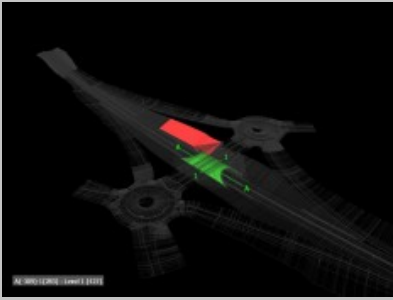
Title
HML vs HRR: Clash3Assignee
Niteen Pawar
Reporter
Mara Sierra AlvarezProject
HE551506 - A303Created
26/Feb/21
Deadline
26/Feb/21

| | |
|---------------|---|
| Clash test | |
| HML vs HRR | |
| <hr/> | |
| Date and Time | Commented by Mara Sierra Alvarez |
| 26/Feb/21 | Please, review clash and provide a solution |
| 10:15 GMT | |
| <hr/> | |
| Date and Time | Commented by Niteen Pawar |
| 26/Feb/21 | The barrier foundation will be flushed with verge top level. So, this is not a real |
| 8:28 GMT | clash |

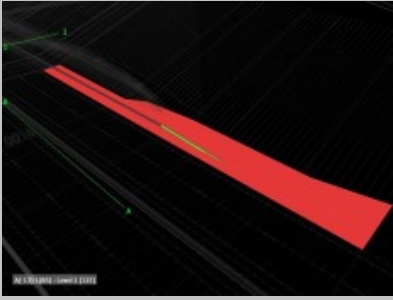
| | | | |
|---|--|--|-----------------------|
|  | ID 464  Minor Solved | Assignee Jose Alejandro Civera Abad | |
| | Title HML vs SBR: Clash4 | Reporter Mara Sierra Alvarez | |
| Project HE551506 - A303 | | Created 26/Feb/21 | Deadline 26/Feb/21 |
| <hr/> | | | |
| Clash test HML vs SBR | | | |
| <hr/> | | | |
| Date and Time 26/Feb/21 9:37 GMT | Commented by Jose Alejandro Civera Abad This is same case as clash ID 466 | | |

| | | | |
|---|--|---------------------------------|-----------------------|
|  | ID 409  Minor Solved | Assignee Niteen Pawar | |
| | Title HML vs HRR: Clash4 | Reporter Mara Sierra Alvarez | |
| Project HE551506 - A303 | | Created 26/Feb/21 | Deadline 26/Feb/21 |
| <hr/> | | | |
| Clash test HML vs HRR | | | |
| <hr/> | | | |
| Date and Time 26/Feb/21 8:27 GMT | Commented by Niteen Pawar The barrier foundation will be flushed with the verge top level. So this is not a real clash | | |

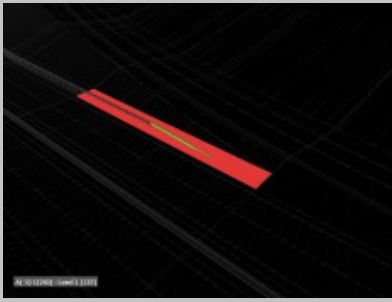
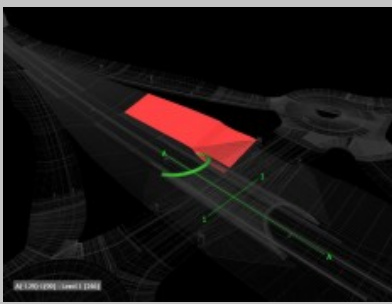
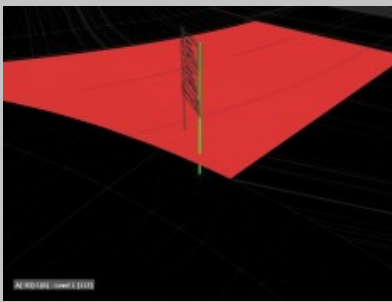
ID [405](#) Minor**Solved**Title
HML vs HRR: Clash2Assignee
Niteen Pawar
Reporter
Mara Sierra AlvarezProject
HE551506 - A303Created
26/Feb/21Deadline
26/Feb/21Clash test
HML vs HRRDate and Time
26/Feb/21
10:17 GMT[Commented by](#) Mara Sierra Alvarez
Please, review clash and commentDate and Time
26/Feb/21
8:28 GMT[Commented by](#) Niteen Pawar
The barrier foundation will be flushed with verge top level. So, this is not a real clashID [466](#) Minor**Solved**Title
HML vs SB : Clash7Assignee
Jose Alejandro Civera Abad
Reporter
Mara Sierra AlvarezProject
HE551506 - A303Created
26/Feb/21Deadline
26/Feb/21Clash test
HML vs SBRDate and Time
26/Feb/21
9:37 GMT[Commented by](#) Jose Alejandro Civera Abad
The slope of the earthworks should be modified to fit the structure arrangement. Also it seems that this element should be cut by the A360 slope.ID [551](#) Minor**Solved**Title
HML vs HSN: Clash54Assignee
Steve Smith
Reporter
Mara Sierra AlvarezProject
HE551506 - A303Created
26/Feb/21Deadline
26/Feb/21Clash test
HML vs HSN

Date and Time

26/Feb/21

12:22 GMT

Commented by Mara Sierra Alvarez

Please, review clash and comment

Date and Time

26/Feb/21

2:44 GMT

Commented by Mara Sierra Alvarez

Please, Steve review and comment clash

Date and Time

26/Feb/21

2:45 GMT

Commented by Steve Smith

This isn't a real clash as it's the signs post and foundations in the ground

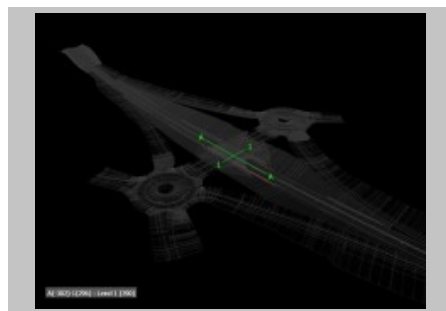
ID [493](#)

Minor

Solved

Title

HRR vs HMK: Clash2

Assignee

Niteen Pawar

Reporter

Mara Sierra Alvarez

Created

26/Feb/21

Deadline

26/Feb/21

Project

HE551506 - A303

Clash test

HRR vs HMK

Date and Time

26/Feb/21

10:11 GMT

Commented by Mara Sierra Alvarez

Please, review clashes assigned to you

Date and Time

26/Feb/21

10:17 GMT

Commented by Niteen Pawar

The barrier will be placed at design setback from the edge of carriageway. This is not a real clash.

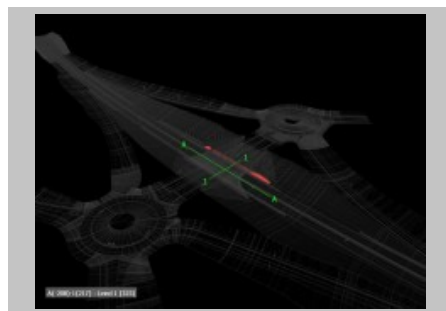
ID [497](#)

Minor

Solved

Title

SBR vs HMK: Clash3

Assignee

Jose Alejandro Civera Abad

Reporter

Mara Sierra Alvarez

Created

26/Feb/21

Deadline

26/Feb/21

Project

HE551506 - A303

Clash test

SBR vs HMK

Date and Time

26/Feb/21

9:34 GMT

Commented by Jose Alejandro Civera Abad

This is not a real clash, it seems that the HMK element is an axis line from A360 road, but not an issue as per my understanding.