

BASEMENT LAYOUT
SCALE: 1:50

EXISTING PUMPED DRAINAGE ROUTE TO EXTERNAL GULLEY RE-USED WITH NEW PIPEWORK

SUMP PUMP CONTROL PANEL LINKED TO BMS FOR FAULT MONITORING

NEW DUAL HEAD SUMP PUMP REQUIRED FOR BASEMENT FLOODING - PLEASE REFER TO SPECIFICATION FOR DETAILS - EXACT SPECIFICATION TO BE CONFIRMED BY SPECIALIST

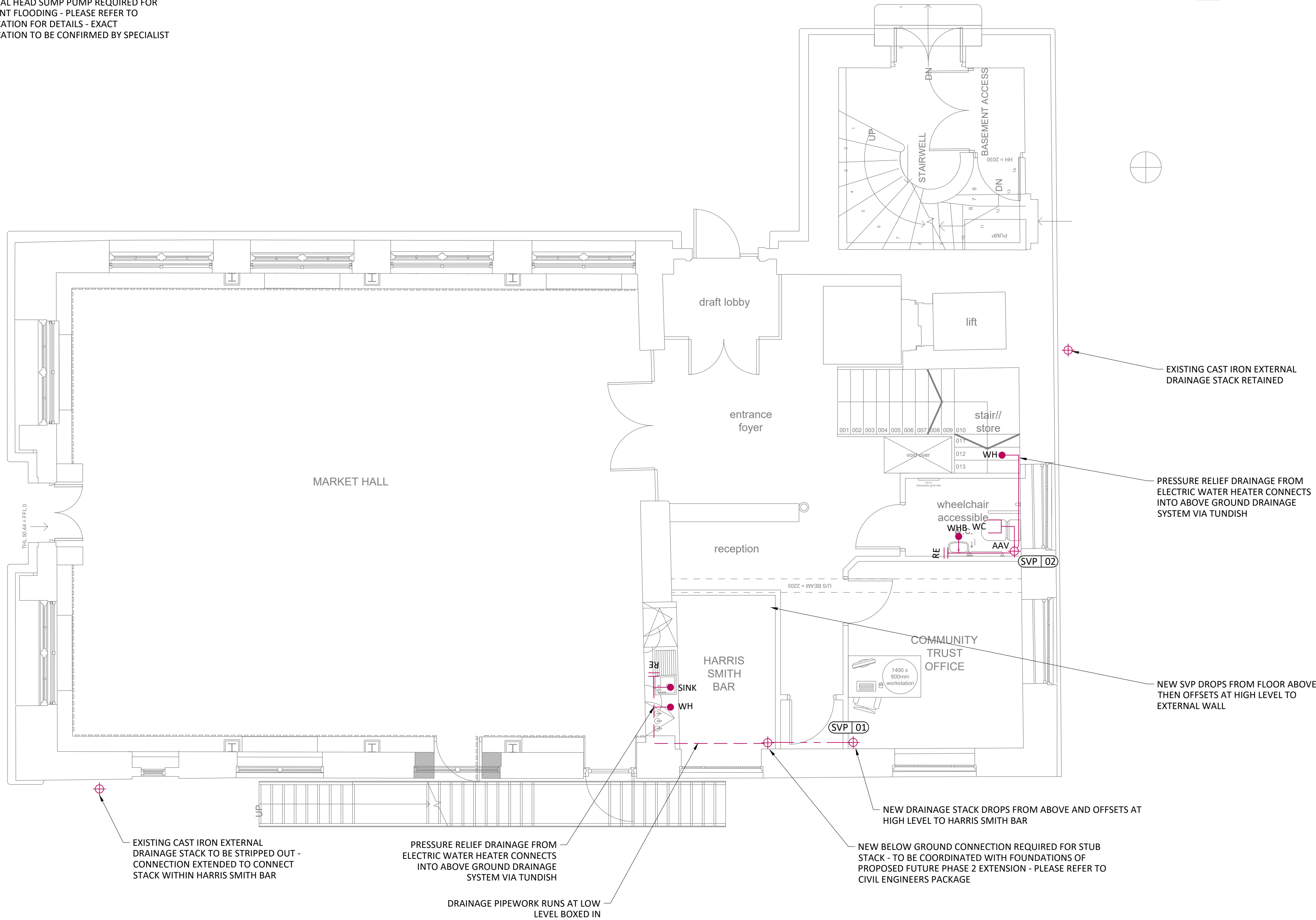

- Legend:**
- DRAINAGE
 - LOW LEVEL CONCEALED PIPEWORK
 - HIGH LEVEL CONCEALED PIPEWORK
 - AAV AIR ADMITTANCE VALVE
 - DRAINAGE CONNECTION
 - DRAINAGE STACK
 - RODDING EYE
 - WC DRAINAGE CONNECTION
 - SVP REFERENCE
 - STUB STACK REFERENCE

- Notes:**
- THIS DRAWING SHALL BE READ IN CONJUNCTION WITH ALL OTHER DRAWINGS, SPECIFICATIONS, SCHEDULES AND BUILDING MODELS INCLUDING SCHEMATICS. THE CONTRACTOR SHALL REFER TO THE ARCHITECTS DRAWINGS FOR SETTING OUT DETAILS/DIMENSIONS.
 - THE MECHANICAL SERVICES INSTALLATIONS ARE DESIGNED TO COMPLY FULLY WITH THE BUILDING REGULATIONS STANDARDS, AND ARE DESIGNED IN ACCORDANCE WITH THE RECOMMENDATIONS OF THE CIBSE GUIDES, AS ISSUED BY THE CHARTERED INSTITUTION OF BUILDING SERVICES ENGINEERS.
 - REFER TO THE ARCHITECTS DRAWINGS FOR DETAILS OF ALL BUILDING FIRE COMPARTMENTATION BARRIERS. ANY SERVICES PENETRATING THE FIRE COMPARTMENT SHALL BE FIRE SEALED USING THE APPROVED PENETRATION DETAIL.
 - ALL PENETRATIONS THROUGH FIRE WALLS SHALL BE FIRE STOPPED TO MAINTAIN THE FIRE INTEGRITY OF THE FIRE WALL. ALL SLAB PENETRATIONS TO HAVE FIRE STOPPING TO MAINTAIN THE INTEGRITY OF THE FIRE RATED SLAB. THE CONTRACTOR SHALL MAKE GOOD ALL PENETRATIONS TO THE APPROVAL OF BUILDING CONTROL.
 - THIS DRAWING SHALL NOT BE USED FOR INSTALLATION. THE MECHANICAL SERVICES CONTRACTOR SHALL BE RESPONSIBLE FOR PRODUCTION OF COORDINATED INSTALLATION DRAWINGS CHECKED WITH ACTUAL SITE DIMENSIONS.
 - ALL DIMENSIONS WHERE INDICATED ARE IN MILLIMETRES UNLESS STATED OTHERWISE. ALL DIMENSIONS SHALL BE CHECKED ON SITE PRIOR TO COMMENCEMENT OF ANY WORKS.
 - ALL PIPES TO BE WITHIN VOIDS UNLESS OTHERWISE STATED.
 - THE ABOVE GROUND SOIL VENT PIPEWORK SHALL COMPLY IN ALL RESPECTS WITH BS EN 12056:2000.
 - ALL SOIL VENT PIPES SHALL BEFITTED WITH SLOW RADIUS BENDS AT THE BASE OF EACH STACK.
 - THE ENTIRE ABOVE GROUND DRAINAGE SYSTEM SHALL BE INSPECTED AND TESTED TO THE SATISFACTION OF THE LOCAL AUTHORITY BUILDING CONTROL INSPECTOR.
 - ANTI-SYPHON TRAPS SHALL BE FITTED ON ALL APPLIANCES.
 - ALL PIPEWORK SHALL BE HDPE PIPEWORK THROUGHOUT THE INSTALLATION. ELECTROFUSION WELDED JOINTS UP TO INDIVIDUAL TRAPS. INCLUDE FOR ALL NECESSARY EXPANSION AND RODDING ACCESS FITTINGS BETWEEN FLOOR.
 - THE CONTRACTOR SHALL PROVIDE BRACKETS SUPPORTING HDPE STACKS OF THE ACOUSTIC TYPE INSTALLED IN COMPLIANCE WITH THE MANUFACTURERS INSTRUCTIONS.
 - THE CONTRACTOR SHALL ALLOW FOR ALL NECESSARY ADAPTERS, CONNECTORS AND PIPEWORK TO ENABLE A FULLY OPERATIONAL SYSTEM.
 - RODDING EYES FOR ALL SVPS AND S/S SHALL BE LOCATED NEAR SLAB LEVEL ON ALL FLOORS.
 - DRAINAGE FOR CONDENSATE AND HIGH PRESSURE DISCHARGE TO BE COPPER.
 - ALL VERTICAL AND HORIZONTAL SVPS AND S/Ss TO BE WAVIN AND INSTALLED COMPLETE WITH ACOUSTIC INSULATION.

Rev	Date	By	Chk	Aprvd	Description
-----	------	----	-----	-------	-------------

PROJECT
Midsomer Norton Town Hall

CLIENT

**Bath & North East
Somerset Council**

**Method
Consulting**

www.methodllp.com Bristol Tel: 0117 203 5160

DRAWING TITLE
**Above Ground Drainage Services
Ground Floor**

STATUS

S2 - FOR TENDER

DATE	SCALE	DRWN BY	CHK BY	APVD BY
21.10.21	1:50 - A1	ARG	DMS	DMS

DRAWING NUMBER	REVISION No.
1716PMN-MET-P1-00-DR-M-5201	S2 - T01

Scaling Note: Do NOT scale from this drawing.

SAFETY, HEALTH & ENVIRONMENTAL INFORMATION

FOR DETAILS OF SITE-WIDE AND GENERAL RISKS, TO BE READ IN CONJUNCTION WITH THESE NOTES. SEE THE CONTRACT DOCUMENTS AND, WHERE WORKS ARE NOTIFIABLE, THE PRE-CONSTRUCTION INFORMATION

IN ADDITION TO THE RISKS NORMALLY ASSOCIATED WITH THE TYPES OF WORK DETAILED ON THIS DRAWING, NOTE THE FOLLOWING RISKS AND INFORMATION:

CONSTRUCTION:
C1.Asbestos - Refer to DHRA for details
C2.Working at height to install services - Refer to DHRA for details
C3

DISMANTLING/DEMOLITION (FUTURE):

D1.
D2.
D3.

IT IS ASSUMED THAT ALL WORKS WILL BE CARRIED OUT BY A COMPETENT CONTRACTOR WORKING, WHERE APPROPRIATE, TO AN APPROVED METHOD STATEMENT

THIS DRAWING IS NOT TO BE USED FOR CONSTRUCTION. INSTALLATION DRAWINGS SHOULD BE PRODUCED BY THE CONTRACTOR AND AGREED WITH THE CLIENT TEAM PRIOR TO ANY INSTALLATION WORK

THIS DRAWING SHALL BE
PRINTED IN COLOUR