

Single hatch shows location of new floor expansion joint
Double hatch shows location of new perimeter retaining wall

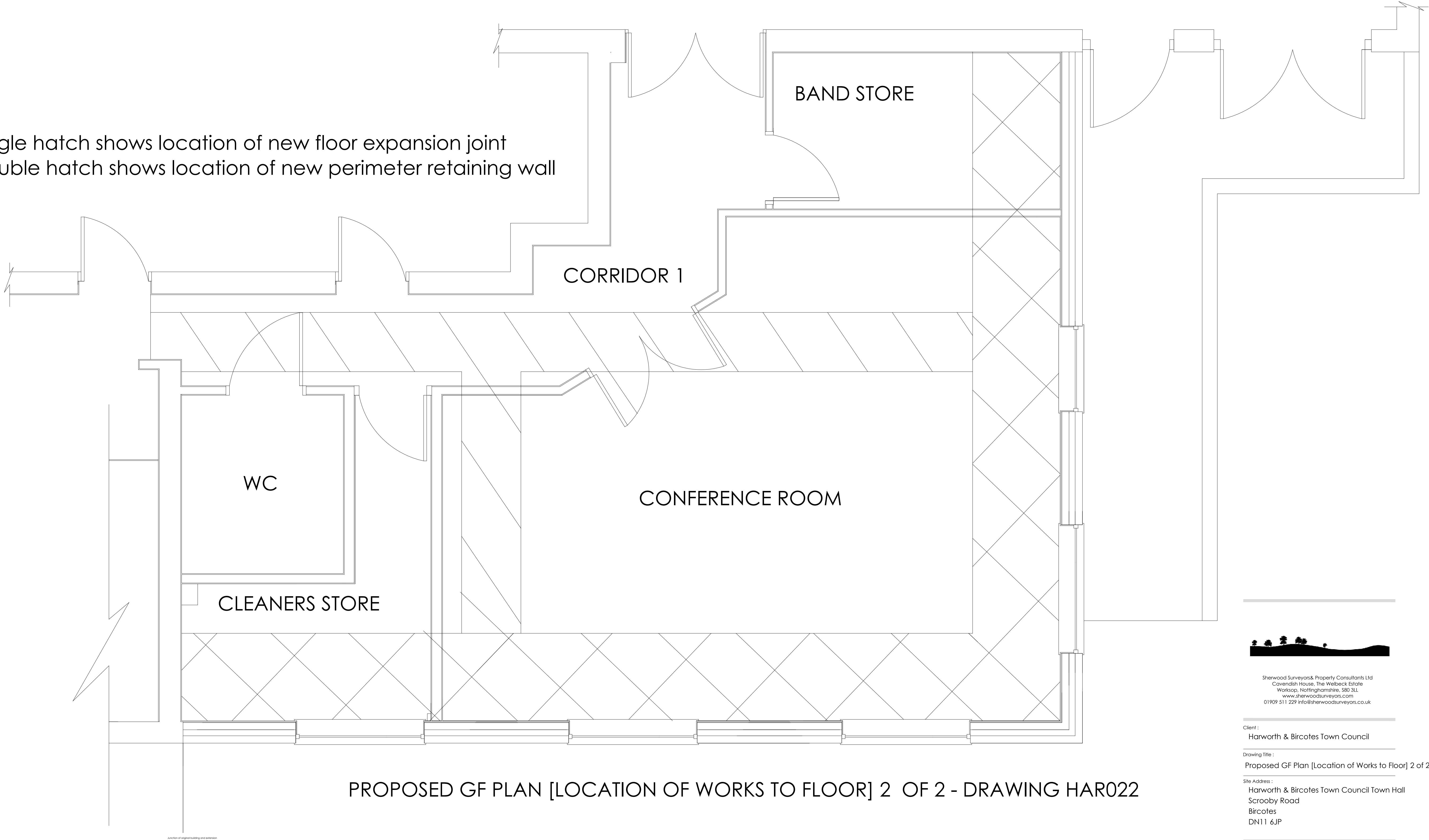

Sherwood Surveyors & Property Consultants Ltd
Cavendish House, The Welbeck Estate
Worksop, Nottinghamshire, S80 3LL
www.sherwoodsurveyors.com
01909 511 229 info@sherwoodsurveyors.co.uk

Client :
Harworth & Bircotes Town Council

Drawing Title :
Proposed GF Plan [Location of Works to Floor] 2 of 2

Site Address :
Harworth & Bircotes Town Council Town Hall
Scrooby Road
Bircotes
DN11 6JP

Drg No. HAR022	Rev : N/A
Dwn By : AMW	Date : 01/03/18

This drawing remains the property of Sherwood Surveyors & Property Consultants Ltd.
Duplication of this drawing in whole or any part is strictly forbidden without prior written
permission from Sherwood Surveyors & Property Consultants Ltd.
Any structural details are to be approved by a structural engineer. This drawing should not be
issued. It is the contractor's responsibility to check all dimensions on site.