

1. This drawing remains copyright of Challinor Hall Ltd and may not be reproduced or copied without consent in writing.
2. Do not scale drawing use figured dimensions only.
3. Any discrepancies between site and drawings to be reported to Challinor Hall Ltd
4. Read in conjunction with all relevant structural and mechanical & electrical engineers drawings.
5. Dimensions critical to proposed building works must be checked on site before building works commences.

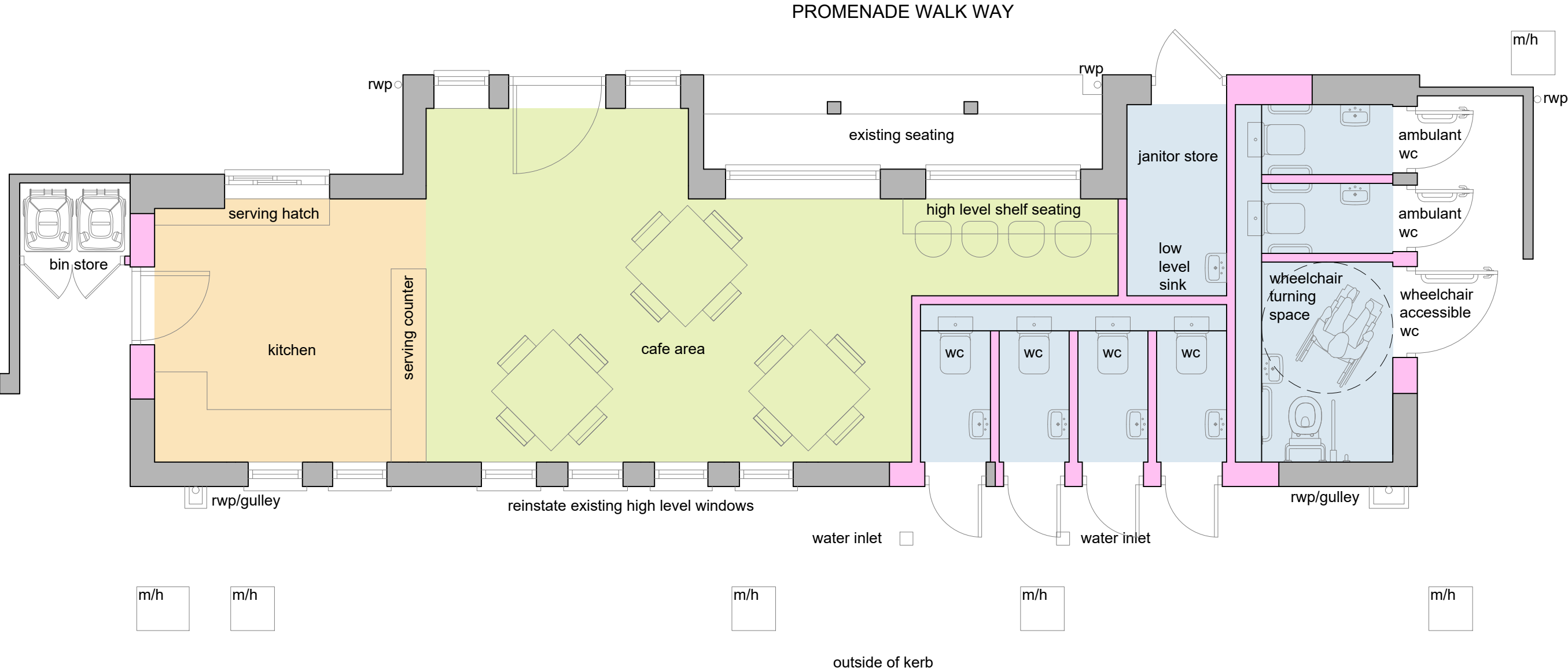

PROPOSED FLOOR PLAN

revision	date	amendment
Client		
Seaford Town Council		
Project		
Martello public conveniences refurbishment		
Project Address		
Public Conveniences, Esplanade, Seaford, East Sussex, BN25 1JH		
Drawing Title		
Proposed floor plan		
Stage		
PLANNING		
Issue Date		Project No.
13.02.2023		2252
Scale	Drawing No.	Rev.
1:50 on A3 paper	04	



19 Willingdon Park Drive - Eastbourne - BN22 0BS
(T): 01323 411933 (W): www.challinorhall.co.uk
(E): lee@challinorhall.co.uk

