

2

Brief Development

2.3

Precedent Analysis

2.3.5

Bob Champion Building, University of East Anglia

Construction Cost: £19.7m
Type: New Build
Sector: HE Teaching and Research Laboratory
Total Occupancy: 638

Project Overview
The aim of the design is to unite the clinical, academic and research requirements for teaching medical students under one roof. The building's research facilities are targeted at improving patient care whilst the clinical teaching areas are focussed on providing authentic healthcare learning environments for the University's Medical School.

Laboratories, clinical spaces, seminar rooms, a large lecture theatre and offices are all housed



Average areas

Primary Laboratory: 6.7m² pp
Shared Office: 4.8m² pp
Cellular Office: 11m² pp

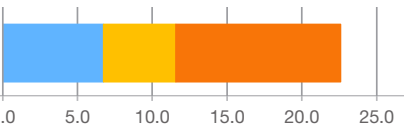

- Primary Laboratories
- Shared Secondary Laboratories
- Direct Secondary Laboratories
- Tertiary Space
- Cellular Office
- Shared Office
- Meeting Space
- Collaboration Space
- Social Space
- Specialist Teaching Space
- General Teaching Space
- Other - Specialist
- Circulation
- Balance
- Plant (inclu. roof plant)
- Engineering

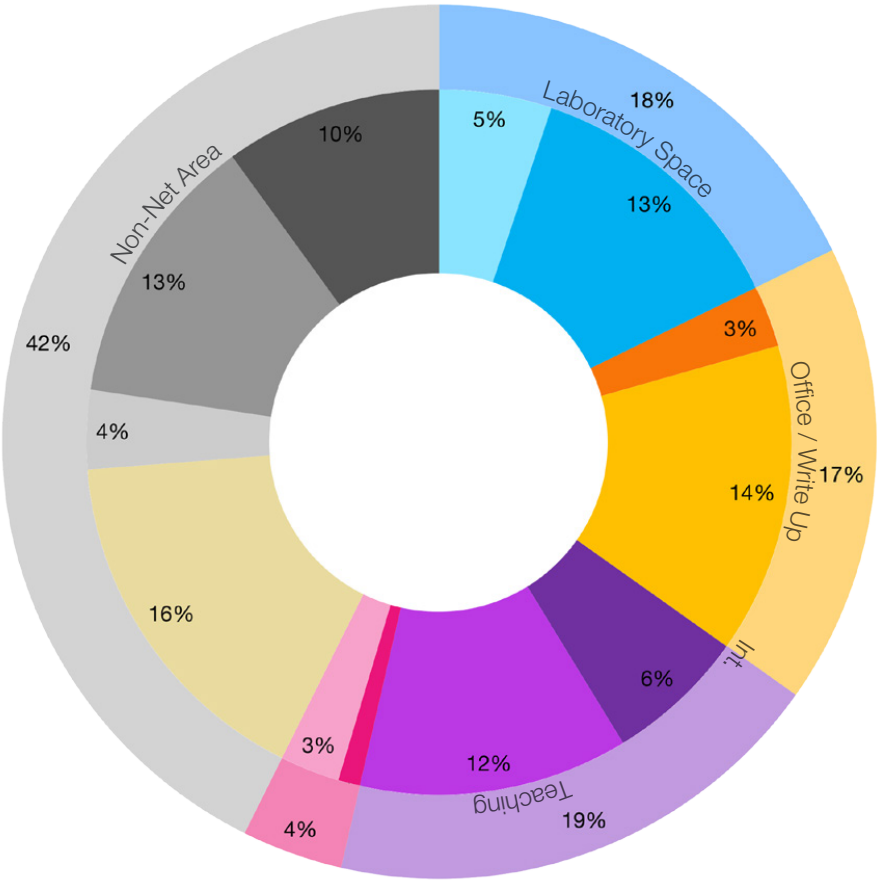

The Bob Champion Building - Clear aspects to and from the central atrium helps way-finding and give the building a unique character

2

Brief Development

2.4

Precedent Analysis - Existing Facilities

2.4.1

CRB Building

The Design Team has analysed the facilities that the LMS currently occupy in the CRB and ICTEM buildings; the spaces in the Neptune Steines and Francis Fraser Labs are relatively small and have not been included. However, the in-vivo and in-vitro facilities from the Mansfield Building and Francis Fraser will be relocated into the new LMS building.

The analysis of LMS existing accommodation shows lab-to-office and secondary-to-primary space ratios for:

- ICTEM Building (Imperial College), second floor which is currently occupied by the LMS.
- CRB Building: third, fourth and fifth floors, half of the second floor and the cafe and seminar rooms.

The remaining spaces within these buildings that were not included in the analysis include ‘H1’ and others spaces not belonging to the LMS.



Fifth Floor



Sixth Floor

- Primary Laboratories
- Shared Secondary Laboratories
- Direct Secondary Laboratories
- Tertiary Space
- Cellular Office
- Shared Office
- Meeting Space
- Collaboration Space
- Social Space
- Specialist Teaching Space
- General Teaching Space
- Other - Specialist
- Circulation
- Balance
- Plant (inclu. roof plant)
- Engineering



Second Floor



Third Floor

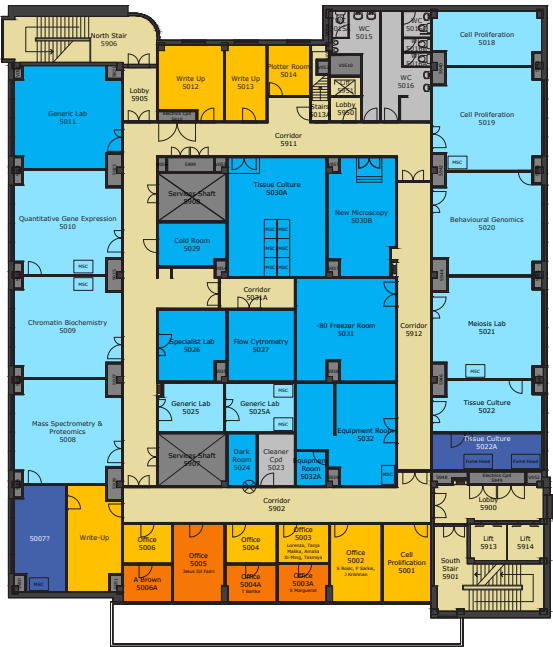

Fourth Floor