



CHAIRMAN: MR K. FINCHER
12 Vimiera Close, Norton, Worcs WR5 2QP

CLERK: MRS J. GREENWAY
18 Corunna Close, Norton, Worcs WR5 2PW

Tel: 01905 763515
E-mail: NJKparishclerk@aol.com

Norton Parish Hall Car Park Re-surfacing Proposal Specification October 2018

Site address: Norton Parish Hall, Wadborough Road, Littleworth, Worcs WR5 2QB

Work required: -

Car Park Area 1 (see plan below)

Remove the top layer of existing stone

Install edging as plan with 150 mm high x 50mm thick bull-nosed kerbs, fixed and haunched in concrete (approx. 17.5 m long)

Level with top soil and then grass seed the area beyond the edging

Cover whole area with 50mm deep Forest of Dean 20mm gravel (reddish in colour)

Car Park Area 2 (see plan below)

Scrape out and consolidate for new road to a width of 6 metres x 125mm deep as shown on the plan. Shuttering with steel road forms. Pour in road-form quality concrete, vibrate and level.

Provide expansion joints with dowel bars every 10 metres to help prevent cracking.

Install edging in area 2, alongside the ditch, as plan with 150mm high x 50mm thick bull-nosed kerbs, fixed and haunched in concrete (approx. 65 m long) Level ditch area with top soil up to the new kerbs and seed.

Lift and reset manhole covers to required levels

Create small area of grey pressed concrete slabs 1800mm x 1800mm at bottom of ramp to pre-school to assist wheelchair access.

Create small area of grey pressed slabs 1200mm x 3600mm in front of pre-school container to ease access

Scrape to correct levels and cover all areas around the road etc as per plan with 20mm Forest of Dean gravel

Retain the 3 existing ramps to the Hall building

Bin Store Area

Remove existing concrete base adjacent to the LPG tank, container posts, tree & surround and old tree stump

Fix 900mm wide gate on existing path

Create ramp from side door up to new bin storage area.

Consolidate in stone hardcore where required and create new slabbed bin storage area with 600mm x 600mm grey pressed concrete slab. The slabbed area to be around LPG tank, level with Hall building and extending as far as the telegraph pole.

Provide and install a fence of 125mm wide feather edged boards on 100 mm x 100mm timber supports (set in concrete), 150mm timber gravel boards and timber cross rails (x3) around the bin storage area.

Fix pair of gates x 900mm each to provide access to front, gates to have galvanised furniture.

All waste to be cleared away in a proper manner, with the site left in a clean and tidy condition ready for use; and for all relevant Health & Safety legislation and guidance to be followed.

Forest of Dean Gravel:



Steel Shuttering for road build:



Bull-nosed concrete edging 150mm x 50mm:



Extra to be considered

Install “knee rail” barrier along the edge of the existing concrete roadway to “force” people to use the new roadway to enter car park area 2



CAR PARK AREA 1 (ALL SIZES APPROX)

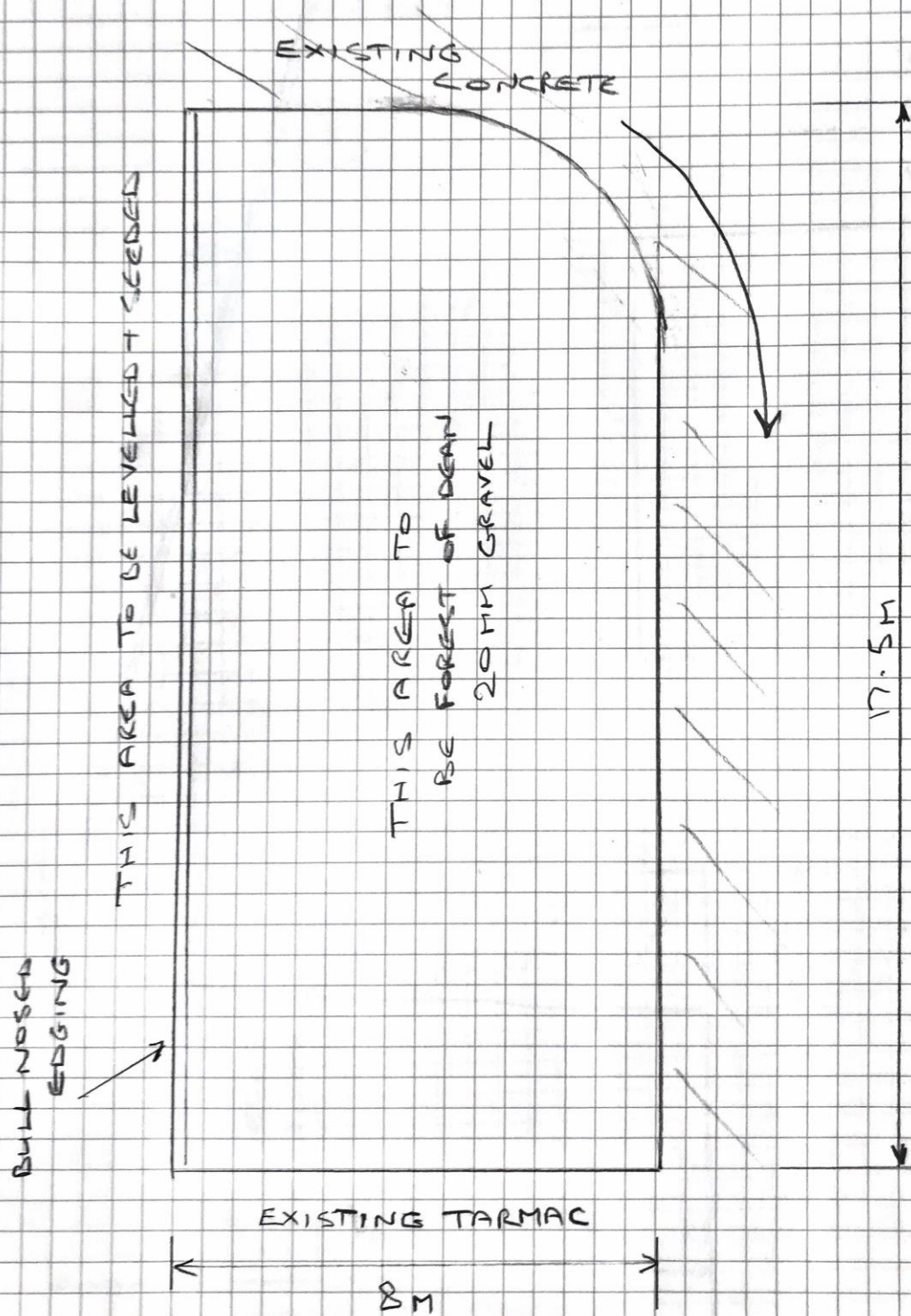

CAR PARK AREA 2

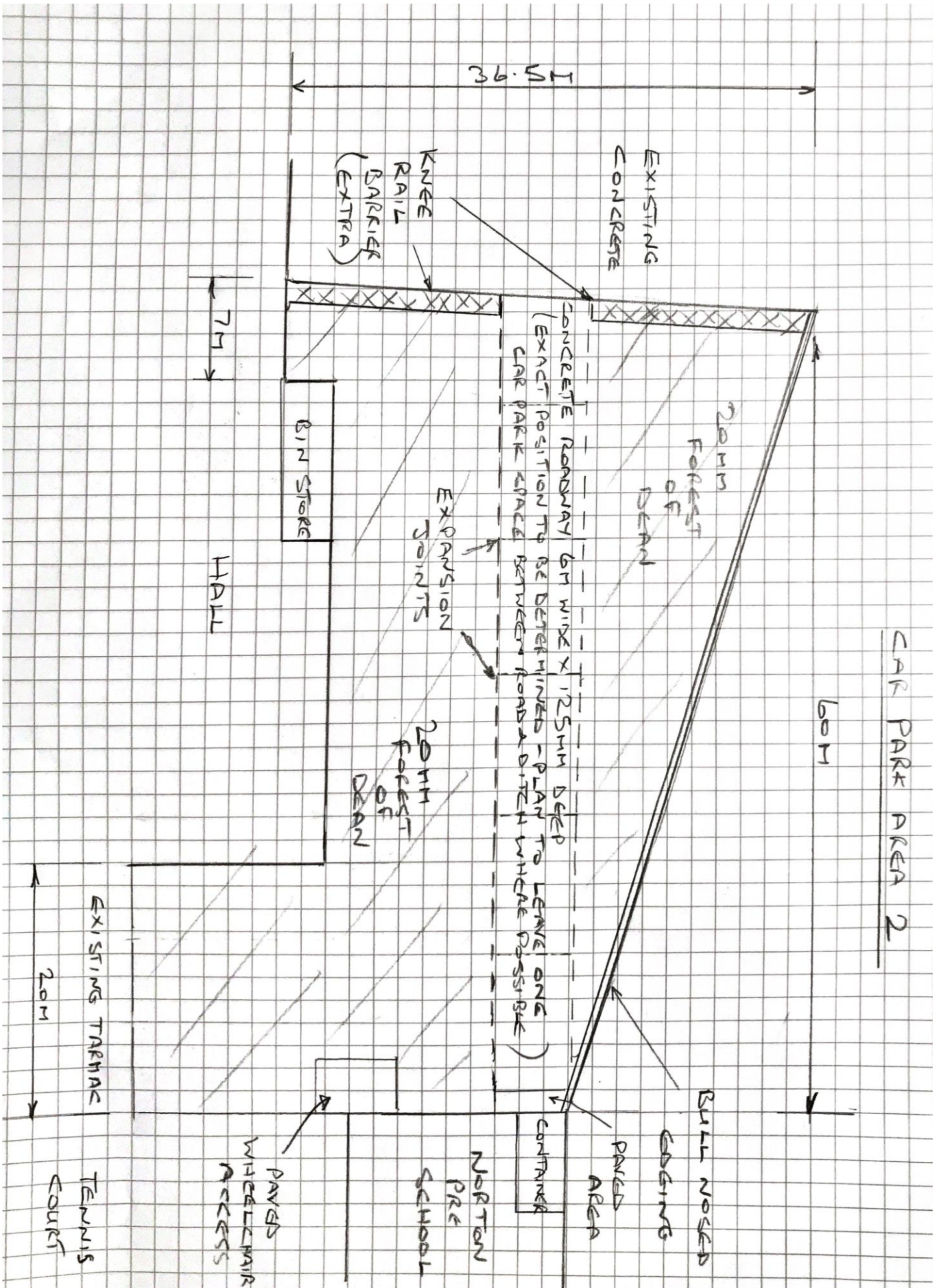

Norton Parish Hall

