

Community Roots, Porthtowan

Detail - Entrance Door - Head and Cill

1:5 @ A3 / 1:2.5 @ A1

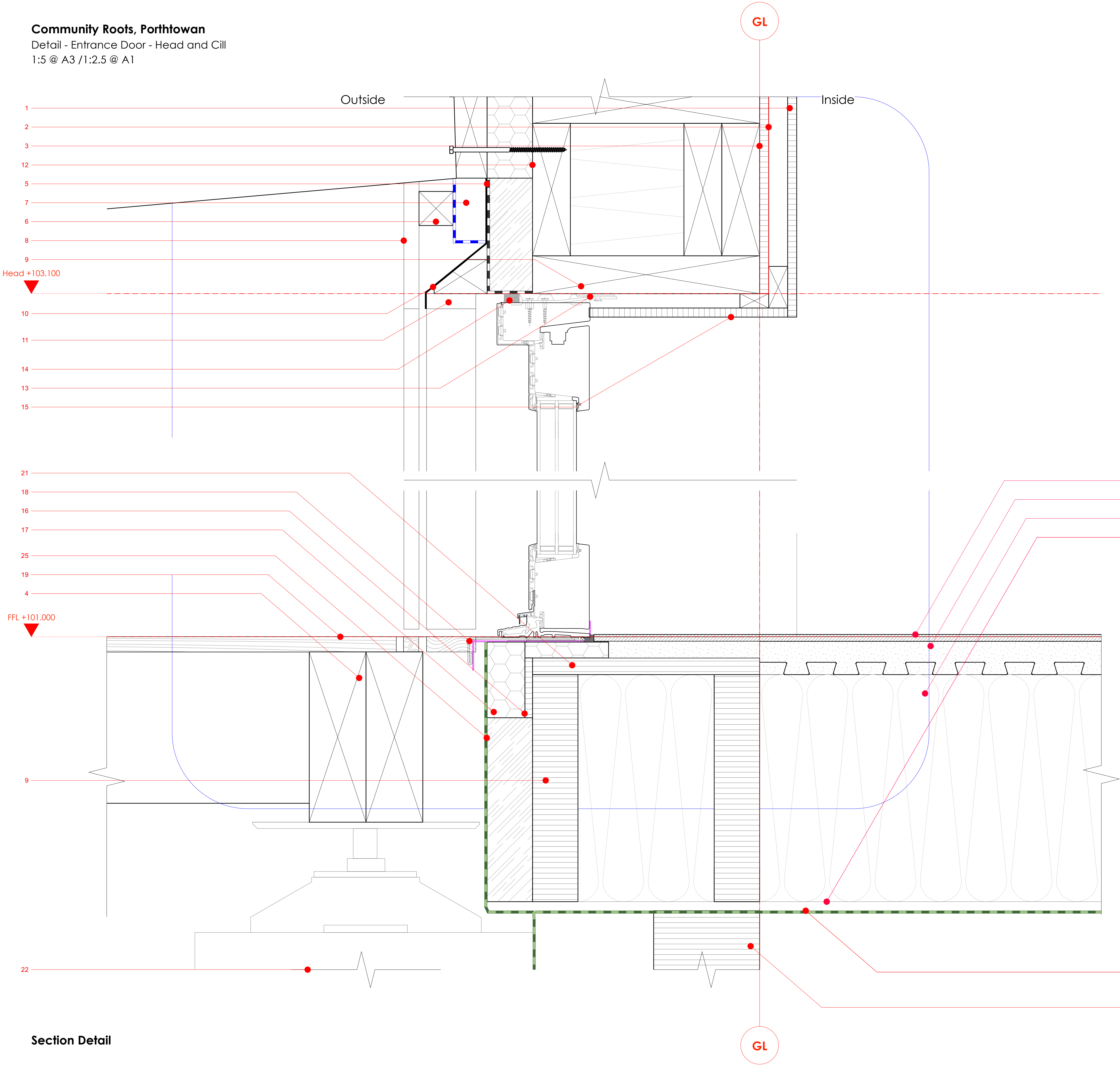

Rev	Date	By	Description
A	26/04/2024	JF	Updated for tender issue

- Notes**
- Timber Frame - OSB 3 - 12mm - fired treated
  - Timber Frame - M+E Service Void 25mm
  - Timber Frame - Sheathing - Medite Smartply Airtight - 12.5mm
  - Timber Frame - Joist - 150 x 50mm C16
  - Insulation - Wood Fibre - Pavatex Isolair T&G Board - 60mm
  - Batten - Treated - 45mm x 45mm - Painted Black - S/S Fixing @ 400 Centres
  - Batten - Treated - Counter - 45mm x 45mm - Painted Black - S/S Fixing @ 400 Centres
  - Cladding - Timber - 20x65mm with 10mm gaps between boards - Larch - Vertical
  - Timber Frame - LVL - STEICOWall - 300x45mm
  - Opening - Aluminium Drip profile - Colour Ral to match Windows - Mechanically fixed
  - Opening - Reveal - 20 x 100mm larch timber reveal
  - Insulation - Warmcel - blown in cellulose
  - Sealing - Joint sealing tape - Tremco-Ilbruck Compriband TP600
  - Sealing - Flexible VCL tape - Tremco Ilbruck ME500 taped to window frame
  - Opening - Window board - 18mm -OSB - Fire treated
  - Timber Frame - Plywood - Marine Grade - 12.5mm
  - Masonry - COMPACFOAM 200 thermal break for door threshold - 100 x 50mm
  - Opening - Cill - Aluminium to match window / door.
  - Floor - Decking - External decking to balcony.
  - Timber Frame - Glulam timber frame. Refer to Engineers spec
  - Timber Frame - Deck - Plywood - 18mm
  - Foundation - Jakpad® Support System
  - Floor - Finish - Coir entrance matting - 20mm
  - Floor - Screed - 50mm - Liquid Proprietary self smoothing levelling screed with incorporated underfloor heating system - above LEWIS Metal Deck.
  - Cladding - Fibre Cement Exterior Grade Construction Backer Board / Panelvent / Marine Plywood - 12mm
  - Membrane - Rodent Mesh

- MEMBRANES KEY:**
- All membranes are to be fully taped and lapped with proprietary tape as per the Architectural Specification and manufacturers standards and guidance.
- |  |  |
|--|--|
|  | DPC - Visqueen Zedex CPT High Performance  |
|  | DPM - Visqueen RadonBlok 400               |
|  | VisqueenPro Single Sided Jointing Tape     |
|  | VisqueenPro Double Sided Jointing Tape     |
|  | Insect Mesh                                |
|  | Breather Membrane - Ampack Amatop RF Black |
|  | Breather Membrane - Ampack Amatop Aero     |
|  | Tescon Vanna Single Sided Tape             |
|  | DPC Tray - Pro Clima Extoseal              |
|  | Geotextile                                 |
|  | EPDM                                       |
|  | Vapour Control Layer - Ampatex DB90        |
|  | Rodent Mesh - Specification TBD            |

# KASTARCHITECTS

Project  
**Community Roots, Porthtowan**  
TR4 8FN

Client  
**Community Roots CIC**

Date  
**04/01/2024**

Drawn  
**APC**

Scale @ A1  
**1:2.5**

Drawing Number  
**2311 4 2503**

Checked  
**AMC**

Scale @ A3  
**1:5**

Amendment  
**A**

Status  
**Technical**

RIBA Work Stage  
**4**

Community Roots, Porthtowan

Detail - Entrance Door - Head and Cill

Scale @ A1 1:2.5

Scale @ A3 1:5

RIBA Work Stage 4

www.kastarchitects.com  
hello@kastarchitects.com  
68 Lemon Street, Truro, Cornwall, TR1 2PW  
copyright Kast Architects Limited - all rights reserved

Section Detail